

CKA - MKA W-TYPE for aggressive environments

inserts

CK	3 poles + ⊕	58
CK	4 poles + ⊕	58
CKS	3 poles + ⊕	-
CKS	4 poles + ⊕	-
CKSH	3 poles + ⊕	63
CKSH	4 poles + ⊕	63
CD	8 poles	67
CQ4	2 poles + ⊕	182
CQ4 H	2 poles + ⊕	183
CQ4	3 poles + ⊕	184
CQ	5 poles + ⊕	186
CQ	7 poles + ⊕	187
CQ	12 poles + ⊕	189
CQ	21 poles	190

page:

bulkhead mounting housings
straight and angled

hoods



description	part No. (entry Pg 11)	part No. (entry M20)	part No. (entry Pg 11)	part No. (entry M20 / M25)
with stainless steel lever and gasket	CKAXW 03 I			
without cable entry, with stainless steel lever and gasket	CKAXW 03 IA			
with cable entry, with stainless steel lever and gasket	CKAXW 03 IAP	MKAXW IAP20		
with cable entry, with stainless steel lever and gasket, bulkhead hole closed	CKAXW 03 AP	MKAXW AP20		
with pegs, top entry			CKAW 03 V	MKA W V20
with pegs, top entry			CKAW 03 VA	MKA W V25
with pegs, side entry			CKAXW 03 VG	MKA W VG20
with stainless steel lever, top entry				
gasket and screw kit for IP66/IP67/IP69 1)	CKR 65		CKR 65	
for CK, CKSH, CQ4, CQ inserts				
gasket and screw kit for IP66/IP67/IP69 1)	CKR 65 D		CKR 65 D	
for CD 08 inserts				

1) To obtain the IP66/IP67/IP69 degree of protection, a kit with insert fixing screw and gasket can be purchased separately.
Several inserts size "21.21" are already supplied with fixing screw and gasket, which ensures IP66/IP67/IP69 degree of protection. See list below, not including any special version:
- CQF/M 07, CQF/M 12

NOTE: Housing type may vary upon specific part No.

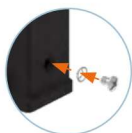

versions with glued gasket (DESINA®) upon request

panel cut-out for bulkhead mounting housings

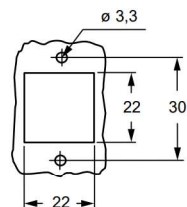

CAUS

Type 12
Type 4/4X only
with CKR 65 (D)



IP66/IP67/IP69 with CKR 65 (D) 1)

CKAXW I

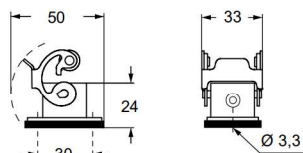

CKAXW IA

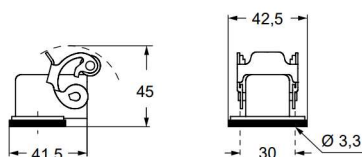
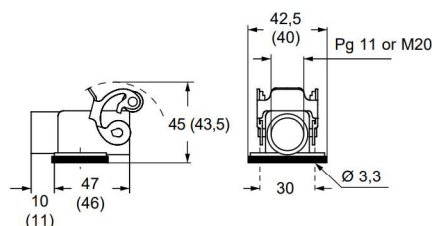
CKAXW IAP (CKAXW AP) and
MKAXW IAP (MKAXW AP)

CKAW V and MKA W V20 - V25

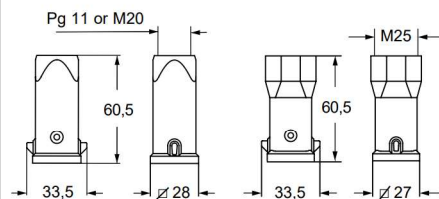

CKAW VA and MKA W VA

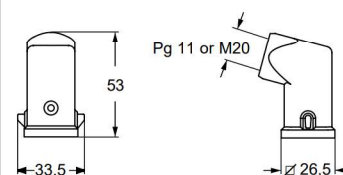

CKAXW VG and MKA W VG

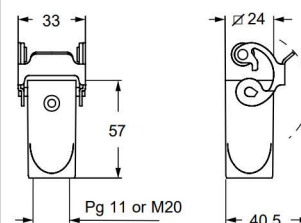



CKAX - CKAXX W-TYPE for aggressive environments

inserts		page:
CK	3 poles + ⊕	58
CK	4 poles + ⊕	58
CKS	3 poles + ⊕	-
CKS	4 poles + ⊕	-
CKSH	3 poles + ⊕	63
CKSH	4 poles + ⊕	63
CD	8 poles	67
CQ4	2 poles + ⊕	182
CQ4 H	2 poles + ⊕	183
CQ4	3 poles + ⊕	184
CQ	5 poles + ⊕	186
CQ	7 poles + ⊕	187
CQ	12 poles + ⊕	189
CQ	21 poles	190

angled bulkhead mounting housings
stainless steel lever



angled bulkhead mounting housings
stainless steel rigid lever



description	part No.	part No.
without cable entry, fixing by 4 screws	CKAXW 03 1A4	CKAXXW 031A4
gasket and screw kit for IP66/IP67/IP69 1)	CKR 65	CKR 65
for CK, CKSH, CQ4, CQ inserts		
gasket and screw kit for IP66/IP67/IP69 1)	CKR 65 D	CKR 65 D
for CD 08 inserts		

1) To obtain the IP66/IP67/IP69 degree of protection, a kit with insert fixing screw and gasket can be purchased separately.
Several inserts size “21.21” are already supplied with fixing screw and gasket, which ensures IP66/IP67/IP69 degree of protection. See list below, not including any special version:
- CQF/M 07, CQF/M 12

NOTE: Housing type may vary upon specific part No.

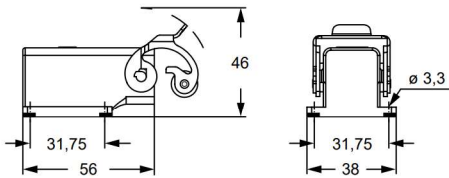
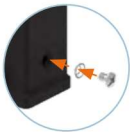

panel cut-out for enclosures

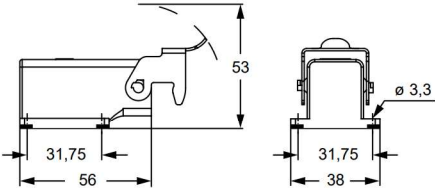
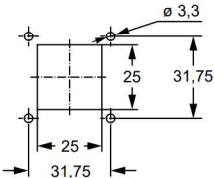

panel cut-out for enclosures

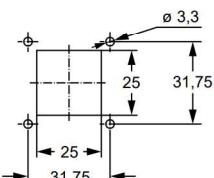

IP66/IP67/IP69 with CKR 65 (D) 1)

MKAX W-TYPE for aggressive environments

inserts	page:
CK 3 and 4 poles + ⊕	58
CKS 3 and 4 poles + ⊕	-
CKSH 3 and 4 poles + ⊕	63
CD 8 poles	67
CQ4 2 poles + ⊕	182
CQ4 H 2 poles + ⊕	183
CQ4 3 poles + ⊕	184
CQ 5 poles + ⊕	186
CQ 7 poles + ⊕	187
CQ 12 poles + ⊕	189
CQ 21 poles	190
if the counterpart has glued gasket:	
CLK 04 SC	239
CX 1/2 BD	243
CXL 2/4 PF/PM	251
CXL 2/4 PFH/PMH	251
CXL PF/PM	251

**angled surface mounting housings
stainless steel lever****angled surface mounting housings
stainless steel lever****description**part No.
(entry M25)part No.
(entry M25)

with cable entry, fixing by 4 screws

MKAXW IAP25with cable entry, fixing by 4 screws,
bulkhead hole closed (without gasket)**MKAXW AP25**gasket and screw kit for IP66/IP67/IP69 1)
for CK, CKSH, CQ4, CQ, inserts**CKR 65****CKR 65**gasket and screw kit for IP66/IP67/IP69 1)
for CD 08 inserts**CKR 65 D****CKR 65 D**

1) To obtain the IP66/IP67/IP69 degree of protection, a kit with insert fixing screw and gasket can be purchased separately. Several inserts size "21.21" are already supplied with fixing screw and gasket, which ensures IP66/IP67/IP69 degree of protection. See list below, not including any special version:

- CQF/M 07, CQF/M 12
- CUK 2FT /3FT
- CX 1/2 BDF/M
- CLK 04 SCF /SCF-H /SCM
- CXL 2/4 PF /PM /PFH /PMH, CXL PF/PM

 **NOTE:** Housing type may vary upon specific part No.

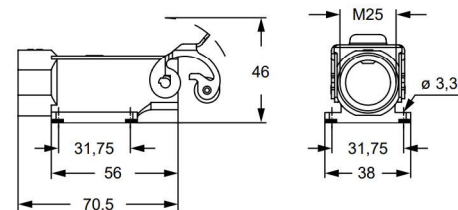

panel cut-out for enclosures

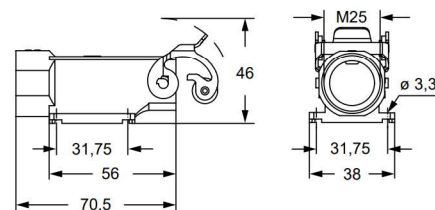
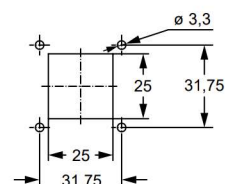

panel cut-out for enclosures

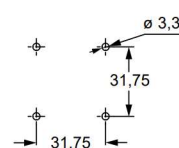

IP66/IP67/IP69 with CKR 65 (D) 1)



MKAXX W-TYPE for aggressive environments

inserts	page:
CK 3 and 4 poles + ⊕	58
CKS 3 and 4 poles + ⊕	-
CKSH 3 and 4 poles + ⊕	63
CD 8 poles	67
CQ4 2 poles + ⊕	182
CQ4 H 2 poles + ⊕	183
CQ4 3 poles + ⊕	184
CQ 5 poles + ⊕	186
CQ 7 poles + ⊕	187
CQ 12 poles + ⊕	189
CQ 21 poles	190
if the counterpart has glued gasket:	
CLK 04 SC	239
CX 1/2 BD	243
CXL 2/4 PF/PM	251
CXL 2/4 PFH/PMH	251
CXL PF/PM	251

angled surface mounting housings
stainless steel rigid lever



angled surface mounting housings
stainless steel rigid lever



description	part No. (entry M25)	part No. (entry M25)
with cable entry, fixing by 4 screws	MKAXXW IAP25	
with cable entry, fixing by 4 screws, bulkhead hole closed (without gasket)		MKAXXW AP25
gasket and screw kit for IP66/IP67 ¹⁾ for CK, CKSH, CQ4, CQ, inserts	CKR 65	CKR 65
gasket and screw kit for IP66/IP67 ¹⁾ for CD 08 inserts	CKR 65 D	CKR 65 D

¹⁾ To obtain the IP66/IP67/IP69 degree of protection, a kit with insert fixing screw and gasket can be purchased separately.
Several inserts size “21.21” are already supplied with fixing screw and gasket, which ensures IP66/IP67/IP69 degree of protection. See list below, not including any special version:

- CQF/M 07, CQF/M 12
- CUK 2FT /3FT
- CX 1/2 BDF/M
- CLK 04 SCF /SCF-H /SCM
- CXL 2/4 PF /PM /PFH /PMH, CXL PF/PM

NOTE: Housing type may vary upon specific part No.

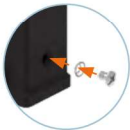

MKA IAP

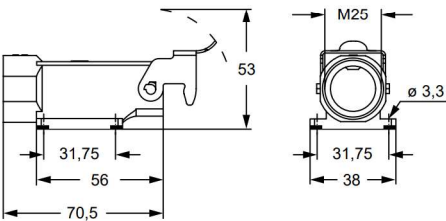

panel cut-out for enclosures

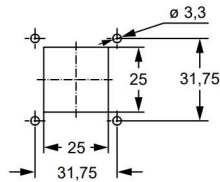

MKAXX IAP

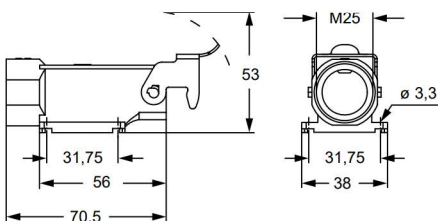

panel cut-out for enclosures

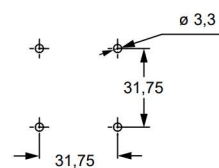

IP66/IP67/IP69 with CKR 65 (D) ¹⁾

MKAX W-TYPE for aggressive environments

inserts		page:
CK	3 and 4 poles + ⊕	58
CKS	3 and 4 poles + ⊕	-
CKSH	3 and 4 poles + ⊕	63
CD	8 poles	67
CQ4	2 poles + ⊕	182
CQ4 H	2 poles + ⊕	183
CQ4	3 poles + ⊕	184
CQ	5 poles + ⊕	186
CQ	7 poles + ⊕	187
CQ	12 poles + ⊕	189
CQ	21 poles	190

if the counterpart has glued gasket:

CJ KF	223
CJK 8FT	226
CLK 04 SC	239
CX 1/2 BD	243
CXL 2/4 SF/SM	250
CXL SF/SM	250
CXL 2/4 PF/PM	251
CXL 2/4 PFH/PMH	251
CXL PF/PM	251

**bulkhead mounting housings
stainless steel lever****description**part No.
(entry M32)

M32 fixing thread (•) 1)

MKAXW IFgasket and screw kit
for IP66/IP67/IP69 1)**CKR 65**gasket and screw kit for IP66/IP67/IP69 1)
specific for CD 08 inserts**CKR 65 D**

1) To obtain the IP66/IP67/IP69 degree of protection, a kit with insert fixing screw and gasket can be purchased separately. Several inserts size "21.21" are already supplied with fixing screw and gasket, which ensures IP66/IP67/IP69 degree of protection. See list below, not including any special version:

- CQF/M 07, CQF/M 12
- CJ KF
- CJK 8FT
- CX 1/2 BDF/M
- CLK 04 SCF /SCF-H /SCM
- CXL 2/4 PF /PM /PFH /PMH /SF /SM, CXL SF/M
- CXL PF /PM

NOTE: Housing type
may vary upon
specific part No.



(*) Locknut supplied on request, see Cable glands catalogue (article AS M32N metallic).

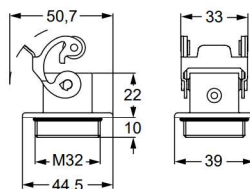
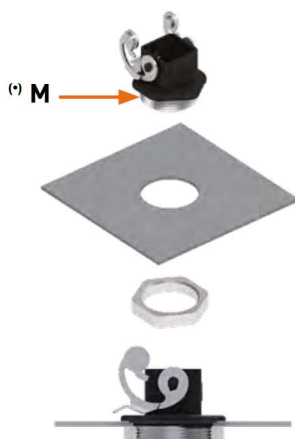

panel cut-out for enclosures

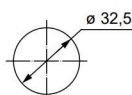

cURus
Type 4/4X/12 pending



IP66/IP67/IP69 with CKR 65 (D) 1)



MKAXX W-TYPE for aggressive environments

inserts		page:
CK	3 and 4 poles + ⊕	58
CKS	3 and 4 poles + ⊕	-
CKSH	3 and 4 poles + ⊕	63
CD	8 poles	67
CQ4	2 poles + ⊕	182
CQ4 H	2 poles + ⊕	183
CQ4	3 poles + ⊕	184
CQ	5 poles + ⊕	186
CQ	7 poles + ⊕	187
CQ	12 poles + ⊕	189
CQ	21 poles	190

if the counterpart has glued gasket:

CJ KF	223
CJK 8FT	226
CLK 04 SC	239
CX 1/2 BD	243
CXL 2/4 SF/SM	250
CXL SF/SM	250
CXL 2/4 PF/PM	251
CXL 2/4 PFH/PMH	251
CXL PF/PM	251

bulkhead mounting housings
stainless steel rigid lever



description	part No. (entry M32)
M32 fixing thread (1) 1)	MKAXXW IF
gasket and screw kit for IP66/IP67/IP69 1)	CKR 65
gasket and screw kit for IP66/IP67/IP69 1) specific for CD 08 inserts	CKR 65 D

1) To obtain the IP66/IP67/IP69 degree of protection, a kit with insert fixing screw and gasket can be purchased separately. Several inserts size “21.21” are already supplied with fixing screw and gasket, which ensures IP66/IP67/IP69 degree of protection. See list below, not including any special version:

- CQF/M 07, CQF/M 12
- CJ KF
- CJK 8FT
- CX 1/2 BDF/M
- CLK 04 SCF /SCF-H /SCM
- CXL 2/4 PF /PM /PFH /PMH /SF /SM, CXL SF/M
- CXL PF /PM

NOTE: Housing type may vary upon specific part No.

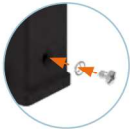

(1) Locknut supplied on request, see Cable glands catalogue (article AS M32N metallic).

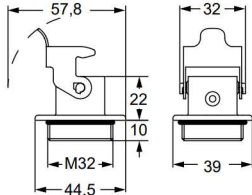
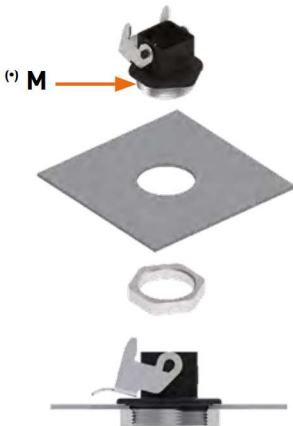

panel cut-out for enclosures

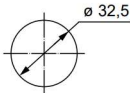

cURus
Type 4/4X/12 pending



IP66/IP67/IP69 with CKR 65 (D) 1)

MKAX - MKAXX W-TYPE for aggressive environments

inserts		page:
CK	3 and 4 poles + ⊕	58
CKS	3 and 4 poles + ⊕	-
CKSH	3 and 4 poles + ⊕	63
CD	8 poles	67
CQ4	2 poles + ⊕	182
CQ4 H	2 poles + ⊕	183
CQ4	3 poles + ⊕	184
CQ	5 poles + ⊕	186
CQ	7 poles + ⊕	187
CQ	12 poles + ⊕	189
CQ	21 poles	190

if the counterpart has glued gasket:

CJ KM	223
CJK 8MT	226
CJK 8IMT	226, 228
CLK 04 SC	239
CX 1/2 BD	243
CXL 2/4 SF/SM	250
CXL SF/SM	250
CXL 2/4 PF/PM	251
CXL 2/4 PFH/PMH	251
CXL PF/PM	251

hoods
stainless steel leverhoods
galvanized steel rigid lever

description	part No. (entry M25)	part No. (entry M25)
top entry	MKAXW VG25	MKAXXW VG25
gasket and screw kit for IP66/IP67/IP69 1)	CKR 65	CKR 65
gasket and screw kit for IP66/IP67/IP69 1) specific for CD 08 inserts	CKR 65 D	CKR 65 D

1) To obtain the IP66/IP67/IP69 degree of protection, a kit with insert fixing screw and gasket can be purchased separately. Several inserts size "21.21" are already supplied with fixing screw and gasket, which ensures IP66/IP67/IP69 degree of protection. See list below, not including any special version:

- CQF/M 07, CQF/M 12
- CJ KM
- CJK 8MT /8IMT
- CX 1/2 BDF/M
- CLK 04 SCF /SCF-H /SCM
- CXL 2/4 PF /PM /PFH /PMH /SF /SM, CXL SF/M
- CXL PF /PM

NOTE: Housing type may vary upon specific part No.

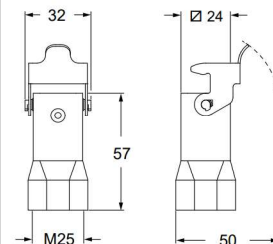
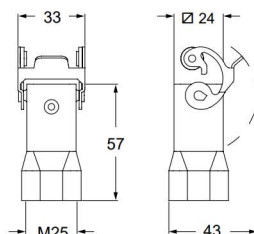
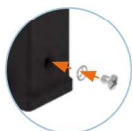

cURus
Type 12 / Type 4/4X only with CKR 65 (D)
pending



IP66/IP67/IP69 with CKR 65 (D) 1)



CZ7 - MZ7 CZ - MZ and CZA - MZA W-TYPE for aggressive environments

inserts		page:
CD	15 poles + ⊕	68
CDA	10 poles + ⊕	98
CSAH	10 poles + ⊕	99
CDC	10 poles + ⊕	104
MIXO	1 module	264 - 316

The covers for L, SL and LG versions cannot be used together with coding pins. If this application is required, please contact ILME SpA.

housings and cover



hoods and cover



description	part No.	entry Pg	part No.	entry M	part No.	entry Pg	part No.	entry M
bulkhead mounting housing with lever and gasket	CZ7IW 15 L	--						
surface mounting housing, with lever	CZ7PW 15 L2	16 x 2	MZ7PW 15L225	25 x 2				
cover with pegs and gasket (for 1 lever enclosures) ¹⁾	CZCW 15 L							
cover with pegs and gasket (for 1 lever enclosures) ²⁾	CZCW 15 SL							
enclosure with pegs and gasket, side entry					CZOW 15 L	16	MZOW 15 L20	20
enclosure with pegs and gasket, side entry							MZOW 15 L25	25
enclosure with pegs and gasket, side entry, high construction					CZAOW 15 L21	21	MZAOW 15 L25	25
enclosure with pegs and gasket, top entry					CZVW 15 L	13,5	MZVW 15 L20	20
enclosure with pegs and gasket, top entry, high construction					CZAVW 15 L21	21	MZAVW 15 L25	25
cover with lever (for enclosures with pegs) ²⁾					CZ7CW 15 LG			

panel cut-out for bulkhead mounting housings

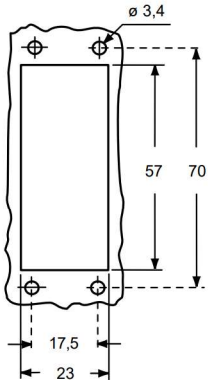

For fixing on housings

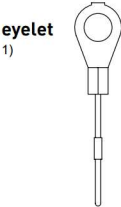

For fixing on hoods

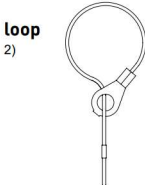

CU[®] Type 4/4X/12



insulating cable gland or fittings without gasket



cable gland with O-Ring gasket

CZ7IW L

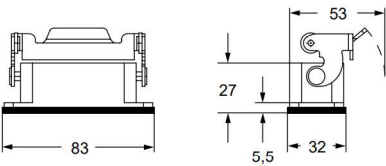

CZ7PW L and MZ7PW L

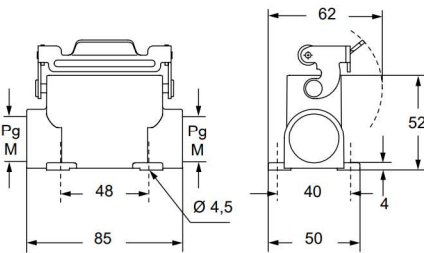

CZCW L (SL)

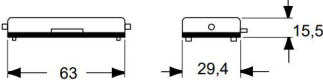

CZOW L and MZOW L

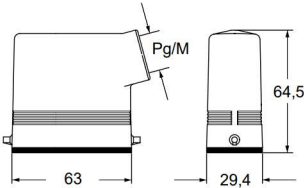

CZAOW L - MZAOW L and CZAVW L - MZAVW L

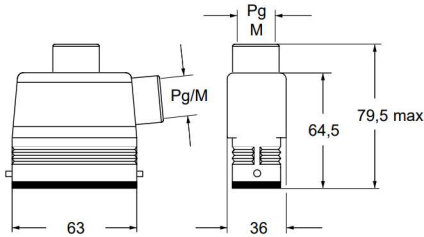

CZVW L and MZVW L

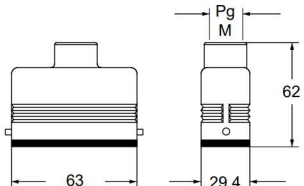

CZ7CW LG

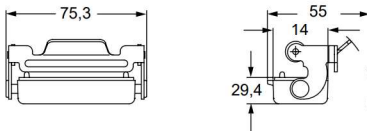

CZ7 - MZ7 CZ - MZ and CZA - MZA W-TYPE for aggressive environments

inserts

CD	25 poles + ⊕	69
CDD	38 poles + ⊕	77
CDA	16 poles + ⊕	100
CSAH	16 poles + ⊕	101
CDC	16 poles + ⊕	105

page:

housings and cover

hoods and cover

The covers for L, SL and LG versions cannot be used together with coding pins. If this application is required, please contact ILME SpA.

description	part No.	entry Pg	part No	entry M	part No.	entry Pg	part No.	entry M
bulkhead mounting housing with lever and gasket	CZ7IW 25 L	--						
surface mounting housing, with lever	CZ7PW 25 L2	16 x 2	MZ7PW 25L225	25 x 2				
cover with pegs (for 1 lever enclosures) ¹⁾	CZCW 25 L							
cover with pegs (for 1 lever enclosures) ²⁾	CZCW 25 SL							
enclosure with pegs and gasket, side entry					CZOW 25 L	16	MZOW 25 L20	20
enclosure with pegs and gasket, side entry							MZOW 25 L25	25
enclosure with pegs and gasket, side entry, high construction					CZAOW 25 L21	21	MZAOW 25 L25	25
enclosure with pegs and gasket, top entry					CZVW 25 L	16	MZVW 25 L20	20
enclosure with pegs and gasket, top entry, high construction					CZAVW 25 L21	21	MZAVW 25 L25	25
cover with lever (for enclosures with pegs) ²⁾					CZ7CW 25 LG			

panel cut-out for bulkhead mounting housings

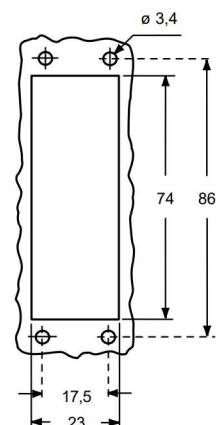

For fixing
on housings

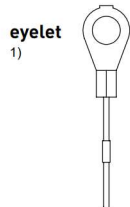

For fixing
on hoods

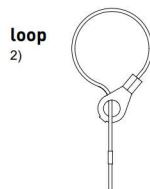

ILME® Type
4/4X/12



insulating cable gland or fittings
without gasket

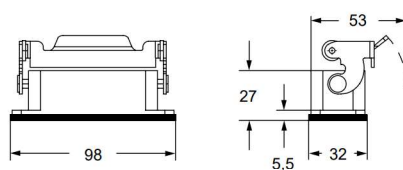
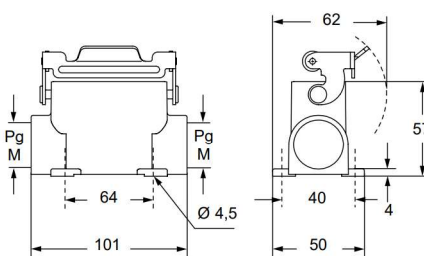
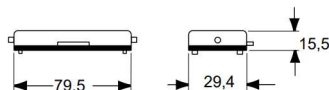
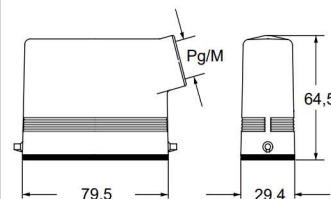
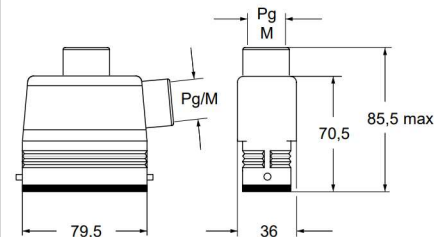
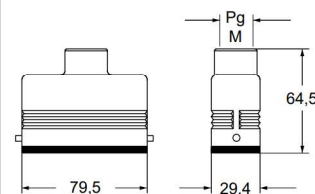

cable gland
with O-Ring gasket

CZ7IW L**CZ7PW L and MZ7PW L****CZCW L (SL)****CZOW L and MZOW L****CZAOW L - MZAOW L and CZAVW L - MZAVW L****CZVW L and MZVW L ***

* can only be used with a complete cable gland (to be purchased separately)

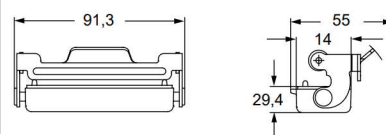
CZ7CW LG



CH - CA and MA W-TYPE for aggressive environments

inserts		page:
CDD	24 poles + ⊕	76
CDS	9 poles + ⊕	-
CDSH	9 poles + ⊕	86
CDSH NC	6 poles + ⊕	95
CNE	6 poles + ⊕	110
CSE	6 poles + ⊕	-
CSH	6 poles + ⊕	110
CSH S	6 poles + ⊕	122
CCE	6 poles + ⊕	130
CSS	6 poles + ⊕	148
CT, CTSE (16A) *)	6 poles + ⊕	160
CQE	10 poles + ⊕	168
MIXO	2 modules	262 - 317

*) only for enclosure CHIW 06 L

housings and cover



hoods and cover



description	part No.	entry Pg	part No	entry M	part No.	entry Pg	part No.	entry M
bulkhead mounting housing with lever and gasket	CHIW 06 L	--						
surface mounting housing, with lever, high construction	CAPW 06 L	21	MAPW 06 L32	32				
cover with pegs (for 1 lever enclosures) ¹⁾	CHCW 06 L							
cover with pegs (for 1 lever enclosures) ²⁾	CHCW 06 SL							
enclosure with pegs, side entry, high construction					CAOW 06 L21	21	MAOW 06 L32	32
enclosure with pegs, top entry, high construction					CAVW 06 L21	21	MAVW 06 L32	32
cover with lever (for enclosures with pegs) ²⁾					CHCW 06 LG			
enclosure with lever and gasket, side entry, high construction					CAVW 06 LG	21	MAVW 06 LG32	32

panel cut-out for bulkhead mounting housings

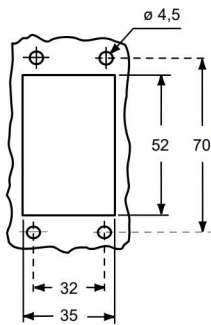

For fixing
on housings

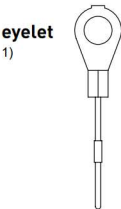

For fixing
on hoods

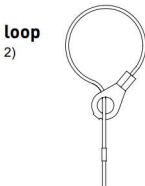

CAIUS Type 4/4X/12



insulating cable gland or fittings
without gasket



cable gland
with O-Ring gasket

CHIW L

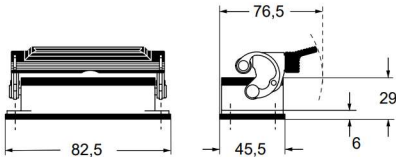

CAPW L and MAPW L

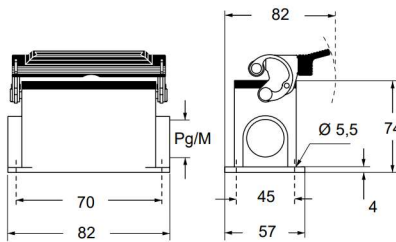

CHCW L (SL)



CAOW L and MAOW L

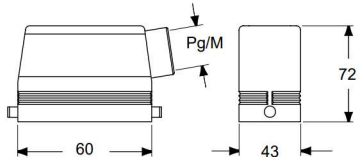

CAVW L and MAVW L

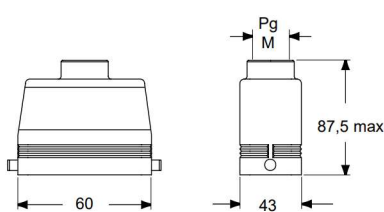

CHCW LG

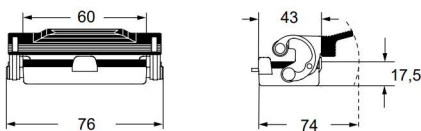

CAVW LG and MAVW LG

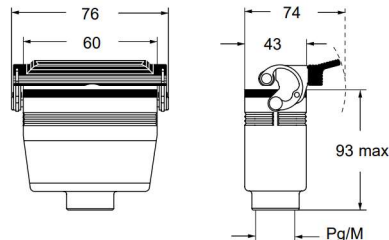

CH - CA and MA W-TYPE for aggressive environments

inserts		page:
CDD	42 poles + ⊕	78
CDS	18 poles + ⊕	-
CDSH	18 poles + ⊕	87
CNE	10 poles + ⊕	111
CSE	10 poles + ⊕	-
CSH	10 poles + ⊕	111
CSH S	10 poles + ⊕	123
CCE	10 poles + ⊕	131
CMSH	3+2 (aux) poles + ⊕	136
CMCE	3+2 (aux) poles + ⊕	137
CSS	10 poles + ⊕	149
CT, CTSE (16A) *)	10 poles + ⊕	161
CQE	18 poles + ⊕	169
CX	8/24 poles + ⊕	194
MIXO	3 modules	262 - 317

*) only for enclosure CHIW 10

housings and cover**hoods and cover**

description	part No.	entry Pg	part No	entry M	part No.	entry Pg	part No.	entry M
bulkhead mounting housing with levers and gasket	CHIW 10	--						
surface mounting housing, with levers, high construction	CAPW 10.21	21	MAPW 10.32	32				
cover with 4 pegs (for enclosures with 2 levers) ¹⁾	CHCW 10							
cover with 4 pegs (for enclosures with 2 levers) ²⁾	CHCW 10 S							
enclosure with pegs, side entry, high construction					CAOW 10.21	21	MAOW 10.32	32
enclosure with pegs, top entry, high construction					CAVW 10.21	21	MAVW 10.32	32
cover with 2 levers (for enclosures with 4 pegs) ²⁾					CHCW 10 G			
enclosure with levers and gasket, top entry, high construction					CAVW 10 G	21	MAVW 10 G32	32

panel cut-out for bulkhead mounting housings

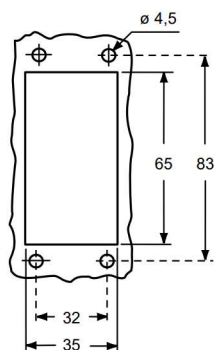
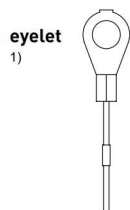
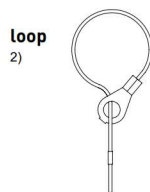
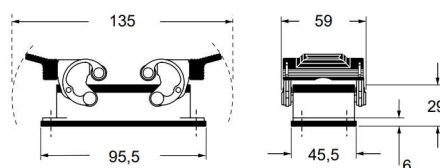
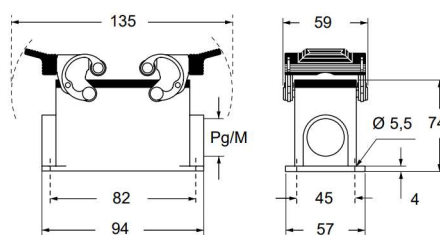
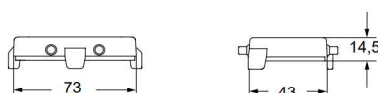
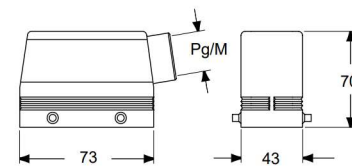
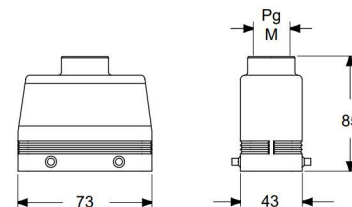
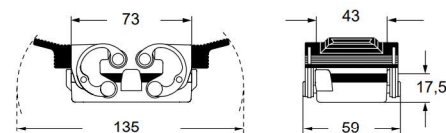
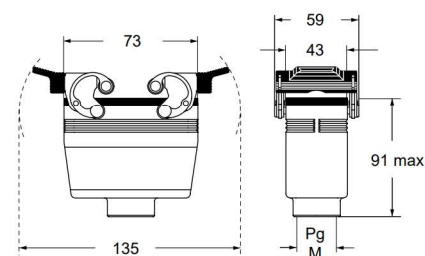
For fixing
on housingsFor fixing
on hoods**CAI[®]US**Type
4/4X/12insulating cable gland or fittings
without gasketcable gland
with O-Ring gasket**CHIW****CAPW and MAPW****CHCW (S)****CAOW and MAOW****CAVW and MAVW****CHCW G****CAVW G and MAVW G**



CH - CA and MH - MA W-TYPE for aggressive environments

inserts		page:
CD	40 poles + ⊕	70
CDD	72 poles + ⊕	79
CDS	27 poles + ⊕	-
CDSH	27 poles + ⊕	88
CNE	16 poles + ⊕	112
CSE	16 poles + ⊕	-
CSH	16 poles + ⊕	112
CSH S	16 poles + ⊕	124
CCE	16 poles + ⊕	132
CMSH, CMCE	6+2 (aux) poles + ⊕	138 - 139
CSS	16 poles + ⊕	150
CT, CTS (10A) *)	40 poles + ⊕	156
CT, CTSE (16A) *)	16 poles + ⊕	162
CQE	32 poles + ⊕	170
CQEE	40 poles + ⊕	176
CP	6 poles + ⊕	178
CX	6/12, 6/36 and 12/2 poles + ⊕	197 - 199
CX	4/0 and 4/2 poles + ⊕	200 - 201
MIXO	4 modules	262 - 317

*) only for enclosure CHIW 16

housings and cover



hoods and cover



description	part No.	entry Pg	part No	entry M	part No.	entry Pg	part No.	entry M
bulkhead mounting housing with levers and gasket	CHIW 16	-						
surface mounting housing, with levers, high construction	CAPW 16.21	21	MAPW 16.32	32				
cover with 4 pegs (for enclosures with 2 levers) ¹⁾	CHCW 16							
cover with 4 pegs (for enclosures with 2 levers) ²⁾	CHCW 16 S							
enclosure with pegs, side entry					CHOW 16	21	MHOW 16.25	25
enclosure with pegs, side entry							MHOW 16.32	32
enclosure with pegs, side entry, high construction					CAOW 16.29	29	MAOW 16.32	32
enclosure with pegs, side entry, high construction							MAOW 16.40	40
enclosure with pegs, top entry					CHVW 16	21	MHVW 16.25	25
enclosure with pegs, top entry							MHVW 16.32	32
enclosure with pegs, top entry, high construction					CAVW 16.29	29	MAVW 16.32	32
enclosure with pegs, top entry, high construction							MAVW 16.40	40
cover with 2 levers (for enclosures with 4 pegs) ²⁾					CHCW 16 G			
enclosure with levers and gasket, top entry, high construction					CAVW 16 G29	29	MAVW 16 G32	32

panel cut-out for bulkhead mounting housings

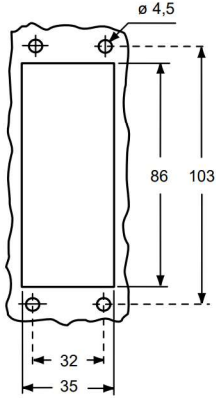

For fixing on housings

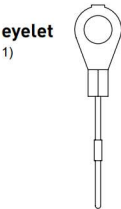

For fixing on hoods

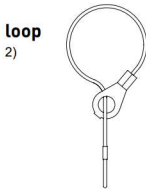

CU[®] Type 4/4X/12



insulating cable gland or fittings without gasket



cable gland with O-Ring gasket

CHIW

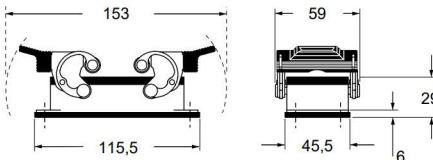

CAPW and MAPW

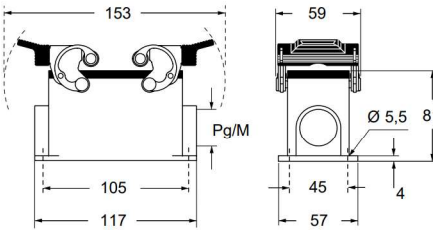

CHCW (S)

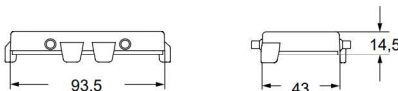

CHOW (CAOW) and MHOW (MAOW)

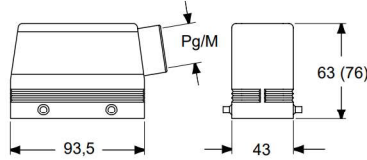

CHVW (CAVW) and MHVW (MAVW)

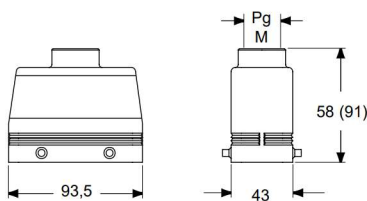

CHCW G

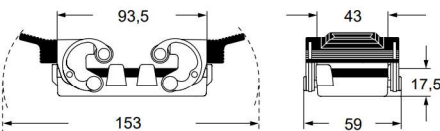

CAVW G and MAVW G

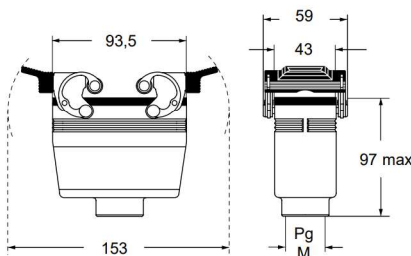

CH - CA and MH - MA W-TYPE for aggressive environments

inserts		page:
CD	64 poles + ⊕	72
CDD	108 poles + ⊕	81
CDS	42 poles + ⊕	-
CDSH	42 poles + ⊕	89
CNE	24 poles + ⊕	113
CSE	24 poles + ⊕	-
CSH	24 poles + ⊕	113
CSH S	24 poles + ⊕	125
CCE	24 poles + ⊕	133
CMSH	10+2 (aux) poles + ⊕	140
CMCE	10+2 (aux) poles + ⊕	141
CSS	24 poles + ⊕	151
CT, CTS (10A) *	64 poles + ⊕	157
CT, CTSE (16A) *	24 poles + ⊕	163
CQE	46 poles + ⊕	171
CQEE	64 poles + ⊕	177
CX	4/8 and 6/6 poles + ⊕	204, 206
MIXO	6 modules	262 - 317

*) only for enclosure CHIW 24

housings and cover**hoods and cover**

description	part No.	entry Pg	part No.	entry M	part No.	entry Pg	part No.	entry M
bulkhead mounting housing with levers and gasket	CHIW 24	--						
surface mounting housing, with levers, high construction	CAPW 24.21	21	MAPW 24.32	32				
cover with 4 pegs (for enclosures with 2 levers) ¹⁾	CHCW 24							
cover with 4 pegs (for enclosures with 2 levers) ²⁾	CHCW 24 S							
enclosure with pegs, side entry					CHOW 24	21	MHOW 24.25	25
enclosure with pegs, side entry							MHOW 24.32	32
enclosure with pegs, side entry, high construction					CAOW 24.29	29	MAOW 24.32	32
enclosure with pegs, side entry, high construction							MAOW 24.40	40
enclosure with pegs, top entry					CHVW 24	21	MHVW 24.25	25
enclosure with pegs, top entry							MHVW 24.32	32
enclosure with pegs, top entry, high construction					CAVW 24.29	29	MAVW 24.32	32
enclosure with pegs, top entry, high construction							MAVW 24.40	40
cover with 2 levers (for enclosures with 4 pegs) ²⁾					CHCW 24 G			
enclosure with levers and gasket, top entry					CHVW 24 G	21	MHVW 24 G32	32

panel cut-out for bulkhead mounting housings

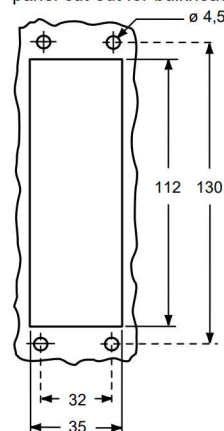
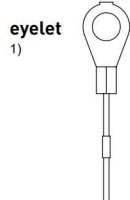
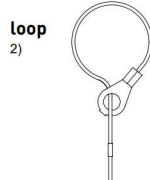
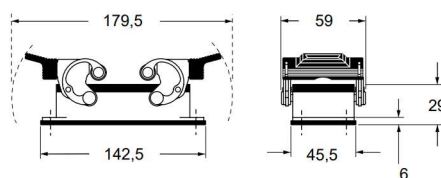
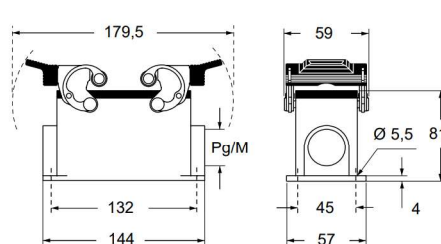
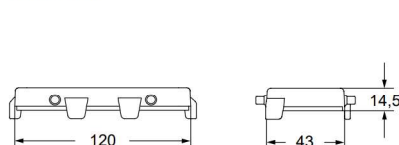
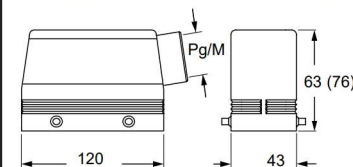
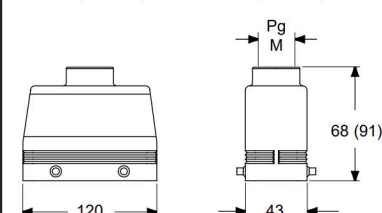
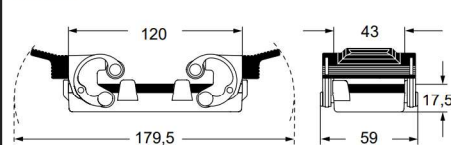
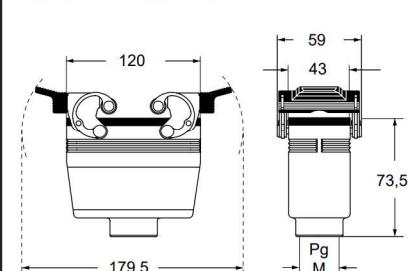
For fixing
on housingsFor fixing
on hoods**CAIUS** Type
4/4X/12insulating cable gland or fittings
without gasketcable gland
with O-Ring gasket**CHIW****CAPW and MAPW****CHCW (S)****CHOW (CAOW) and MHOW (MAOW)****CHVW (CAVW) and MHVW (MAVW)****CHCW G****CHVW G and MHVW G**



CH and MH W-TYPE for aggressive environments

inserts		page:
CD	80 poles + ⊕	73
CDD	144 poles + ⊕	82
CDS	54 poles + ⊕	-
CDSH	54 poles + ⊕	90
CNE	32 poles + ⊕	114
CSE	32 poles + ⊕	-
CSH	32 poles + ⊕	114
CSH S	32 poles + ⊕	126
CCE	32 poles + ⊕	134
CSS	32 poles + ⊕	152
CTSE (16A) *)	32 poles + ⊕	164
CQE	64 poles + ⊕	172
CME	12+4 (aux) poles + ⊕	142
CMSh	12+4 (aux) poles + ⊕	142
CMCE	12+4 (aux) poles + ⊕	143
CP	12 poles + ⊕	179
MIXO	4 + 4 modules	262 - 317

*) only for enclosure CHIW 32

insert dimensions:
2 x (77,5 x 27) mm

housings and cover



hoods and cover



description	part No.	entry Pg	part No	entry M	part No.	entry Pg	part No.	entry M
bulkhead mounting housing with levers and gasket	CHIW 32	—						
surface mounting housing, with levers	CHPW 32	36	MHPW 32.50	50				
cover with 4 pegs (for enclosures with 2 levers) ¹⁾	CHCW 32							
cover with 4 pegs (for enclosures with 2 levers) ²⁾	CHCW 32 S							
enclosure with pegs, side entry					CHOW 32	36	MHOW 32.40	40
enclosure with pegs, top entry					CHVW 32	36	MHVW 32.40	40
cover with 2 levers (for enclosures with 4 pegs) ²⁾					CHCW 32 G			
enclosure with levers and gasket, top entry					CHVW 32 G	36	MHVW 32 G40	40

panel cut-out for bulkhead mounting housings

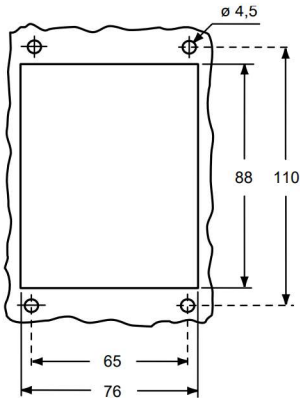

For fixing
on housings

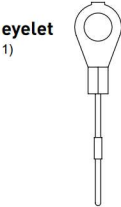

For fixing
on hoods

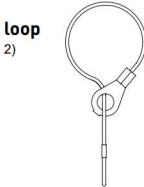

CU[®] Type
4/4X/12



insulating cable gland or fittings
without gasket



cable gland
with O-Ring gasket

CHIW

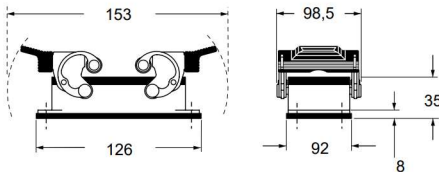

CHPW and MHPW

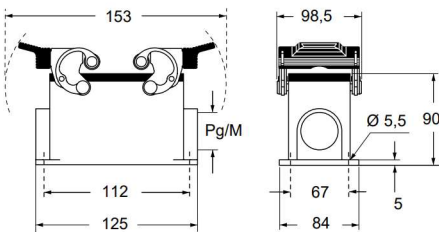

CHCW (S)

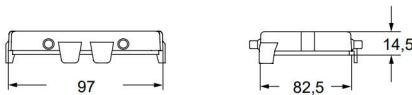

CHOW and MHOW

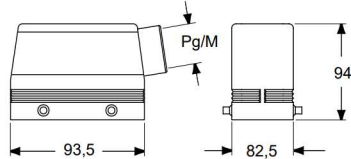

CHVW and MHVW

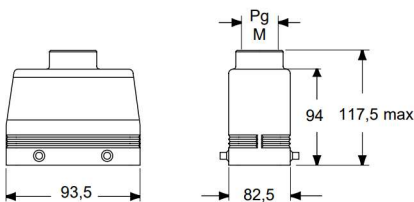

CHCW G

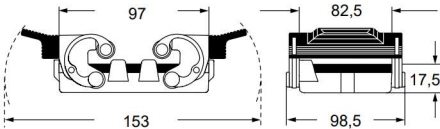

CHVW G and MHVW G

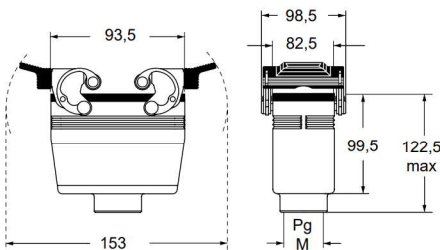

CH and MH W-TYPE for aggressive environments

inserts		page:
CD	128 poles + ⊕	74
CDD	216 poles + ⊕	83
CDS	84 poles + ⊕	-
CDSH	84 poles + ⊕	91
CNE	48 poles + ⊕	115
CSE	48 poles + ⊕	-
CSH	48 poles + ⊕	115
CSH S	48 poles + ⊕	127
CCE	48 poles + ⊕	135
CME	20+4 (aux) poles + ⊕	144
CMSH	20+4 (aux) poles + ⊕	144
CSS	48 poles + ⊕	153
CTSE (16A) *)	48 poles + ⊕	165
CQE	92 poles + ⊕	173
MIXO	6 + 6 modules	262 - 317

*) only for enclosure CHIW 48 LS

insert dimensions:

2 x (104 x 27) mm**bulkhead and surface mounting housings****hoods**

description	part No.	entry Pg	part No.	entry M	part No.	entry Pg	part No.	entry M
bulkhead mounting housings, with lever, gasket and cover	CHIW 48 LS	--						
surface mounting housings, with lever and cover	CHPW 48 LS	36 x 1/2	MHPW 48 LS40	40 x 1/2				
side entry, with pegs					CHOW 48 L	36	MHOW 48 L40	40
top entry, with pegs					CHVW 48 L	36	MHVW 48 L40	40

panel cut-out for bulkhead mounting housings

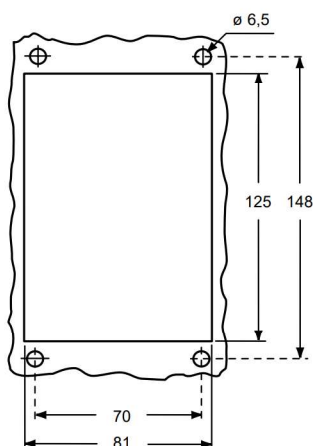
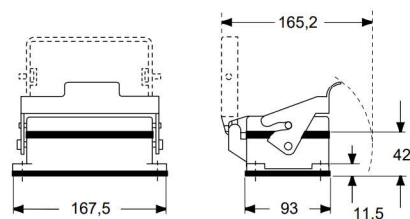
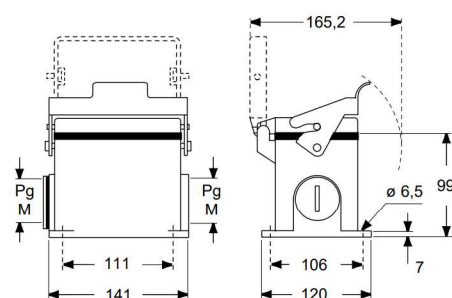
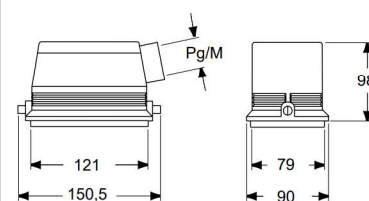
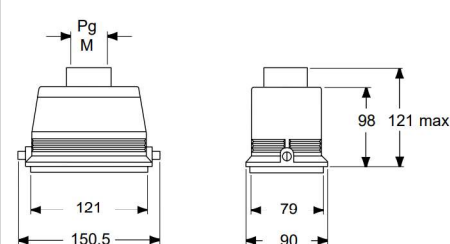
**CHIW LS****CHPW LS and MHPW LS****CHOW L and MHOW L****CHVW L and MHVW L****CAUS** Type 4/4X/12insulating cable gland or fittings
without gasketcable gland
with O-Ring gasket



CH - CA and MH - MA W-TYPE for aggressive environments

inserts		page:
CD	50 poles + ⊕	71
CDD	76 poles + ⊕	80
CDA	32 poles + ⊕	102
CSAH	32 poles + ⊕	103
CDC	32 poles + ⊕	106

insert dimensions:
2 x (66 x 16) mm

CHCW 50 and CHCW 50 G covers
cannot be used together with coding pins.
If this application is required, please contact
ILME SpA.

housings and cover



hoods and cover



description	part No.	entry Pg	part No	entry M	part No.	entry Pg	part No.	entry M
bulkhead mounting housings with levers and gasket	CHIW 50	--						
surface mounting housing, with levers	CHPW 50.21	21	MHPW 50.32	32				
surface mounting housing, with levers	CHPW 50.229	29 x 2	MHPW 50.240	40 x 2				
cover with 4 pegs (for housings with 2 levers) ¹⁾	CHCW 50							
cover with 4 pegs (for housings with 2 levers) ²⁾	CHCW 50 S							
enclosure with 4 pegs, side entry					CHOW 50	21	MHOW 50.25	25
enclosure with 4 pegs, side entry							MHOW 50.32	32
enclosure with 4 pegs, side entry, high construction					CAOW 50.29	29	MAOW 50.32	32
enclosure with 4 pegs, top entry, high construction					CAVW 50.29	29	MAVW 50.32	32
cover with 2 levers (for enclosures with 4 pegs) ²⁾					CHCW 50 G			

panel cut-out for bulkhead mounting housings

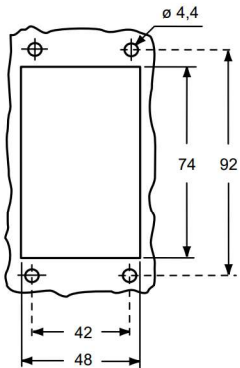

For fixing
on housings

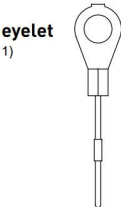

For fixing
on hoods

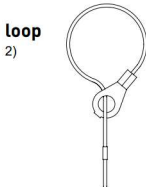

CU[®] Type
4/4X/12



insulating cable gland or fittings
without gasket



cable gland
with O-Ring gasket

CHIW

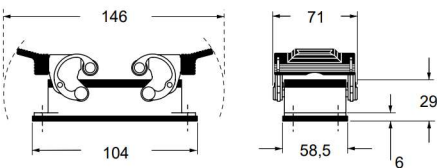

CHPW and MHPW

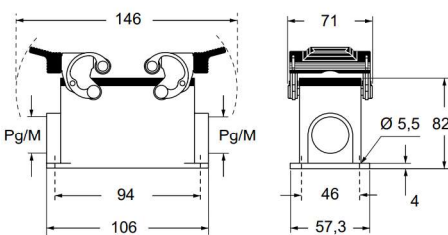

CHCW (S)

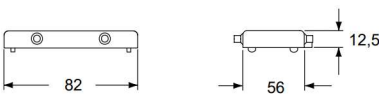

CHOW (CAOW) and MHOW (MAOW)

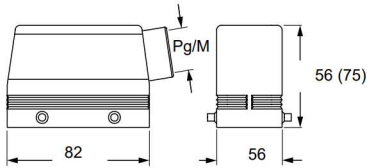

CAVW and MAVW

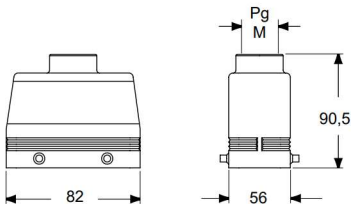

CHCW G

