

**CX 01 YF/YM 1 pole 200A - 1000V**

The modular inserts must be installed in suitable frames, which are then mounted in traditional enclosures\* or in COB panel supports.

frames for modular units\*

page: 317

\* enclosures: housings or high construction hoods

modular units, crimp connections

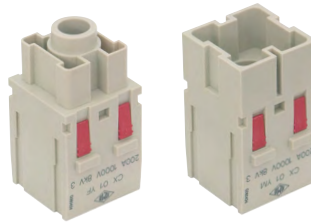

200A silver plated crimp contacts heat shrink tube



description	part No.	part No
-------------	----------	---------

without contacts (to be ordered separately)  
female inserts for female contacts  
male inserts for male contacts

**CX 01 YF**  
**CX 01 YM**

200A female crimp contacts

16 mm <sup>2</sup>	AWG 6	one groove (back side)
25 mm <sup>2</sup>	AWG 4	with no grooves
35 mm <sup>2</sup>	AWG 2	one groove
50 mm <sup>2</sup>	AWG 1	two grooves
70 mm <sup>2</sup>	AWG 2/0	with no grooves

**CYFA 16**  
**CYFA 25**  
**CYFA 35**  
**CYFA 50**  
**CYFA 70**

200A male crimp contacts

16 mm <sup>2</sup>	AWG 6	one groove (back side)
25 mm <sup>2</sup>	AWG 4	with no grooves
35 mm <sup>2</sup>	AWG 2	one groove
50 mm <sup>2</sup>	AWG 1	two grooves
70 mm <sup>2</sup>	AWG 2/0	with no grooves

**CYMA 16**  
**CYMA 25**  
**CYMA 35**  
**CYMA 50**  
**CYMA 70**

heat shrink tube for CYFA/CYMA 16 contacts or for conductor with total external Ø < 10 mm

**CR TT**

- characteristics according to EN 61984:

**200A 1000V 8kV 3**  
**200A 920/1600V 8kV 2**

- cULus (UL for USA and Canada),

- certified

- rated voltage according to UL/CSA: 600V

- insulation resistance: ≥ 10 GΩ

- ambient temperature limit: -40 °C ... +125 °C

- made of self-extinguishing thermoplastic resin UL 94V-0

- mechanical life: ≥ 500 cycles

- contact resistance: ≤ 0,2 mΩ

- **it is recommended to crimp the contacts with crimping tools homologated by ILME** (please see the crimping tool section 200A contacts, CYF and CYM series) on pages 708 - 741

- for max. current load see the connector inserts derating diagram below; for more information see page 28

**CX 01 Y, 1 pole connector inserts (MIXO 200A)**  
**Maximum current load derating diagram**

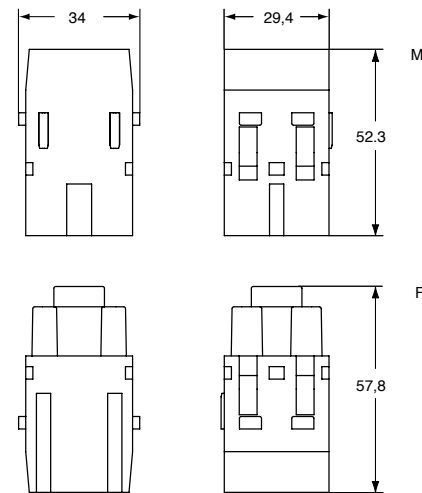
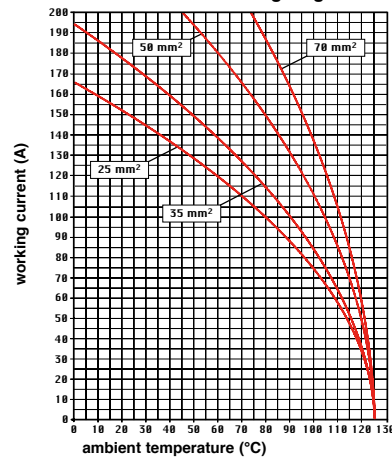

contacts side (front view)

side with reference arrow ▲

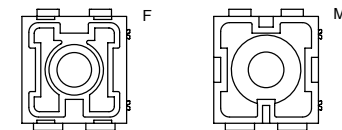

- 2 frame slots

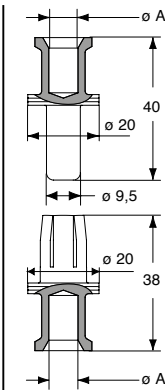

**CYF and CYM contacts**

conductor section (mm <sup>2</sup> )	conductor slot (mm)	conductor stripping length (mm)
16	6,1	15
25	7,0	15
35	8,2	15
50	9,8	15
70	11,8	15

silver plated

MIXO INSERTS

# CX 01 YPEF/YPEM 1 PE pole 200A

The modular inserts must be installed in suitable frames, which are then mounted in traditional enclosures\* or in COB panel supports.

modular units, crimp connections  
PE module for earth termination

200A silver plated crimp contacts

frames for modular units\*

page:  
317

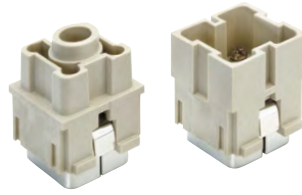

\* enclosures: housings or high construction hoods

description	part No.	part No
-------------	----------	---------

without contacts (to be ordered separately)  
PE female inserts for female contacts  
PE male inserts for male contacts

**CX 01 YPEF**  
**CX 01 YPEM**

200A female crimp contacts		
16 mm <sup>2</sup>	AWG 6	one groove (back side)
25 mm <sup>2</sup>	AWG 4	with no grooves
35 mm <sup>2</sup>	AWG 2	one groove
50 mm <sup>2</sup>	AWG 1	two grooves
70 mm <sup>2</sup>	AWG 2/0	with no grooves

**CYFA 16**  
**CYFA 25**  
**CYFA 35**  
**CYFA 50**  
**CYFA 70**

silver plated

200A male crimp contacts		
16 mm <sup>2</sup>	AWG 6	one groove (back side)
25 mm <sup>2</sup>	AWG 4	with no grooves
35 mm <sup>2</sup>	AWG 2	one groove
50 mm <sup>2</sup>	AWG 1	two grooves
70 mm <sup>2</sup>	AWG 2/0	with no grooves

**CYMA 16**  
**CYMA 25**  
**CYMA 35**  
**CYMA 50**  
**CYMA 70**

- (UL for USA and Canada), certified
- ambient temperature limit: -40 °C ... +125 °C
- made of self-extinguishing thermoplastic resin UL 94V-0
- mechanical life: ≥ 500 cycles
- contact resistance: ≤ 0,2 mΩ
- **it is recommended to crimp the contacts with crimping tools homologated by ILME** (please see the crimping tool section 200A contacts, CYF and CYM series) on pages 708 - 741

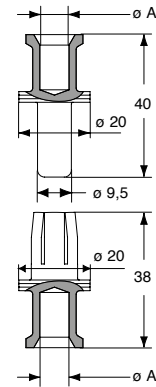
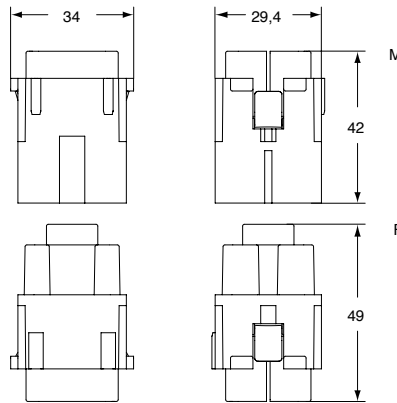

contacts side (front view)

side with reference arrow ▲

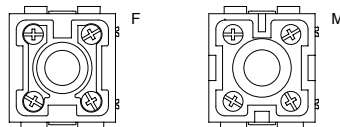

- 2 frame slots

**CYF and CYM contacts**

conductor section ø A (mm <sup>2</sup> )	conductor slot (mm)	conductor stripping length (mm)
16	6,1	15
25	7,0	15
35	8,2	15
50	9,8	15
70	11,8	15

**CX 01 GF/GM 1 pole 100A - 830V**

The modular inserts must be installed in suitable frames which are then mounted in traditional enclosures\* or in COB panel support.  
Single-sized modular units may be directly mounted inside MIXO ONE enclosures.

frames for modular units\* page:  
316 - 317

MIXO ONE enclosures 369

\* enclosures: bulkhead mounting housings, high construction housings or high construction hoods

modular units,  
crimp connections



100A silver plated crimp contacts,  
PE adapter



description	part No.	part No.
without contacts (to be ordered separately)		
female inserts for female contacts	<b>CX 01 GF</b>	
male inserts for male contacts	<b>CX 01 GM</b>	
100A female crimp contacts		<b>CGFA 10</b>
8-10 mm <sup>2</sup> AWG 8-7		<b>CGFA 16</b>
16 mm <sup>2</sup> AWG 6-5		<b>CGFA 25</b>
25 mm <sup>2</sup> AWG 4-3		<b>CGFA 35</b>
35 mm <sup>2</sup> AWG 2		
100A male crimp contacts		<b>CGMA 10</b>
8-10 mm <sup>2</sup> AWG 8-7		<b>CGMA 16</b>
16 mm <sup>2</sup> AWG 6-5		<b>CGMA 25</b>
25 mm <sup>2</sup> AWG 4-3		<b>CGMA 35</b>
35 mm <sup>2</sup> AWG 2		
cable earthing adapter 16 mm <sup>2</sup> (AWG 6-5)		<b>CGT 16</b>

silver plated

MIXO INSERTS

- characteristics according to EN 61984:
- 100A 830V 8kV 3**
- certified
- rated voltage according to UL/CSA: 600V
- insulation resistance: ≥ 10 GΩ
- ambient temperature limit: -40 °C ... +125 °C
- made of self-extinguishing thermoplastic resin UL 94V-0
- mechanical life: ≥ 500 cycles
- contact resistance: ≤ 0,3 mΩ
- **it is recommended to crimp the contacts with crimping tools homologated by ILME** (please see the crimping tool section 100A contacts, CGF and CGM series) on pages 708 - 741
- contact removal only using a screwdriver
- for max. current load see the connector inserts derating diagram below; for more information see page 28

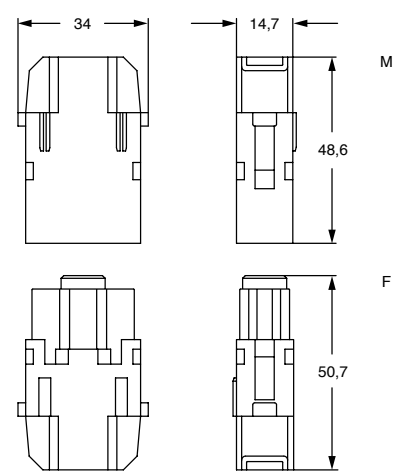

contacts side (front view)

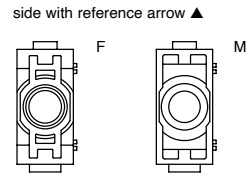

- 1 frame slot

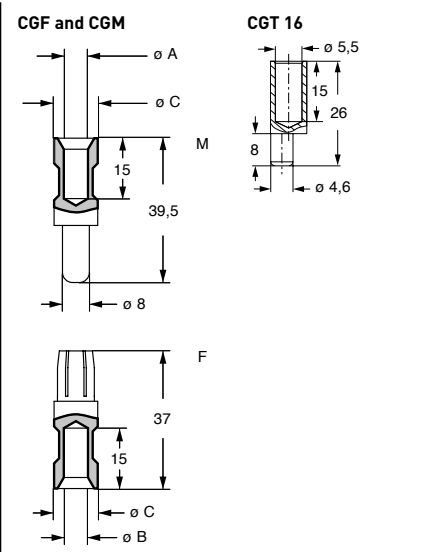

**CGF and CGM contacts**

conductor section (mm <sup>2</sup> )	conductor ø A (mm)	conductor slot ø B (mm)	ø C (mm)	conductor stripping length (mm)
8-10	4,3	4,3	13	15
16	5,5	5,5	13	15
25	7,0	7,0	13	15
35	7,9	8,2	12,5	15

- How to use the PE adapter (CGT 16):**
- 1) Strip 15 mm of flexible PE protective cable
  - 2) Crimp the cable on the CGT 16 adapter by using the CGPZ pliers with the CGD 16 C matrix
  - 3) Fix the adapter tip in the larger earth terminal (6 mm<sup>2</sup>) of frames CX...TM/TF
  - 4) To be used with bulkhead mounting housings or high construction hoods
  - 5) Cannot be used with T-TYPE series

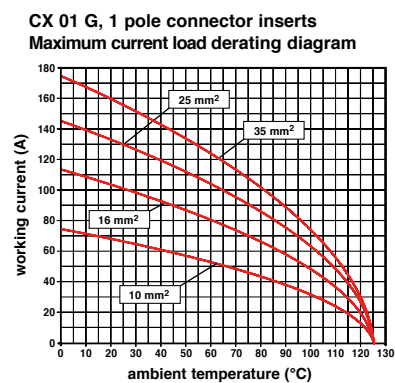

# CX 02 GF/GM 2 poles 100A - 1000V

The modular inserts must be installed in suitable frames, which are then mounted in traditional enclosures\* or in COB panel supports.

frames for modular units\*

page:  
317

modular units,  
crimp connections

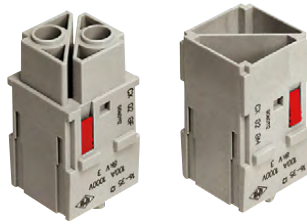

100A silver plated crimp contacts,  
PE adapter



\* enclosures: bulkhead mounting housings, high construction housings or high construction hoods

description	part No.	part No
without contacts (to be ordered separately)		
female inserts for female contacts <sup>1)</sup>	<b>CX 02 GF</b>	
male inserts for male contacts <sup>1)</sup>	<b>CX 02 GM</b>	
100A female crimp contacts		
8-10 mm <sup>2</sup> AWG 8-7		<b>CGFA 10</b>
16 mm <sup>2</sup> AWG 6-5		<b>CGFA 16</b>
25 mm <sup>2</sup> AWG 4-3		<b>CGFA 25</b>
35 mm <sup>2</sup> AWG 2		<b>CGFA 35</b>
100A male crimp contacts		
8-10 mm <sup>2</sup> AWG 8-7		<b>CGMA 10</b>
16 mm <sup>2</sup> AWG 6-5		<b>CGMA 16</b>
25 mm <sup>2</sup> AWG 4-3		<b>CGMA 25</b>
35 mm <sup>2</sup> AWG 2		<b>CGMA 35</b>
cable earthing adapter 16 mm <sup>2</sup> (AWG 6-5)		<b>CGT 16</b>

silver plated

MIXO INSERTS

<sup>1)</sup> on request, version with pole 3/4 numbering, references: **CX 02 GFN, CX 02 GMN**

- characteristics according to EN 61984:

**100A 1000V 8kV 3**  
**100A 920/1600V 8kV 2**

- cULus (UL for USA and Canada),

- ENEC certified
- rated voltage according to UL/CSA: 600V
- insulation resistance:  $\geq 10 \text{ G}\Omega$
- ambient temperature limit:  $-40 \text{ }^\circ\text{C} \dots +125 \text{ }^\circ\text{C}$
- made of self-extinguishing thermoplastic resin UL 94V-0
- mechanical life:  $\geq 500$  cycles
- contact resistance:  $\leq 0,3 \text{ m}\Omega$

- it is recommended to crimp the contacts with crimping tools homologated by ILME (please see the crimping tool section 100A contacts, CGF and CGM series) on pages 708 - 741

- for max. current load see the connector inserts derating diagram below; for more information see page 28

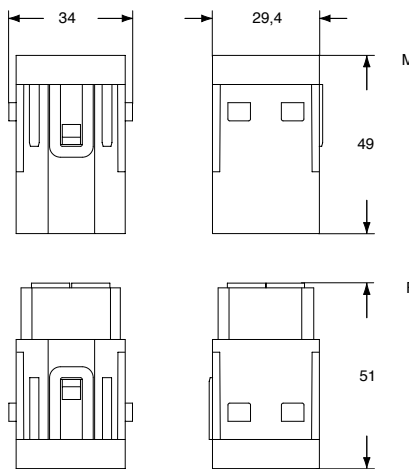

contacts side (front view)

side with reference arrow ▲

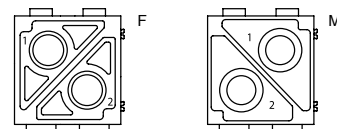

- 2 frame slots

CGF and CGM

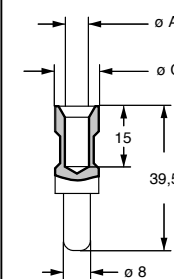

CGT 16

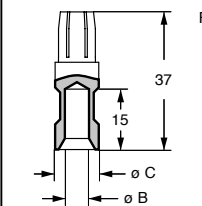
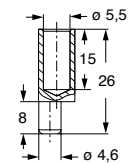

CGF and CGM contacts

conductor section (mm <sup>2</sup> )	conductor slot (mm)	conductor (mm)	conductor (mm)	conductor stripping length (mm)
	ø A	ø B	ø C	
8-10	4,3	4,3	13	15
16	5,5	5,5	13	15
25	7,0	7,0	13	15
35	7,9	8,2	12,5	15

How to use the PE adapter (CGT 16):

- 1) Strip 15 mm of flexible PE protective cable
- 2) Crimp the cable on the CGT 16 adapter by using the CGPZ pliers with the CGD 16 C matrix
- 3) Fix the adapter tip in the larger earth terminal (6 mm<sup>2</sup>) of frames CX...TM/TF
- 4) To be used with bulkhead mounting housings or high construction hoods
- 5) Cannot be used with T-TYPE series

CX 02 G, 2 poles connector inserts  
Maximum current load derating diagram

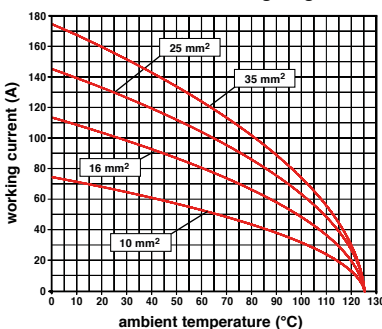

# CX 02 7F/7M 2 poles 70A - 1000V

The modular inserts must be installed in suitable frames which are then mounted in traditional enclosures\* or in COB panel support.

Single-sized modular units may be directly mounted inside MIXO ONE enclosures.

frames for modular units\* page: 317

MIXO ONE enclosures 369

\* enclosures: bulkhead mounting housings, high construction housings or high construction hoods

## modular units, crimp connections



## 70A silver plated crimp contacts



description	part No.	part No
-------------	----------	---------

without contacts (to be ordered separately)

female inserts for female contacts

**CX 02 7F**

male inserts for male contacts

**CX 02 7M**

70A female crimp contacts

10 mm <sup>2</sup>	AWG 8 - 7
16 mm <sup>2</sup>	AWG 6 - 5
25 mm <sup>2</sup>	AWG 4 - 3

**CX7FA 10**  
**CX7FA 16**  
**CX7FA 25**

70A male crimp contacts

10 mm <sup>2</sup>	AWG 8 - 7
16 mm <sup>2</sup>	AWG 6 - 5
25 mm <sup>2</sup>	AWG 4 - 3

**CX7MA 10**  
**CX7MA 16**  
**CX7MA 25**

silver plated

MIXO INSERTS

- characteristics according to EN 61984:

**70A 1000V 8kV 3**  
**70A 1600V 12kV 2**

- cULus (UL for USA and Canada),

- certified

- rated voltage according to UL/CSA: 600V

- insulation resistance:  $\geq 10$  G $\Omega$

- ambient temperature limit: -40 °C ... +125 °C

- made of self-extinguishing thermoplastic resin  
UL 94V-0

- mechanical life:  $\geq 500$  cycles

- contact resistance:  $\leq 0,5$  m $\Omega$

- **it is recommended to crimp the contacts with crimping tools homologated by ILME** (please see the crimping tool section 70A contacts, CX7F and CX7M series) on pages 708 - 741

- C7ES removal tool

- for max. current load see the connector inserts derating diagram below; for more information see page 28

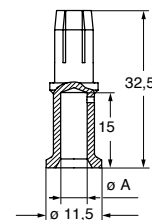
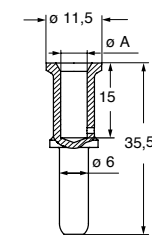
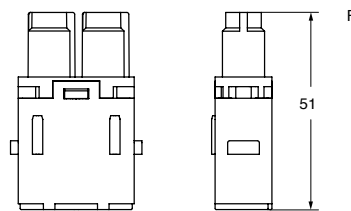
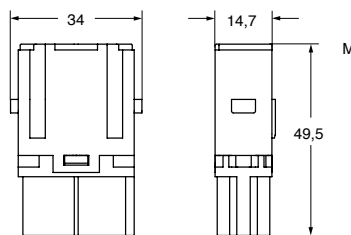

contacts side (front view)

side with reference arrow ▲

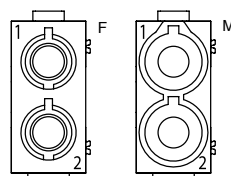

- 1 frame slot

**CX 02 7, 2 poles connector inserts**  
**Maximum current load derating diagram**

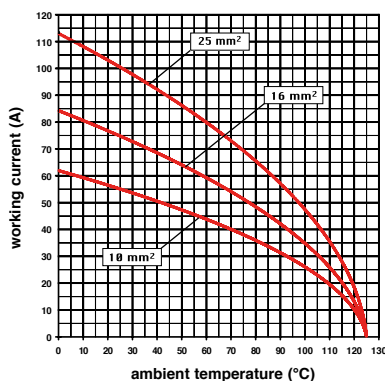

**CX7F and CX7M contacts**

conductor section (mm <sup>2</sup> )	conductor slot $\phi$ A (mm)	conductor stripping length (mm)
10	4,3	15
16	5,5	15
25	7,0	15

# CX 02 4F/4M 2 poles 40A - 1000V

The modular inserts must be installed in suitable frames which are then mounted in traditional enclosures\* or in COB panel support.  
Single-sized modular units may be directly mounted inside MIXO ONE enclosures.

frames for modular units\* page: 316 - 317

MIXO ONE enclosures 369

\* enclosures: bulkhead mounting housings, high construction housings or high construction hoods

## modular units, crimp connections



## 40A silver plated crimp contacts



description	part No.	part No
-------------	----------	---------

without contacts (to be ordered separately)  
female inserts for female contacts 1)  
male inserts for male contacts 1)

**CX 02 4F**  
**CX 02 4M**

40A female crimp contacts  
1,5 mm<sup>2</sup> AWG 16  
2,5 mm<sup>2</sup> AWG 14  
4 mm<sup>2</sup> AWG 12  
6 mm<sup>2</sup> AWG 10  
10 mm<sup>2</sup> AWG 8

**CXFA 1.5**  
**CXFA 2.5**  
**CXFA 4.0**  
**CXFA 6.0**  
**CXFA 10**

silver plated

40A male crimp contacts  
1,5 mm<sup>2</sup> AWG 16  
2,5 mm<sup>2</sup> AWG 14  
4 mm<sup>2</sup> AWG 12  
6 mm<sup>2</sup> AWG 10  
10 mm<sup>2</sup> AWG 8

**CXMA 1.5**  
**CXMA 2.5**  
**CXMA 4.0**  
**CXMA 6.0**  
**CXMA 10**

1) cable diameter up to 7,5 mm  
contact size up to 10 mm<sup>2</sup>

- characteristics according to EN 61984:

**40A 1000V 8kV 3**

- certified
- rated voltage according to UL/CSA: 600V
- insulation resistance: ≥ 10 GΩ
- ambient temperature limit: -40 °C ... +125 °C
- made of self-extinguishing thermoplastic resin UL 94V-0
- mechanical life: ≥ 500 cycles
- contact resistance: ≤ 0,3 mΩ
- can be mated with CX 02 4A/4B modules
- **it is recommended to crimp the contacts** (1,5 - 10 mm<sup>2</sup>), **with crimping tools homologated by ILME** (please see the crimping tool section 40A contacts, CXF and CXM series) on pages 708 - 741
- for max. current load see the connector inserts derating diagram below; for more information see page 28

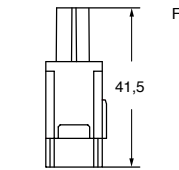
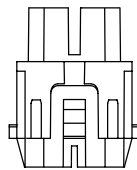
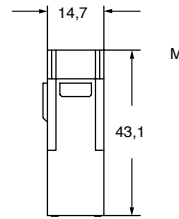
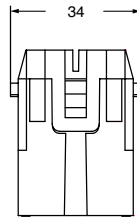

contacts side (front view)

side with reference arrow ▲

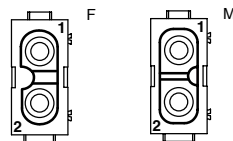

- 1 frame slot

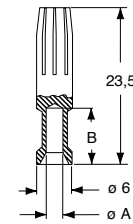
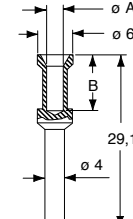

### CXF and CXM contacts

conductor section (mm <sup>2</sup> )	conductor slot ø A (mm)	conductor stripping length B (mm)
1,5	1,8	9
2,5	2,2	9
4	2,85	9,6
6	3,5	9,6
10	4,3	15

**CX 02 4, 2 poles connector inserts**  
**Maximum current load derating diagram**

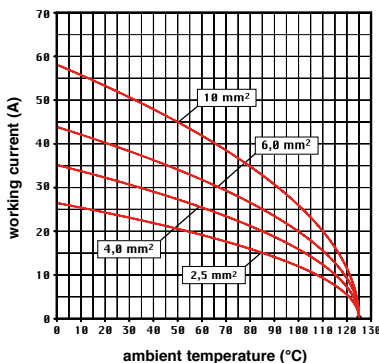

**CX 02 4AF/4AM - CX 02 4BF/4BM 2 poles 40A - 1000V**

The modular inserts must be installed in suitable frames which are then mounted in traditional enclosures or in COB panel support.  
Single-sized modular units may be directly mounted inside MIXO ONE enclosures.

frames for modular units page:  
316 - 317

MIXO ONE enclosures 369

modular units,  
screw terminal connection  
2,5 - 8 mm<sup>2</sup>

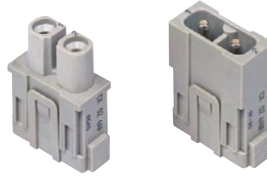

modular units,  
screw terminal connection  
6 - 10 mm<sup>2</sup>

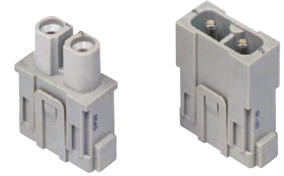

description	part No.	part No
-------------	----------	---------

female inserts with female contacts **CX 02 4AF**  
male inserts with male contacts **CX 02 4AM**

female inserts with female contacts **CX 02 4BF**  
male inserts with male contacts **CX 02 4BM**

- use flexible cables with sections from 2,5 to 10 mm<sup>2</sup> or extra flexible cables with sections from 2,5 to 6 mm<sup>2</sup>
- do not twist the cables
- fully insert the braids in the rear section of the contact

conductor section (mm <sup>2</sup> )	conductor stripping length (mm)	tightening torque (Nm)
2,5	5+1	1,5
4	5+1	1,5
6	8+1	2
10	8+1	2

- insert a 2 mm hexagonal key in the front section of the contact and tighten by keeping the cable held down in position
- a 2 mm hexagonal key can be supplied on request, reference **CX AS**



- characteristics according to EN 61984:  
**40A 1000V 8kV 3**  
**40A 1600V 12kV 2**
- certified
- rated voltage according to UL/CSA: 600V
- insulation resistance: ≥ 10 GΩ
- ambient temperature limit: -40 °C ... +125 °C
- made of self-extinguishing thermoplastic resin UL 94V-0
- mechanical life: ≥ 500 cycles
- contact resistance: ≤ 0,5 mΩ
- for max. current load see the connector inserts derating diagram below; for more information see page 28

**CX 02 4A/B, 2 poles connector inserts**  
**Maximum current load derating diagram**

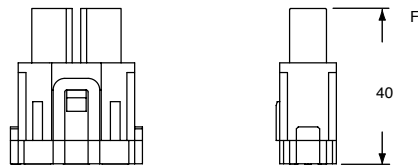
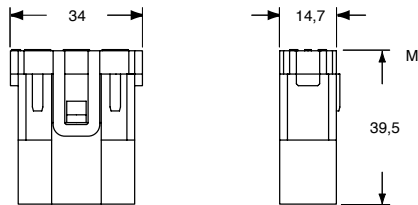
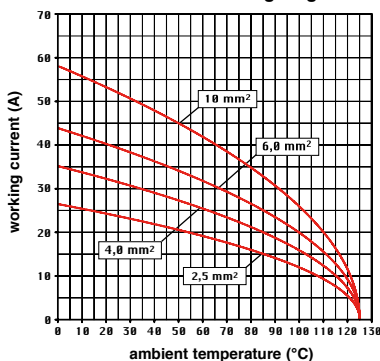

contacts side (front view)

side with reference arrow ▲

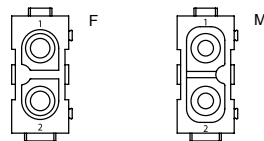

- inserts for Ø 4mm cables, section: 2,5-8 mm<sup>2</sup> - AWG 14-8
- 1 frame slot

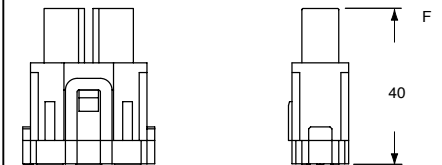
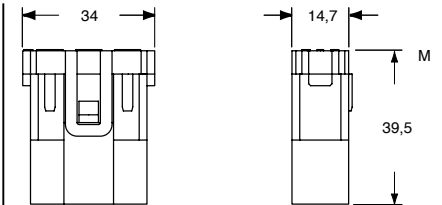

contacts side (front view)

side with reference arrow ▲

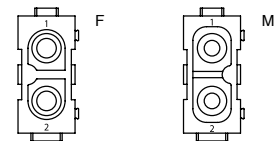

- inserts for Ø 4.8 mm cables, section: 6-10 mm<sup>2</sup> - AWG 10-8
- 1 frame slot

MIXO INSERTS



# CX 03 4F/4M 3 poles 40A - 400/690V

The modular inserts must be installed in suitable frames which are then mounted in traditional enclosures or in COB panel support.  
Single-sized modular units may be directly mounted inside MIXO ONE enclosures.

frames for modular units page:  
316 - 317

MIXO ONE enclosures 369

## modular units, crimp connections

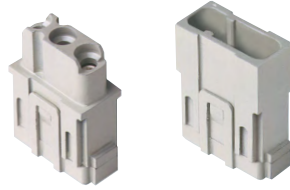

## 40A silver plated crimp contacts



description	part No.	part No
-------------	----------	---------

without contacts (to be ordered separately)		
female inserts for female contacts <sup>1)</sup>	<b>CX 03 4F</b>	
male inserts for male contacts <sup>1)</sup>	<b>CX 03 4M</b>	

40A female crimp contacts  
 1,5 mm<sup>2</sup> AWG 16  
 2,5 mm<sup>2</sup> AWG 14  
 4 mm<sup>2</sup> AWG 12  
 6 mm<sup>2</sup> AWG 10

**CXFA 1.5**  
**CXFA 2.5**  
**CXFA 4.0**  
**CXFA 6.0**

silver plated

40A male crimp contacts  
 1,5 mm<sup>2</sup> AWG 16  
 2,5 mm<sup>2</sup> AWG 14  
 4 mm<sup>2</sup> AWG 12  
 6 mm<sup>2</sup> AWG 10

**CXMA 1.5**  
**CXMA 2.5**  
**CXMA 4.0**  
**CXMA 6.0**

<sup>1)</sup> cable diameter up to 5 mm

- characteristics according to EN 61984:  
**40A 400/690V 6kV 3**
- certified
- rated voltage according to UL/CSA: 600V
- insulation resistance: ≥ 10 GΩ
- ambient temperature limit: -40 °C ... +125 °C
- made of self-extinguishing thermoplastic resin UL 94V-0
- mechanical life: ≥ 500 cycles
- contact resistance: ≤ 0,3 mΩ
- **it is recommended to crimp the contacts with crimping tools homologated by ILME** (please see the crimping tool section 40A contacts, CXF and CXM series) on pages 708 - 741
- for max. current load see the connector inserts derating diagram below; for more information see page 28

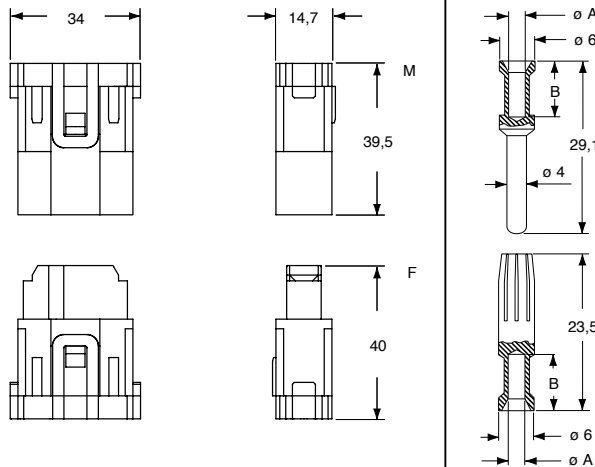

**CX 03 4, 3 poles connector inserts**  
**Maximum current load derating diagram**

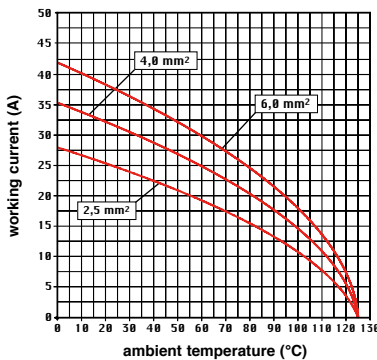

contacts side (front view)

side with reference arrow ▲

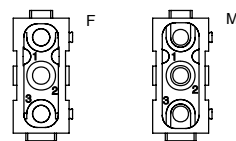

- 1 frame slot

**CXF and CXM contacts**

conductor section (mm <sup>2</sup> )	conductor slot ø A (mm)	conductor stripping length B (mm)
1,5	1,8	9
2,5	2,2	9
4	2,85	9,6
6	3,5	9,6



**CX 03 4BF/4BM 3 poles 40A - 500V**

The modular inserts must be installed in suitable frames which are then mounted in traditional enclosures\* or in COB panel support.  
Single-sized modular units may be directly mounted inside MIXO ONE enclosures.

frames for modular units\* page: 316 - 317

MIXO ONE enclosures 369

\* enclosures: bulkhead mounting housings, high construction housings or high construction hoods

modular units, crimp connections

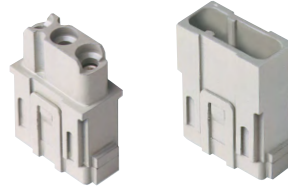

40A silver plated crimp contacts



description	part No.	part No
-------------	----------	---------

without contacts (to be ordered separately)  
female inserts for female contacts <sup>1)</sup>  
male inserts for male contacts <sup>1)</sup>

**CX 03 4BF**  
**CX 03 4BM**

40A female crimp contacts  
1,5 mm<sup>2</sup> AWG 16  
2,5 mm<sup>2</sup> AWG 14  
4 mm<sup>2</sup> AWG 12  
6 mm<sup>2</sup> AWG 10  
10 mm<sup>2</sup> AWG 8

**CXFA 1.5**  
**CXFA 2.5**  
**CXFA 4.0**  
**CXFA 6.0**  
**CXFA 10**

silver plated

40A male crimp contacts  
1,5 mm<sup>2</sup> AWG 16  
2,5 mm<sup>2</sup> AWG 14  
4 mm<sup>2</sup> AWG 12  
6 mm<sup>2</sup> AWG 10  
10 mm<sup>2</sup> AWG 8

**CXMA 1.5**  
**CXMA 2.5**  
**CXMA 4.0**  
**CXMA 6.0**  
**CXMA 10**

MIXO INSERTS

<sup>1)</sup> cable diameter up to 7,5 mm  
contact size up to 10 mm<sup>2</sup>

- characteristics according to EN 61984:  
**40A 500V 6kV 3**
- (UL for USA and Canada),
- certified
- rated voltage according to UL/CSA: 600V
- insulation resistance: ≥ 10 GΩ
- ambient temperature limit: -40 °C ... +125 °C
- made of self-extinguishing thermoplastic resin UL 94V-0
- mechanical life: ≥ 500 cycles
- contact resistance: ≤ 0,3 mΩ
- **it is recommended to crimp the contacts** (1,5 - 10 mm<sup>2</sup>), **with crimping tools homologated by ILME** (please see the crimping tool section 40A contacts, CXF and CXM series) on pages 708 - 741
- for max. current load see the connector inserts derating diagram below; for more information see page 28

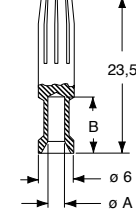
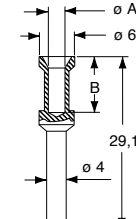
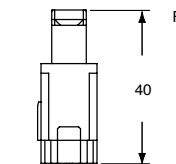
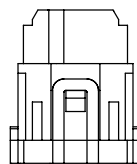
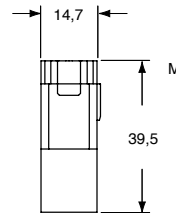
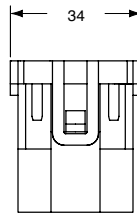

contacts side (front view)

side with reference arrow ▲

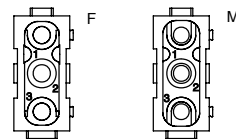

- 1 frame slot

**CXF and CXM contacts**

conductor section (mm <sup>2</sup> )	conductor slot ø A (mm)	conductor stripping length B (mm)
1,5	1,8	9
2,5	2,2	9
4	2,85	9,6
6	3,5	9,6
10	4,3	15

**CX 03 4B, 3 poles connector inserts**  
**Maximum current load derating diagram**

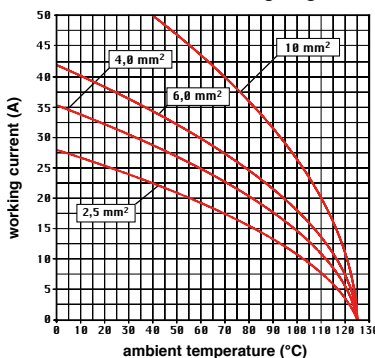

# CX 3/4 XDF/XDM 3 poles (40A - 830V) + 4 poles (10A - 830V)

The modular inserts must be installed in suitable frames which are then mounted in traditional enclosures or in COB panel support. Single-sized modular units may be directly mounted inside MIXO ONE enclosures.

page:  
frames for modular units 316 - 317  
MIXO ONE enclosures 369

- male and female contacts finger proof  
- their key characteristic lies in the fact that they guarantee maximum safety even in case of accidental contact with fingers (IP2X or IPXXB). Safety is guaranteed as standard on female contacts, but also on male contacts. This feature is important as it ensures full compliance with the recent safety standard EN 60204-1, concerning electric equipment fitted on machines and in particular with the requirements of Article 6.2.4 concerning protection against residual voltage. **In the case of plugs or similar devices, the withdrawal of which results in the exposure of conductors (for example pins), the discharge time shall not exceed 1 s, otherwise such conductors shall be protected against direct contact to at least an IP2X or IPXXB.**

## modular units, crimp connections



## 40A and 10A crimp contacts silver and gold plated



description	part No.	part No
-------------	----------	---------

without contacts (to be ordered separately)  
female inserts for female contacts  
male inserts for male contacts

CX 3/4 XDF  
CX 3/4 XDM

<b>40A female crimp contacts</b>		
1,5 mm <sup>2</sup>	AWG 16	
2,5 mm <sup>2</sup>	AWG 14	
4 mm <sup>2</sup>	AWG 12	
6 mm <sup>2</sup>	AWG 10	
<b>40A male crimp contacts</b>		
1,5 mm <sup>2</sup>	AWG 16	
2,5 mm <sup>2</sup>	AWG 14	
4 mm <sup>2</sup>	AWG 12	
6 mm <sup>2</sup>	AWG 10	
<b>10A female crimp contacts</b>		
0,14-0,37 mm <sup>2</sup>	AWG 26-22	identification No. 1
0,5 mm <sup>2</sup>	AWG 20	identification No. 2
0,75 mm <sup>2</sup>	AWG 18	identification No. ②
1 mm <sup>2</sup>	AWG 18	identification No. 3
1,5 mm <sup>2</sup>	AWG 16	identification No. 4
2,5 mm <sup>2</sup>	AWG 14	identification No. 5
<b>10A male crimp contacts</b>		
0,14-0,37 mm <sup>2</sup>	AWG 26-22	identification No. 1
0,5 mm <sup>2</sup>	AWG 20	identification No. 2
0,75 mm <sup>2</sup>	AWG 18	identification No. ②
1 mm <sup>2</sup>	AWG 18	identification No. 3
1,5 mm <sup>2</sup>	AWG 16	identification No. 4
2,5 mm <sup>2</sup>	AWG 14	identification No. 5

CXFA 1.5  
CXFA 2.5  
CXFA 4.0  
CXFA 6.0

silver plated

CXMA 1.5  
CXMA 2.5  
CXMA 4.0  
CXMA 6.0

\* for basic or high thickness gold plating, please refer to page 674

CDFA 0.3  
CDFA 0.5  
CDFA 0.7  
CDFA 1.0  
CDFA 1.5  
CDFA 2.5

CDFD 0.3  
CDFD 0.5  
CDFD 0.7  
CDFD 1.0  
CDFD 1.5  
CDFD 2.5

gold plated+

CDMA 0.3  
CDMA 0.5  
CDMA 0.7  
CDMA 1.0  
CDMA 1.5  
CDMA 2.5

CDMD 0.3  
CDMD 0.5  
CDMD 0.7  
CDMD 1.0  
CDMD 1.5  
CDMD 2.5

- characteristics according to EN 61984:
- 3 poles 40A 830V 8kV 3**
- 4 poles 10A 830V 8kV 3**
- cULus (UL for USA and Canada),
- certified
- rated voltage according to UL/CSA: 600V
- insulation resistance: ≥ 10 GΩ
- ambient temperature limit: -40 °C ... +125 °C
- made of self-extinguishing thermoplastic resin UL 94V-0
- mechanical life: ≥ 500 cycles
- contact resistance: ≤ 0,3 mΩ (3 poles), ≤ 3 mΩ (4 poles)
- for max. current load see the connector inserts derating diagram below; for more information see page 28

CX 3/4 XD, 3/4 poles connector inserts  
Maximum current load derating diagram

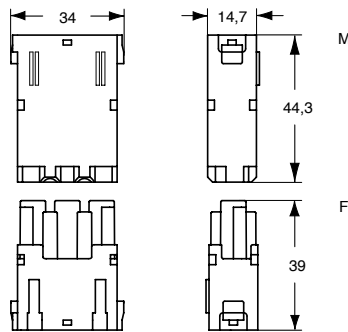
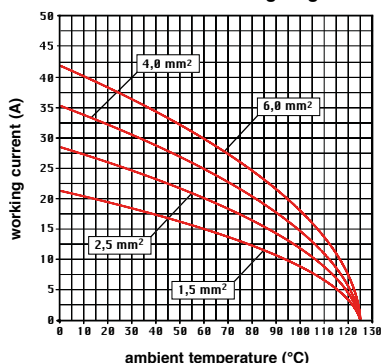

contacts side (front view)

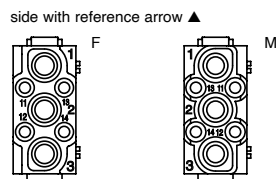

- 1 frame slot

- it is recommended to crimp the contacts with crimping tools homologated by ILME (please see the crimping tool section 40A contacts, CXF, CXM series and 10A contacts CDF, CDM series) on pages 708 - 741

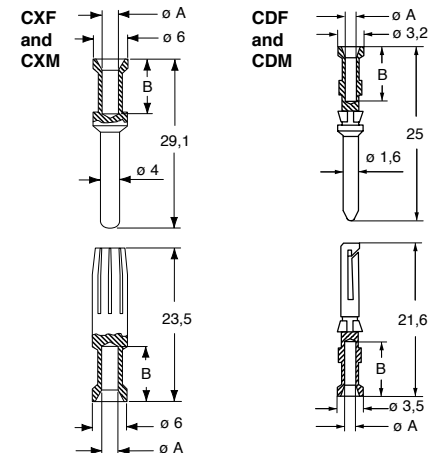

CXF and CXM contacts		
conductor section (mm <sup>2</sup> )	conductor slot (mm)	conductor stripping length B (mm)
1,5	1,8	9
2,5	2,2	9
4	2,85	9,6
6	3,5	9,6
CDF and CDM contacts		
0,14-0,37	0,9	8
0,5	1,1	8
0,75	1,3	8
1,0	1,45	8
1,5	1,8	8
2,5	2,2	6

MIXO INSERTS

## MIXO modular units

# CX 04 XF/XM 4 poles 40A - 830V

The modular inserts must be installed in suitable frames which are then mounted in traditional enclosures\* or in COB panel support.

Single-sized modular units may be directly mounted inside MIXO ONE enclosures.

frames for modular units\* page:  
316 - 317

MIXO ONE enclosures 369

\* enclosures: bulkhead mounting housings, high construction housings or high construction hoods

modular units, crimp connections with red lock-in tab (included)



40A silver plated crimp contacts



description	part No.	part No
-------------	----------	---------

without contacts (to be ordered separately)  
(module red lock-in tab included)  
female inserts for female contacts  
male inserts for male contacts

**CX 04 XF**  
**CX 04 XM**

40A female crimp contacts  
1,5 mm<sup>2</sup> AWG 16  
2,5 mm<sup>2</sup> AWG 14  
4 mm<sup>2</sup> AWG 12  
6 mm<sup>2</sup> AWG 10

**CXFA 1.5**  
**CXFA 2.5**  
**CXFA 4.0**  
**CXFA 6.0**

40A male crimp contacts  
1,5 mm<sup>2</sup> AWG 16  
2,5 mm<sup>2</sup> AWG 14  
4 mm<sup>2</sup> AWG 12  
6 mm<sup>2</sup> AWG 10

**CXMA 1.5**  
**CXMA 2.5**  
**CXMA 4.0**  
**CXMA 6.0**

silver plated

MIXO INSERTS

- characteristics according to EN 61984:  
**40A 830V 8kV 3**  
**40A 1000V 8kV 2**
- (UL for USA and Canada),
- certified
- rated voltage according to UL/CSA: 600V
- insulation resistance:  $\geq 10 \text{ G}\Omega$
- ambient temperature limit:  $-40 \text{ }^\circ\text{C} \dots +125 \text{ }^\circ\text{C}$
- made of self-extinguishing thermoplastic resin UL 94V-0
- mechanical life:  $\geq 500$  cycles
- contact resistance:  $\leq 0,3 \text{ m}\Omega$
- for spare lock-in tab **CX CFMX** see SPARE SPARTS catalogue
- **it is recommended to crimp the contacts with crimping tools homologated by ILME** (please see the crimping tool section 40A contacts, CXF and CXM series) on pages 708 - 741
- for max. current load see the connector inserts derating diagram below; for more information see page 28

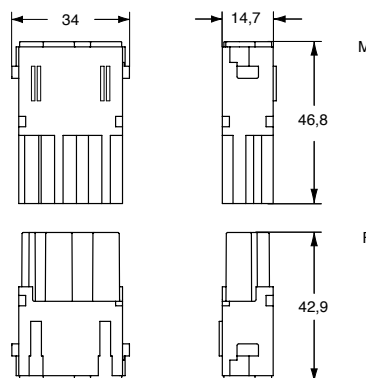

contacts side (front view)  
side with reference arrow ▲

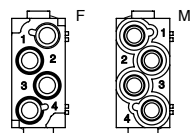

- 1 frame slot

Female inserts are supplied with two red lock tab that must be used instead of those supplied with the frames.

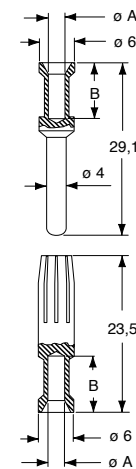
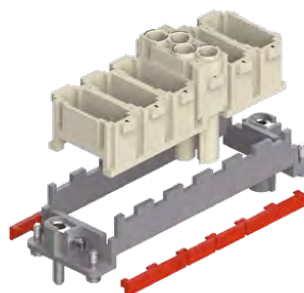

**CXF and CXM contacts**

conductor section (mm <sup>2</sup> )	conductor ø A (mm)	conductor stripping length B (mm)
1,5	1,8	9
2,5	2,2	9
4	2,85	9,6
6	3,5	9,6

- male and female contacts finger proof
- their key characteristic **lies in the fact that they guarantee maximum safety even in case of accidental contact with fingers (IP2X or IPXXB)**. Safety is guaranteed as standard on female contacts, but also on male contacts. This feature is important as it ensures full compliance with the recent safety standard **EN 60204-1**, concerning electric equipment fitted on machines and in particular with the requirements of Article 6.2.4 concerning protection against residual voltage. **In the case of plugs or similar devices, the withdrawal of which results in the exposure of conductors (for example pins), the discharge time shall not exceed 1 s, otherwise such conductors shall be protected against direct contact to at least an IP2X or IPXXB.**

**CX 04 X, 4 poles connector inserts**  
**Maximum current load derating diagram**

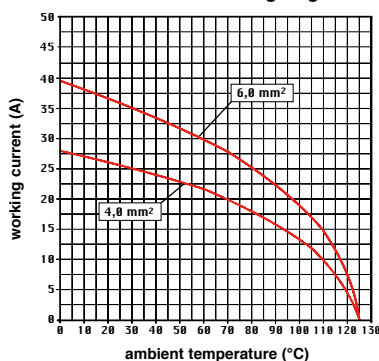

## CX 05 SHF/SHM

### MIXO - SQUICH®

**SQUICH®** technology has now been applied to the ILME MIXO series of modular connectors. Main aim is to make wiring an installation easier and safer on every possible connector.

On this purpose, the new MIXO SQUICH® 5 poles is the improved version of the CX 05 SF/SM spring clamp module:

- **consistently reduced wiring time**, as the actuator buttons are supplied lifted, in “open terminal” position, so that the stripped wires can be directly inserted;
- **operator skill independence**: thanks to the SQUICH® proprietary technology a simple pressure on the top of the actuator button triggers the locking of the conductor in the terminal, avoiding the need of a specific screwdriver and the relevant skill in its correct choice and application;
- **great resistance to strong vibrations** inherent to self-compensating spring-clamp technology;
- **no special wire preparation** (only stripping at the correct length);
- it allows the **use of both rigid and flexible** copper conductors, with a range of cross-sectional area between 0,14 mm<sup>2</sup> and 2,5 mm<sup>2</sup> (26 AWG to 14 AWG);
- for conductors prepared with **crimped ferrules**, the maximum cross-sectional area is 1,5 mm<sup>2</sup>;
- possibility to insert the **test probe** of a measurement instrument in the dedicated cavity on the actuator button (proprietary design);
- **silver plated** contacts;
- simple re-opening of a terminal (if needed) using a 0,5 x 3 mm flat blade screwdriver on the actuator button dedicated side window (on terminal #3 use the same screwdriver under any of the two lateral projections of the actuator button head; after removing the wire from the relevant terminal #1 or #4).

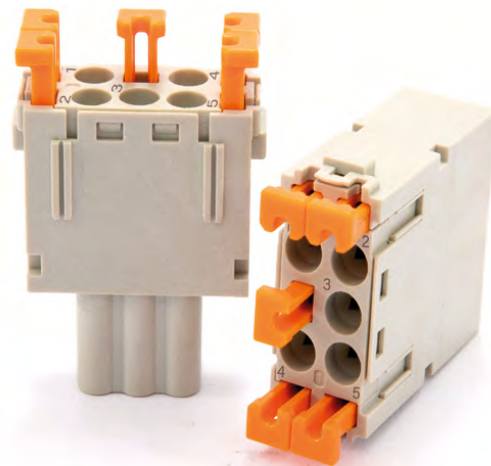

Watch  
our  
**SQUICH®**  
video

The modular inserts must be installed in suitable frames which are then mounted in traditional enclosures or in COB panel support.  
Single-sized modular units may be directly mounted inside MIXO ONE enclosures.

frames for modular units page: 316  
MIXO ONE enclosures 369

Suitable for every conductor type (prepared with ferrule, unprepared and solid) up to cross-sectional area 2,5 mm<sup>2</sup>

modular units,  
SQUICH®-spring terminal connection

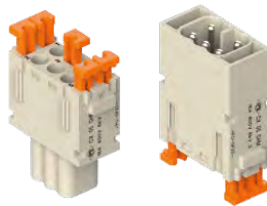

description

part No.

spring terminals with actuator button  
female inserts with female contacts  
male inserts with male contacts

**CX 05 SHF**  
**CX 05 SHM**

- characteristics according to EN 61984:  
**16A 400V 6kV 3**  
**16A 500V 6kV 2**
- cURus, CSA, CQC, DNV-GL, BV, EAC pending
- rated voltage according to UL/CSA: 600V
- insulation resistance: ≥ 10 GΩ
- ambient temperature limit: -40 °C ... +125 °C
- made of self-extinguishing thermoplastic resin UL 94V-0
- mechanical life: ≥ 500 cycles
- contact resistance: ≤ 3 mΩ
- for max. current load see the connector inserts derating diagram below; for more information see page 28

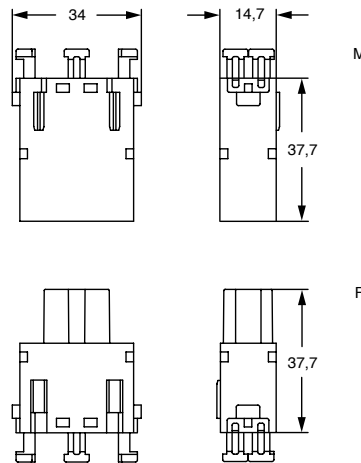

contacts side (front view)

rear view, side with reference arrow ▲

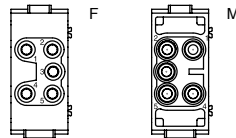

- 1 frame slot

- inserts for cables with the following cross-sectional area: 0,14 - 2,5 mm<sup>2</sup> - AWG 26 - 14
- conductors stripping length: 9...11 mm

**CX 05 SH, 5 power poles connector inserts**  
**Maximum current load derating diagram**

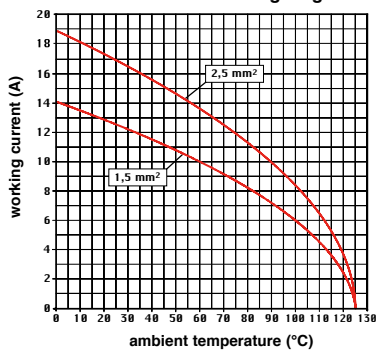

**MIXO CX 05 SHF/M**  
**SQUICH®-spring connection technology**

**WIRING**

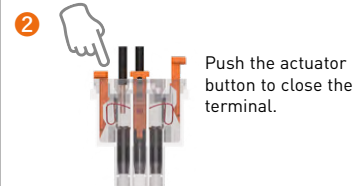
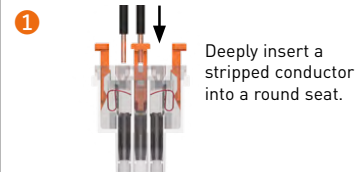

**RE-OPENING**

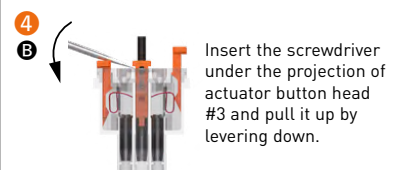
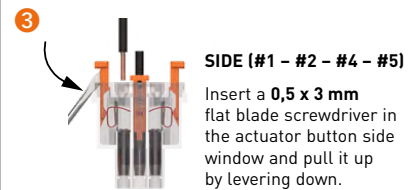

MIXO INSERTS

# CX 06 CF/CM 6 poles 16A - 500V

The modular inserts must be installed in suitable frames which are then mounted in traditional enclosures or in COB panel support.

Single-sized modular units may be directly mounted inside MIXO ONE enclosures.

frames for modular units page:  
316 - 317

MIXO ONE enclosures 369

- it is recommended to crimp the contacts with crimping tools homologated by ILME (please see the crimping tool section 16A contacts, CCF, CCM and CC...AN series) on pages 708 - 741

## modular units, crimp connections

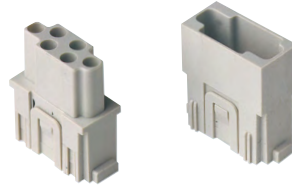

## 16A crimp contacts standard or for advanced opening silver and gold plated

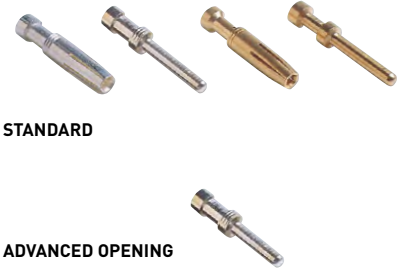

STANDARD

ADVANCED OPENING

description	part No.	part No
-------------	----------	---------

without contacts (to be ordered separately)  
female inserts for female contacts  
male inserts for male contacts

**CX 06 CF**  
**CX 06 CM**

16A female crimp contacts		
0,14-0,37 mm <sup>2</sup>	AWG 26-22	one groove
0,5 mm <sup>2</sup>	AWG 20	with no grooves
0,75 mm <sup>2</sup>	AWG 18	one groove (back side)
1 mm <sup>2</sup>	AWG 18	one groove
1,5 mm <sup>2</sup>	AWG 16	two grooves
2,5 mm <sup>2</sup>	AWG 14	three grooves
3 mm <sup>2</sup>	AWG 12	one wide groove
4 mm <sup>2</sup>	AWG 12	with no grooves

16A male crimp contacts		
0,14-0,37 mm <sup>2</sup>	AWG 26-22	one groove
0,5 mm <sup>2</sup>	AWG 20	with no grooves
0,75 mm <sup>2</sup>	AWG 18	one groove (back side)
1 mm <sup>2</sup>	AWG 18	one groove
1,5 mm <sup>2</sup>	AWG 16	two grooves
2,5 mm <sup>2</sup>	AWG 14	three grooves
3 mm <sup>2</sup>	AWG 12	one wide groove
4 mm <sup>2</sup>	AWG 12	with no grooves

16A male crimp contacts for advanced opening		
0,5 mm <sup>2</sup>	AWG 20	with no grooves
0,75 mm <sup>2</sup>	AWG 18	one groove (back side)
1 mm <sup>2</sup>	AWG 18	one groove
1,5 mm <sup>2</sup>	AWG 16	two grooves
2,5 mm <sup>2</sup>	AWG 14	three grooves

silver plated	gold plated+
CCFA 0.3	CCFD 0.3
CCFA 0.5	CCFD 0.5
CCFA 0.7	CCFD 0.7
CCFA 1.0	CCFD 1.0
CCFA 1.5	CCFD 1.5
CCFA 2.5	CCFD 2.5
CCFA 3.0	CCFD 3.0
CCFA 4.0	CCFD 4.0

CCMA 0.3	CCMD 0.3
CCMA 0.5	CCMD 0.5
CCMA 0.7	CCMD 0.7
CCMA 1.0	CCMD 1.0
CCMA 1.5	CCMD 1.5
CCMA 2.5	CCMD 2.5
CCMA 3.0	CCMD 3.0
CCMA 4.0	CCMD 4.0

CC 0.5 AN
CC 0.7 AN
CC 1.0 AN
CC 1.5 AN
CC 2.5 AN

+ for basic or high thickness gold plating, please refer to page 675

- characteristics according to EN 61984:

**16A 500V 6kV 3**  
**16A 400/690V 6kV 2**

- certified

- rated voltage according to UL/CSA: 600V

- insulation resistance:  $\geq 10 \text{ G}\Omega$

- ambient temperature limit:  $-40 \text{ }^\circ\text{C} \dots +125 \text{ }^\circ\text{C}$

- made of self-extinguishing thermoplastic resin UL 94V-0

- mechanical life:  $\geq 500$  cycles

- contact resistance:  $\leq 1 \text{ m}\Omega$

- for max. current load see the connector inserts derating diagram below; for more information see page 28

**CX 06 C, 6 poles connector inserts**  
**Maximum current load derating diagram**

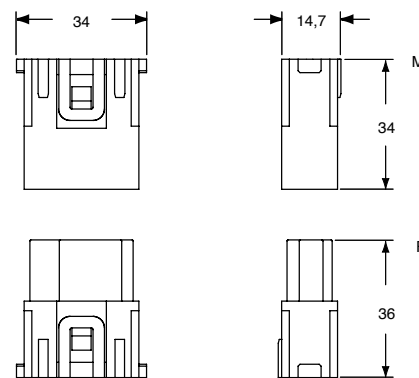
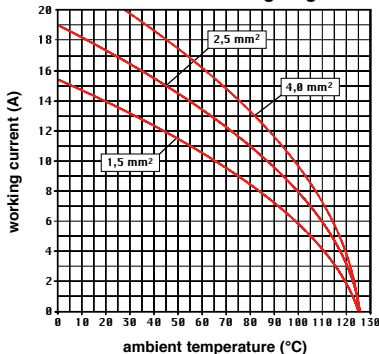

contacts side (front view)

side with reference arrow ▲

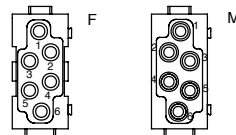

- 1 frame slot

**CCF and CCM**

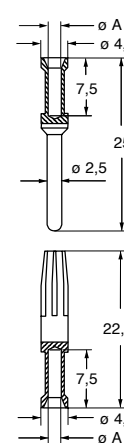

**CC...AN**

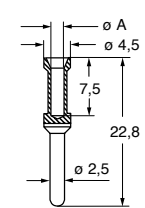

**CCF, CCM and CC...AN contacts**

conductor section (mm <sup>2</sup> )	conductor slot ø A (mm)	conductor stripping length (mm)
0,14-0,37	0,9	7,5
0,5	1,1	7,5
0,75	1,3	7,5
1,0	1,45	7,5
1,5	1,8	7,5
2,5	2,2	7,5
3	2,55	7,5
4	2,85	7,5



# CX 06P CF/CM 6 poles protected 16A - 830V

The modular inserts must be installed in suitable frames which are then mounted in traditional enclosures or in COB panel support.

Single-sized modular units may be directly mounted inside MIXO ONE enclosures.

frames for modular units page:  
316 - 317

MIXO ONE enclosures 369

- we recommend the use of CRF / CRM code pins together with relevant MIXO frame

- it is recommended to crimp the contacts with crimping tools homologated by ILME (please see the crimping tool section 16A contacts, CCF, CCM and CC...AN series) on pages 708 - 741

## modular units, crimp connections



**RATING 830V**

## 16A crimp contacts standard or for advanced opening silver and gold plated

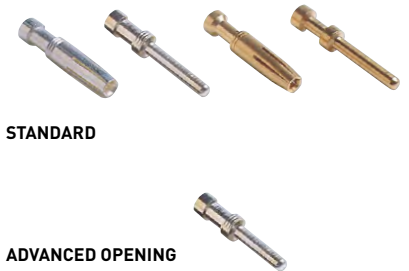

STANDARD

ADVANCED OPENING

description

part No.

part No.

without contacts (to be ordered separately)

female inserts for female contacts

male inserts for male contacts

**CX 06P CF**  
**CX 06P CM**

### 16A female contacts

0,14-0,37 mm <sup>2</sup>	AWG 26-22	one groove
0,5 mm <sup>2</sup>	AWG 20	with no grooves
0,75 mm <sup>2</sup>	AWG 18	one groove (back side)
1 mm <sup>2</sup>	AWG 18	one groove
1,5 mm <sup>2</sup>	AWG 16	two grooves
2,5 mm <sup>2</sup>	AWG 14	three grooves
3 mm <sup>2</sup>	AWG 12	one wide groove
4 mm <sup>2</sup>	AWG 12	with no grooves

### 16A male contacts

0,14-0,37 mm <sup>2</sup>	AWG 26-22	one groove
0,5 mm <sup>2</sup>	AWG 20	with no grooves
0,75 mm <sup>2</sup>	AWG 18	one groove (back side)
1 mm <sup>2</sup>	AWG 18	one groove
1,5 mm <sup>2</sup>	AWG 16	two grooves
2,5 mm <sup>2</sup>	AWG 14	three grooves
3 mm <sup>2</sup>	AWG 12	one wide groove
4 mm <sup>2</sup>	AWG 12	with no grooves

### 16A male crimp contacts for advanced opening

0,5 mm <sup>2</sup>	AWG 20	with no grooves
0,75 mm <sup>2</sup>	AWG 18	one groove (back side)
1 mm <sup>2</sup>	AWG 18	one groove
1,5 mm <sup>2</sup>	AWG 16	two grooves
2,5 mm <sup>2</sup>	AWG 14	three grooves

CCFA 0.3  
CCFA 0.5  
CCFA 0.7  
CCFA 1.0  
CCFA 1.5  
CCFA 2.5  
CCFA 3.0  
CCFA 4.0

silver plated

CCFD 0.3  
CCFD 0.5  
CCFD 0.7  
CCFD 1.0  
CCFD 1.5  
CCFD 2.5  
CCFD 3.0  
CCFD 4.0

gold plated<sup>+</sup>

CCMA 0.3  
CCMA 0.5  
CCMA 0.7  
CCMA 1.0  
CCMA 1.5  
CCMA 2.5  
CCMA 3.0  
CCMA 4.0

CCMD 0.3  
CCMD 0.5  
CCMD 0.7  
CCMD 1.0  
CCMD 1.5  
CCMD 2.5  
CCMD 3.0  
CCMD 4.0

CC 0.5 AN  
CC 0.7 AN  
CC 1.0 AN  
CC 1.5 AN  
CC 2.5 AN

+ for basic or high thickness gold plating, please refer to page 675

MIXO INSERTS

- characteristics according to EN 61984:

**16A 830V 8kV 3**

certified

- rated voltage according to UL/CSA: 600V

- insulation resistance: ≥ 10 GΩ

- ambient temperature limit: -40 °C ... +125 °C

- made of self-extinguishing thermoplastic resin UL 94V-0

- mechanical life: ≥ 500 cycles

- contact resistance: ≤ 1 mΩ

- for max. current load see the connector inserts derating diagram below; for more information see page 28

**CX 06P C, 6 poles connector inserts**  
**Maximum current load derating diagram**

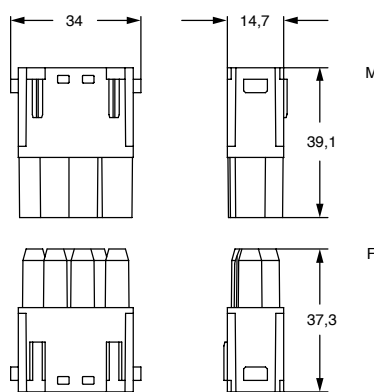
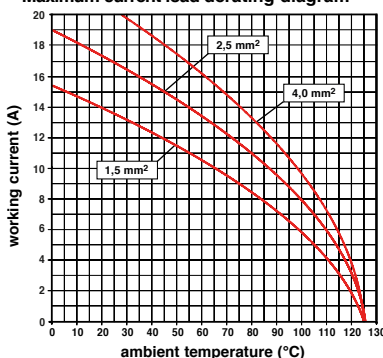

contacts side (front view)

side with reference arrow ▲

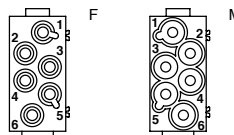

- 1 frame slot

### CCF and CCM

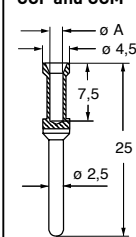

### CC...AN

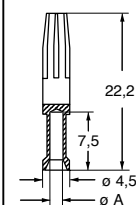
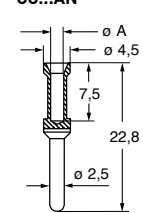

### CCF, CCM and CC...AN contacts

conductor section (mm <sup>2</sup> )	conductor slot ø A (mm)	conductors stripping length (mm)
0,14-0,37	0,9	7,5
0,5	1,1	7,5
0,75	1,3	7,5
1,0	1,45	7,5
1,5	1,8	7,5
2,5	2,2	7,5
3	2,55	7,5
4	2,85	7,5



# CX 08 CF/CM 8 poles 16A - 400V

The modular inserts must be installed in suitable frames which are then mounted in traditional enclosures or in COB panel support.

Single-sized modular units may be directly mounted inside MIXO ONE enclosures.

frames for modular units page: 316 - 317

MIXO ONE enclosures 369

- it is recommended to crimp the contacts with crimping tools homologated by ILME (please see the crimping tool section 16A contacts, CCF, CCM and CC...AN series) on pages 708 - 741

## modular units, crimp connections



## 16A crimp contacts standard or for advanced opening silver and gold plated

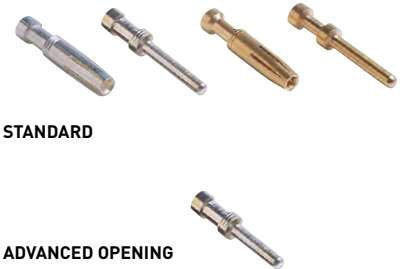

STANDARD

ADVANCED OPENING

description	part No.	part No
-------------	----------	---------

without contacts (to be ordered separately)		
female inserts for female contacts	<b>CX 08 CF</b>	
male inserts for male contacts	<b>CX 08 CM</b>	

16A female crimp contacts				
0,14-0,37 mm <sup>2</sup>	AWG 26-22	one groove	<b>CCFA 0.3</b>	<b>CCFD 0.3</b>
0,5 mm <sup>2</sup>	AWG 20	with no grooves	<b>CCFA 0.5</b>	<b>CCFD 0.5</b>
0,75 mm <sup>2</sup>	AWG 18	one groove (back side)	<b>CCFA 0.7</b>	<b>CCFD 0.7</b>
1 mm <sup>2</sup>	AWG 18	one groove	<b>CCFA 1.0</b>	<b>CCFD 1.0</b>
1,5 mm <sup>2</sup>	AWG 16	two grooves	<b>CCFA 1.5</b>	<b>CCFD 1.5</b>
2,5 mm <sup>2</sup>	AWG 14	three grooves	<b>CCFA 2.5</b>	<b>CCFD 2.5</b>
3 mm <sup>2</sup>	AWG 12	one wide groove	<b>CCFA 3.0</b>	<b>CCFD 3.0</b>
4 mm <sup>2</sup>	AWG 12	with no grooves	<b>CCFA 4.0</b>	<b>CCFD 4.0</b>
<b>16A male crimp contacts</b>				
0,14-0,37 mm <sup>2</sup>	AWG 26-22	one groove	<b>CCMA 0.3</b>	<b>CCMD 0.3</b>
0,5 mm <sup>2</sup>	AWG 20	with no grooves	<b>CCMA 0.5</b>	<b>CCMD 0.5</b>
0,75 mm <sup>2</sup>	AWG 18	one groove (back side)	<b>CCMA 0.7</b>	<b>CCMD 0.7</b>
1 mm <sup>2</sup>	AWG 18	one groove	<b>CCMA 1.0</b>	<b>CCMD 1.0</b>
1,5 mm <sup>2</sup>	AWG 16	two grooves	<b>CCMA 1.5</b>	<b>CCMD 1.5</b>
2,5 mm <sup>2</sup>	AWG 14	three grooves	<b>CCMA 2.5</b>	<b>CCMD 2.5</b>
3 mm <sup>2</sup>	AWG 12	one wide groove	<b>CCMA 3.0</b>	<b>CCMD 3.0</b>
4 mm <sup>2</sup>	AWG 12	with no grooves	<b>CCMA 4.0</b>	<b>CCMD 4.0</b>
<b>16A male crimp contacts for advanced opening</b>				
0,5 mm <sup>2</sup>	AWG 20	with no grooves	<b>CC 0.5 AN</b>	+ for basic or high thickness gold plating, please refer to page 675
0,75 mm <sup>2</sup>	AWG 18	one groove (back side)	<b>CC 0.7 AN</b>	
1 mm <sup>2</sup>	AWG 18	one groove	<b>CC 1.0 AN</b>	
1,5 mm <sup>2</sup>	AWG 16	two grooves	<b>CC 1.5 AN</b>	
2,5 mm <sup>2</sup>	AWG 14	three grooves	<b>CC 2.5 AN</b>	

- characteristics according to EN 61984:
- 16A 400V 6kV 3**
- 16A 400/690V 6kV 2**
- certified
- rated voltage according to UL/CSA: 600V
- insulation resistance: ≥ 10 GΩ
- ambient temperature limit: -40 °C ... +125 °C
- made of self-extinguishing thermoplastic resin UL 94V-0
- mechanical life: ≥ 500 cycles
- contact resistance: ≤ 1 mΩ
- for max. current load see the connector inserts derating diagram below; for more information see page 28

**CX 08 C, 8 poles connector inserts**  
Maximum current load derating diagram

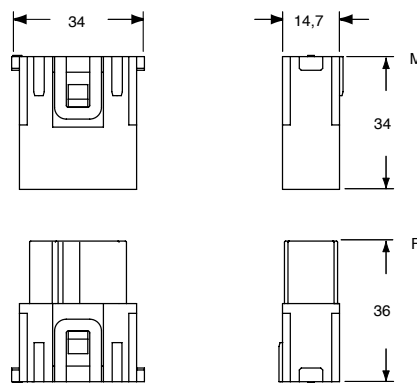
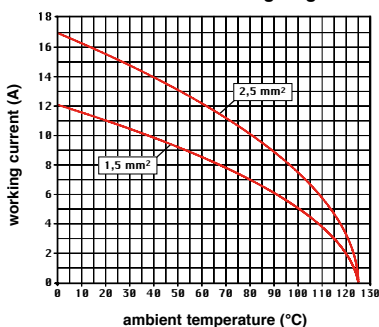

contacts side (front view)

side with reference arrow ▲

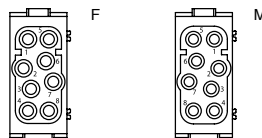

- 1 frame slot

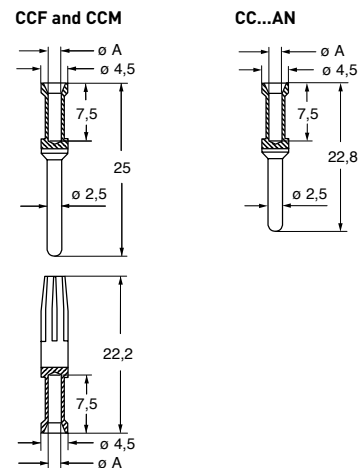

**CCF, CCM and CC...AN contacts**

conductor section (mm <sup>2</sup> )	conductor slot ø A (mm)	conductors stripping length (mm)
0,14-0,37	0,9	7,5
0,5	1,1	7,5
0,75	1,3	7,5
1,0	1,45	7,5
1,5	1,8	7,5
2,5	2,2	7,5
3	2,55	7,5
4	2,85	7,5

# CX 20 CF/CM 20 poles 16A - 500V

The modular inserts must be installed in suitable frames, which are then mounted in traditional enclosures or in COB panel supports.

frames for modular units page:  
316 - 317

- it is recommended to crimp the contacts with crimping tools homologated by ILME (please see the crimping tool section 16A contacts, CCF, CCM and CC...AN series) on pages 708 - 741

## modular units, crimp connections

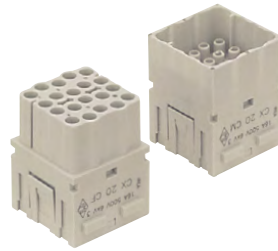

## 16A crimp contacts standard or for advanced opening silver and gold plated

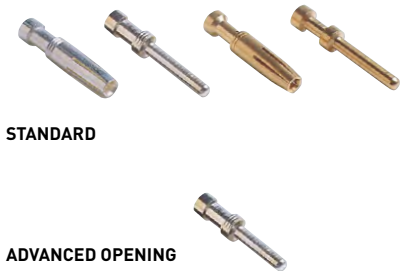

STANDARD

ADVANCED OPENING

description	part No.	part No.
-------------	----------	----------

without contacts (to be ordered separately)  
female inserts for female contacts <sup>1)</sup>  
male inserts for male contacts <sup>1)</sup>

**CX 20 CF**  
**CX 20 CM**

16A female crimp contacts		
0,14-0,37 mm <sup>2</sup>	AWG 26-22	one groove
0,5 mm <sup>2</sup>	AWG 20	with no grooves
0,75 mm <sup>2</sup>	AWG 18	one groove (back side)
1 mm <sup>2</sup>	AWG 18	one groove
1,5 mm <sup>2</sup>	AWG 16	two grooves
2,5 mm <sup>2</sup>	AWG 14	three grooves
3 mm <sup>2</sup>	AWG 12	one wide groove
4 mm <sup>2</sup>	AWG 12	with no grooves

CCFA 0.3  
CCFA 0.5  
CCFA 0.7  
CCFA 1.0  
CCFA 1.5  
CCFA 2.5  
CCFA 3.0  
CCFA 4.0

silver plated

CCFD 0.3  
CCFD 0.5  
CCFD 0.7  
CCFD 1.0  
CCFD 1.5  
CCFD 2.5  
CCFD 3.0  
CCFD 4.0

gold plated<sup>+</sup>

16A male crimp contacts		
0,14-0,37 mm <sup>2</sup>	AWG 26-22	one groove
0,5 mm <sup>2</sup>	AWG 20	with no grooves
0,75 mm <sup>2</sup>	AWG 18	one groove (back side)
1 mm <sup>2</sup>	AWG 18	one groove
1,5 mm <sup>2</sup>	AWG 16	two grooves
2,5 mm <sup>2</sup>	AWG 14	three grooves
3 mm <sup>2</sup>	AWG 12	one wide groove
4 mm <sup>2</sup>	AWG 12	with no grooves

CCMA 0.3  
CCMA 0.5  
CCMA 0.7  
CCMA 1.0  
CCMA 1.5  
CCMA 2.5  
CCMA 3.0  
CCMA 4.0

CCMD 0.3  
CCMD 0.5  
CCMD 0.7  
CCMD 1.0  
CCMD 1.5  
CCMD 2.5  
CCMD 3.0  
CCMD 4.0

16A male crimp contacts for advanced opening		
0,5 mm <sup>2</sup>	AWG 20	with no grooves
0,75 mm <sup>2</sup>	AWG 18	one groove (back side)
1 mm <sup>2</sup>	AWG 18	one groove
1,5 mm <sup>2</sup>	AWG 16	two grooves
2,5 mm <sup>2</sup>	AWG 14	three grooves

CC 0.5 AN  
CC 0.7 AN  
CC 1.0 AN  
CC 1.5 AN  
CC 2.5 AN

+ for basic or high thickness gold plating, please refer to page 675

MIXO INSERTS

<sup>1)</sup> on request, version with 3 fastened CX 20 CF/CM inserts with poles numbered from 1 - 60  
references: **CX 60 CF**, **CX 60 CM**

- characteristics according to EN 61984:

**16A 500V 6kV 3**  
**16A 830V 8kV 2**

- us (UL for USA and Canada),

- certified

- rated voltage according to UL/CSA: 600V

- insulation resistance:  $\geq 10 \text{ G}\Omega$

- ambient temperature limit: -40 °C ... +125 °C

- made of self-extinguishing thermoplastic resin UL 94V-0

- mechanical life:  $\geq 500$  cycles

- contact resistance:  $\leq 1 \text{ m}\Omega$   
- for max. current load see the connector inserts derating diagram below; for more information see page 28

### CX 20 C, 20 poles connector inserts Maximum current load derating diagram

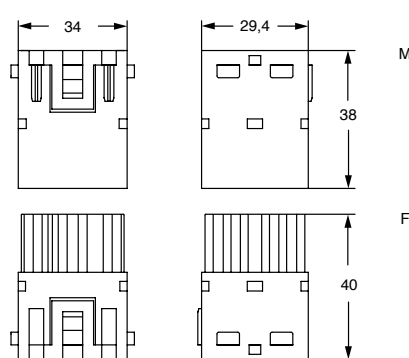
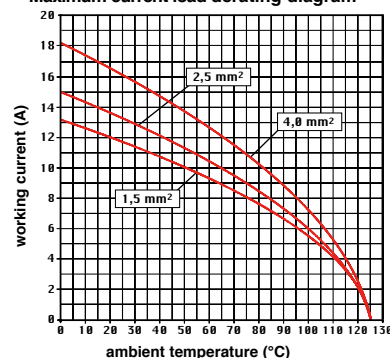

contacts side (front view)  
side with reference arrow ▲

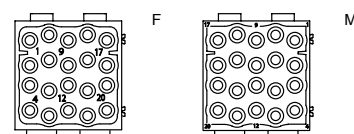

- 2 frame slots

### CCF and CCM

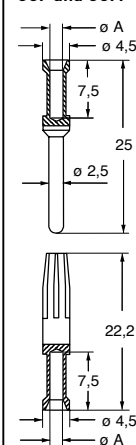

### CC...AN

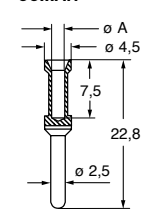

### CCF, CCM and CC...AN contacts

conductor section (mm <sup>2</sup> )	conductor slot ø A (mm)	conductors stripping length (mm)
0,14-0,37	0,9	7,5
0,5	1,1	7,5
0,75	1,3	7,5
1,0	1,45	7,5
1,5	1,8	7,5
2,5	2,2	7,5
3	2,55	7,5
4	2,85	7,5

# HT 2 poles single module 16A - 2500V

The modular inserts must be installed in suitable frames which are then mounted in traditional enclosures\* or in COB panel support.

Single-sized modular units may be directly mounted inside MIXO ONE enclosures.

frames for modular units\* page:  
316 - 317

MIXO ONE enclosures 369

\* enclosures: bulkhead mounting housings, high construction housings or high construction hoods

1) supplied with heat shrink insulating tubes for the rear of the contacts

## high voltage modular units, crimp connections

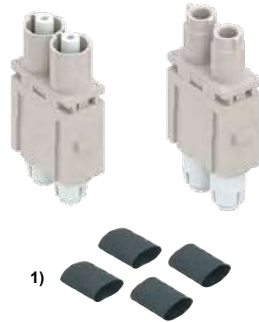

## 16A crimp contacts silver and gold plated



description	part No.	part No
without contacts (to be ordered separately)		
high voltage female inserts for female contacts	<b>CX 02 CHF</b>	
high voltage male inserts for male contacts	<b>CX 02 CHM</b>	
contact holder removal tool	<b>CH1ES</b>	
16A female crimp contacts		
0,5 mm <sup>2</sup> AWG 20 with no grooves		<b>CCFA 0.5</b>
0,75 mm <sup>2</sup> AWG 18 one groove (back side)		<b>CCFA 0.7</b>
1 mm <sup>2</sup> AWG 18 one groove		<b>CCFA 1.0</b>
1,5 mm <sup>2</sup> AWG 16 two grooves		<b>CCFA 1.5</b>
2,5 mm <sup>2</sup> AWG 14 three grooves		<b>CCFA 2.5</b>
3 mm <sup>2</sup> AWG 12 one wide groove		<b>CCFA 3.0</b>
4 mm <sup>2</sup> AWG 12 with no grooves		<b>CCFA 4.0</b>
16A male crimp contacts		
0,5 mm <sup>2</sup> AWG 20 with no grooves		<b>CCMA 0.5</b>
0,75 mm <sup>2</sup> AWG 18 one groove (back side)		<b>CCMA 0.7</b>
1 mm <sup>2</sup> AWG 18 one groove		<b>CCMA 1.0</b>
1,5 mm <sup>2</sup> AWG 16 two grooves		<b>CCMA 1.5</b>
2,5 mm <sup>2</sup> AWG 14 three grooves		<b>CCMA 2.5</b>
3 mm <sup>2</sup> AWG 12 one wide groove		<b>CCMA 3.0</b>
4 mm <sup>2</sup> AWG 12 with no grooves		<b>CCMA 4.0</b>

silver plated

gold plated+

MIXO INSERTS

- characteristics according to EN 61984 2):
- 16A 2500V 15kV 3**
- 2) used for guidance as applicable
- cURus, CSA, CQC, DNV-GL, BV, EAC pending
- insulation resistance:  $\geq 10 \text{ G}\Omega$
- ambient temperature limit:  $-40 \text{ }^\circ\text{C} \dots +125 \text{ }^\circ\text{C}$
- made of self-extinguishing thermoplastic resin UL 94V-0
- mechanical life:  $\geq 500$  cycles
- contact resistance:  $\leq 1 \text{ m}\Omega$
- **it is recommended to crimp the contacts with crimping tools homologated by ILME** (please see the crimping tool section 16A contacts, CCF and CCM series) on pages 708 - 741
- contact holder removal tool: **CH1ES**

CH1ES

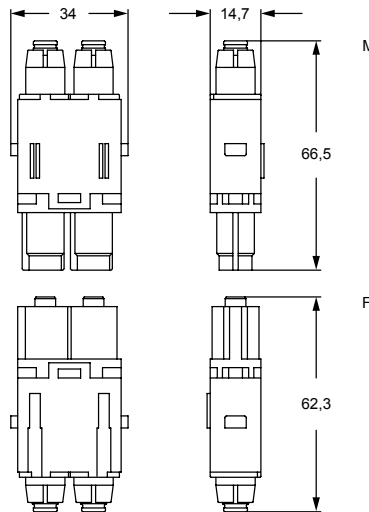

contacts side (front view)

side with reference arrow ▲

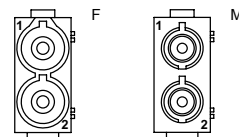

- 1 frame slot

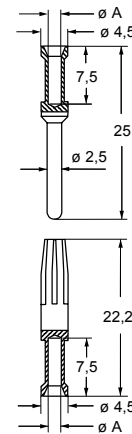

CCF and CCM contacts

conductor section (mm <sup>2</sup> )	conductor slot $\varnothing A$ (mm)	conductors stripping length (mm)
0,5	1,1	9,5
0,75	1,3	9,5
1,0	1,45	9,5
1,5	1,8	9,5
2,5	2,2	9,5
3	2,55	9,5
4	2,85	9,5

+ for basic or high thickness gold plating, please refer to page 675



Watch our online tutorial

# HT 2 poles 16A - 2900/5000V

The modular inserts must be installed in suitable frames, which are then mounted in traditional enclosures\* or in COB panel supports.

frames for modular units\* page: 316

\* enclosures: bulkhead mounting housings, high construction housings or high construction hoods

1) supplied with heat shrink insulating tubes for the rear of the contacts

high voltage modular units, crimp connections contact holder removal tool

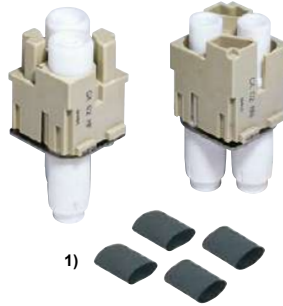

16A crimp contacts silver and gold plated



description	part No.	part No.
-------------	----------	----------

without contacts (to be ordered separately)		
high voltage female inserts for female contacts	<b>CX 02 HF</b>	
high voltage male inserts for male contacts	<b>CX 02 HM</b>	
contact holder removal tool	<b>CHES</b>	

16A female crimp contacts				
0,5 mm <sup>2</sup>	AWG 20	with no grooves	<b>CCFA 0.5</b>	<b>CCFD 0.5</b>
0,75 mm <sup>2</sup>	AWG 18	one groove (back side)	<b>CCFA 0.7</b>	<b>CCFD 0.7</b>
1 mm <sup>2</sup>	AWG 18	one groove	<b>CCFA 1.0</b>	<b>CCFD 1.0</b>
1,5 mm <sup>2</sup>	AWG 16	two grooves	<b>CCFA 1.5</b>	<b>CCFD 1.5</b>
2,5 mm <sup>2</sup>	AWG 14	three grooves	<b>CCFA 2.5</b>	<b>CCFD 2.5</b>
3 mm <sup>2</sup>	AWG 12	one wide groove	<b>CCFA 3.0</b>	<b>CCFD 3.0</b>
4 mm <sup>2</sup>	AWG 12	with no grooves	<b>CCFA 4.0</b>	<b>CCFD 4.0</b>
			silver plated	gold plated+
16A male crimp contacts				
0,5 mm <sup>2</sup>	AWG 20	with no grooves	<b>CCMA 0.5</b>	<b>CCMD 0.5</b>
0,75 mm <sup>2</sup>	AWG 18	one groove (back side)	<b>CCMA 0.7</b>	<b>CCMD 0.7</b>
1 mm <sup>2</sup>	AWG 18	one groove	<b>CCMA 1.0</b>	<b>CCMD 1.0</b>
1,5 mm <sup>2</sup>	AWG 16	two grooves	<b>CCMA 1.5</b>	<b>CCMD 1.5</b>
2,5 mm <sup>2</sup>	AWG 14	three grooves	<b>CCMA 2.5</b>	<b>CCMD 2.5</b>
3 mm <sup>2</sup>	AWG 12	one wide groove	<b>CCMA 3.0</b>	<b>CCMD 3.0</b>
4 mm <sup>2</sup>	AWG 12	with no grooves	<b>CCMA 4.0</b>	<b>CCMD 4.0</b>

MIXO INSERTS

- characteristics according to EN 61984 2): **16A 2900/5000V 15kV 3**
- 2) used for guidance as applicable
- cURus, CSA, CQC, DNV-GL, BV, EAC pending
- insulation resistance:  $\geq 10 \text{ G}\Omega$
- ambient temperature limit:  $-40 \text{ }^\circ\text{C} \dots +125 \text{ }^\circ\text{C}$
- made of self-extinguishing thermoplastic resin UL 94V-0
- mechanical life:  $\geq 500$  cycles
- contact resistance:  $\leq 1 \text{ m}\Omega$
- **it is recommended to crimp the contacts with crimping tools homologated by ILME** (please see the crimping tool section 16A contacts, CCF and CCM series) on pages 708 - 741
- contact holder removal tool: **CHES**

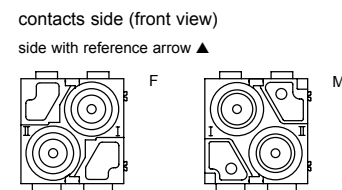
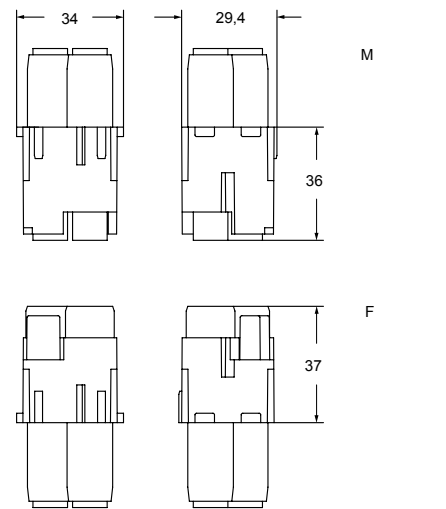

- 2 frame slots

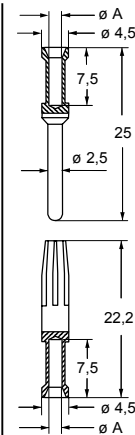

CCF and CCM contacts		
conductor section (mm <sup>2</sup> )	conductor slot $\varnothing A$ (mm)	conductors stripping length (mm)
0,14-0,37	0,9	9,5
0,5	1,1	9,5
0,75	1,3	9,5
1,0	1,45	9,5
1,5	1,8	9,5
2,5	2,2	9,5
3	2,55	9,5
4	2,85	9,5

+ for basic or high thickness gold plating, please refer to page 675

# CX 12 DF/DM 12 poles 10A - 250V

The modular inserts must be installed in suitable frames which are then mounted in traditional enclosures\* or in COB panel support.  
Single-sized modular units may be directly mounted inside MIXO ONE enclosures.

frames for modular units\* page: 316 - 317

MIXO ONE enclosures 369

\* enclosures: bulkhead mounting housings, high construction housings or high construction hoods

modular units,  
crimp connections

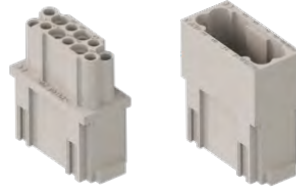

**RATING 250V**

10A crimp contacts,  
silver and gold plated



description	part No.	part No
-------------	----------	---------

without contacts (to be ordered separately)  
female inserts for female contacts  
male inserts for male contacts

**CX 12 DF**  
**CX 12 DM**

10A female crimp contacts

0,14-0,37 mm <sup>2</sup>	AWG 26-22	identification No. 1
0,5 mm <sup>2</sup>	AWG 20	identification No. 2
0,75 mm <sup>2</sup>	AWG 18	identification No. ②
1 mm <sup>2</sup>	AWG 18	identification No. 3
1,5 mm <sup>2</sup>	AWG 16	identification No. 4
2,5 mm <sup>2</sup>	AWG 14	identification No. 5

<b>CDFA 0.3</b>	<b>silver plated</b>	<b>CDFD 0.3</b>	<b>gold plated+</b>
<b>CDFA 0.5</b>		<b>CDFD 0.5</b>	
<b>CDFA 0.7</b>		<b>CDFD 0.7</b>	
<b>CDFA 1.0</b>		<b>CDFD 1.0</b>	
<b>CDFA 1.5</b>		<b>CDFD 1.5</b>	
<b>CDFA 2.5</b>		<b>CDFD 2.5</b>	

10A male crimp contacts

0,14-0,37 mm <sup>2</sup>	AWG 26-22	identification No. 1
0,5 mm <sup>2</sup>	AWG 20	identification No. 2
0,75 mm <sup>2</sup>	AWG 18	identification No. ②
1 mm <sup>2</sup>	AWG 18	identification No. 3
1,5 mm <sup>2</sup>	AWG 16	identification No. 4
2,5 mm <sup>2</sup>	AWG 14	identification No. 5

<b>CDMA 0.3</b>	<b>silver plated</b>	<b>CDMD 0.3</b>	<b>gold plated+</b>
<b>CDMA 0.5</b>		<b>CDMD 0.5</b>	
<b>CDMA 0.7</b>		<b>CDMD 0.7</b>	
<b>CDMA 1.0</b>		<b>CDMD 1.0</b>	
<b>CDMA 1.5</b>		<b>CDMD 1.5</b>	
<b>CDMA 2.5</b>		<b>CDMD 2.5</b>	

- characteristics according to EN 61984:
- 10A 250V 4kV 3**
- certified
- rated voltage according to UL/CSA: 600V
- insulation resistance: ≥ 10 GΩ
- ambient temperature limit: -40 °C ... +125 °C
- made of self-extinguishing thermoplastic resin UL 94V-0
- mechanical life: ≥ 500 cycles
- contact resistance: ≤ 3 mΩ
- PCBs interface, refer to article CIF 2.4 on page 670
- **it is recommended to crimp the contacts with crimping tools homologated by ILME** (please see the crimping tool section 10A contacts, CDF and CDM series) on pages 708 - 741
- for max. current load see the connector inserts derating diagram below; for more information see page 28

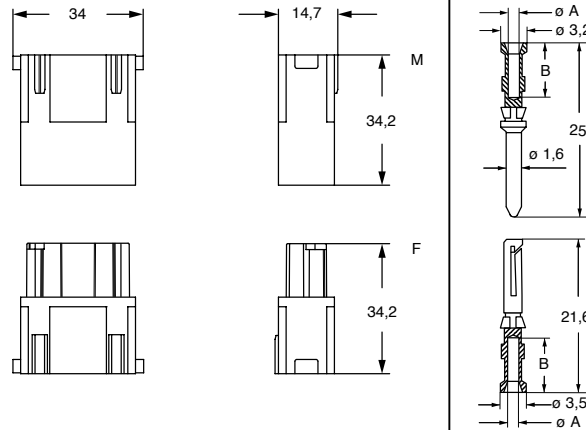

contacts side (front view)

side with reference arrow ▲

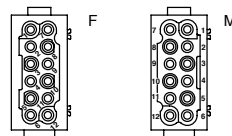

- 1 frame slot

**CDF and CDM contacts**

conductor section (mm <sup>2</sup> )	conductor slot ø A (mm)	conductors stripping length B (mm)
0,14-0,37	0,9	8
0,5	1,1	8
0,75	1,3	8
1,0	1,45	8
1,5	1,8	8
2,5	2,2	6

† for basic or high thickness gold plating, please refer to page 674

**CX 12 D, 12 poles connector inserts**  
**Maximum current load derating diagram**

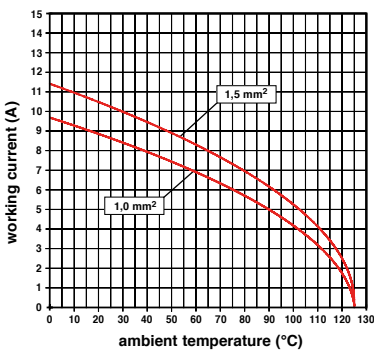

**CX 17 DF/DM 17 poles 10A - 160V**

The modular inserts must be installed in suitable frames which are then mounted in traditional enclosures or in COB panel support.  
Single-sized modular units may be directly mounted inside MIXO ONE enclosures.

frames for modular units page: 316 - 317  
MIXO ONE enclosures 369

modular units,  
crimp connections

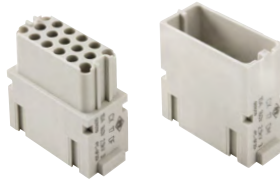

10A crimp contacts,  
silver and gold plated



description	part No.	part No
-------------	----------	---------

without contacts (to be ordered separately)  
female inserts for female contacts  
male inserts for male contacts

**CX 17 DF**  
**CX 17 DM**

10A female crimp contacts

0,14-0,37 mm <sup>2</sup>	AWG 26-22	identification No. 1
0,5 mm <sup>2</sup>	AWG 20	identification No. 2
0,75 mm <sup>2</sup>	AWG 18	identification No. ②
1 mm <sup>2</sup>	AWG 18	identification No. 3
1,5 mm <sup>2</sup>	AWG 16	identification No. 4
2,5 mm <sup>2</sup>	AWG 14	identification No. 5

CDFA 0.3	CDFD 0.3
CDFA 0.5	CDFD 0.5
CDFA 0.7	CDFD 0.7
CDFA 1.0	CDFD 1.0
CDFA 1.5	CDFD 1.5
CDFA 2.5	CDFD 2.5

silver plated

gold plated<sup>+</sup>

10A male crimp contacts

0,14-0,37 mm <sup>2</sup>	AWG 26-22	identification No. 1
0,5 mm <sup>2</sup>	AWG 20	identification No. 2
0,75 mm <sup>2</sup>	AWG 18	identification No. ②
1 mm <sup>2</sup>	AWG 18	identification No. 3
1,5 mm <sup>2</sup>	AWG 16	identification No. 4
2,5 mm <sup>2</sup>	AWG 14	identification No. 5

CDMA 0.3	CDMD 0.3
CDMA 0.5	CDMD 0.5
CDMA 0.7	CDMD 0.7
CDMA 1.0	CDMD 1.0
CDMA 1.5	CDMD 1.5
CDMA 2.5	CDMD 2.5

MIXO INSERTS

- characteristics according to EN 61984:  
**10A 160V 2,5kV 3**  
**10A 250V 4kV 2**
- us (UL for USA and Canada),
- certified
- rated voltage according to UL/CSA: 250V
- insulation resistance: ≥ 10 GΩ
- ambient temperature limit: -40 °C ... +125 °C
- made of self-extinguishing thermoplastic resin  
UL 94V-0
- mechanical life: ≥ 500 cycles
- contact resistance: ≤ 3 mΩ
- **it is recommended to crimp the contacts with crimping tools homologated by ILME** (please see the crimping tool section 10A contacts, CDF and CDM series) on pages 708 - 741
- for max. current load see the connector inserts derating diagram below; for more information see page 28

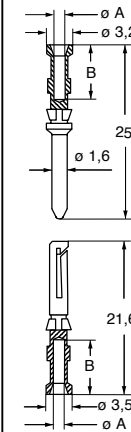
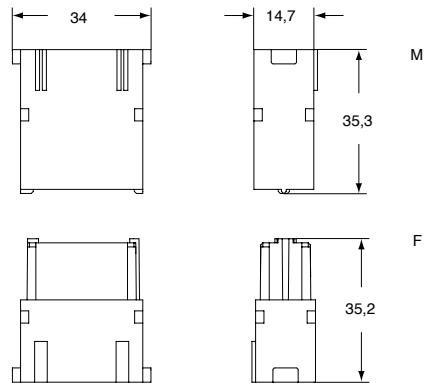

contacts side (front view)

side with reference arrow ▲

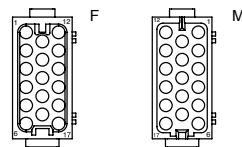

- 1 frame slot

**CDF and CDM contacts**

conductor section (mm <sup>2</sup> )	conductor slot ø A (mm)	conductors stripping length B (mm)
0,14-0,37	0,9	8
0,5	1,1	8
0,75	1,3	8
1,0	1,45	8
1,5	1,8	8
2,5	2,2	6

<sup>+</sup> for basic or high thickness gold plating, please refer to page 674

**CX 17 D, 17 poles connector inserts**  
**Maximum current load derating diagram**

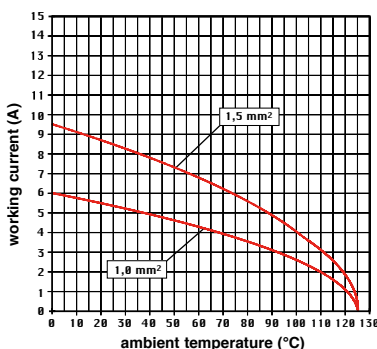



# CX 42 DF/DM 42 poles 10A - 150V

The modular inserts must be installed in suitable frames, which are then mounted in traditional enclosures\* or in COB panel supports.

frames for modular units\*

page:  
316

modular units,  
crimp connections

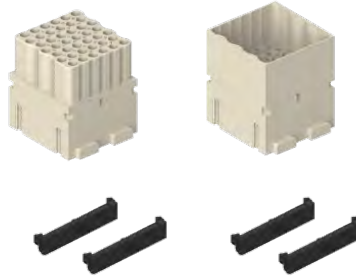

10A crimp contacts,  
silver and gold plated



\* enclosures: bulkhead mounting housings, high construction housings or high construction hoods

description

part No.

part No

without contacts (to be ordered separately), supplied with 2 dedicated black coloured 2-slot sized lock-in tab female inserts for female contacts  
male inserts for male contacts

**CX 42 DF**  
**CX 42 DM**

10A female crimp contacts

0,14-0,37 mm <sup>2</sup>	AWG 26-22	identification No. 1
0,5 mm <sup>2</sup>	AWG 20	identification No. 2
0,75 mm <sup>2</sup>	AWG 18	identification No. ②
1 mm <sup>2</sup>	AWG 18	identification No. 3
1,5 mm <sup>2</sup>	AWG 16	identification No. 4
2,5 mm <sup>2</sup>	AWG 14	identification No. 5

10A male crimp contacts

0,14-0,37 mm <sup>2</sup>	AWG 26-22	identification No. 1
0,5 mm <sup>2</sup>	AWG 20	identification No. 2
0,75 mm <sup>2</sup>	AWG 18	identification No. ②
1 mm <sup>2</sup>	AWG 18	identification No. 3
1,5 mm <sup>2</sup>	AWG 16	identification No. 4
2,5 mm <sup>2</sup>	AWG 14	identification No. 5

CDFA 0.3
CDFA 0.5
CDFA 0.7
CDFA 1.0
CDFA 1.5
CDFA 2.5

silver plated

CDFD 0.3
CDFD 0.5
CDFD 0.7
CDFD 1.0
CDFD 1.5
CDFD 2.5

gold plated+

CDMA 0.3
CDMA 0.5
CDMA 0.7
CDMA 1.0
CDMA 1.5
CDMA 2.5

CDMD 0.3
CDMD 0.5
CDMD 0.7
CDMD 1.0
CDMD 1.5
CDMD 2.5

- characteristics according to EN 61984:

**10A 150V 2,5kV 3**

- cURus, CSA, CQC, DNV-GL, BV, EAC pending
- rated voltage according to UL/CSA: 250V
- insulation resistance:  $\geq 10 \text{ G}\Omega$
- ambient temperature limit:  $-40 \text{ }^\circ\text{C} \dots +125 \text{ }^\circ\text{C}$
- made of self-extinguishing thermoplastic resin UL 94V-0
- mechanical life:  $\geq 500$  cycles
- contact resistance:  $\leq 3 \text{ m}\Omega$
- it is recommended to crimp the contacts with crimping tools homologated by ILME (please see the crimping tool section 10A contacts, CDF and CDM series) on pages 708 - 741

- supplied with dedicated black coloured 2-slot sized lock-in tab (2, one per each side).
- for spare lock-in tab **CX CFMD** see SPARE SPARTS catalogue

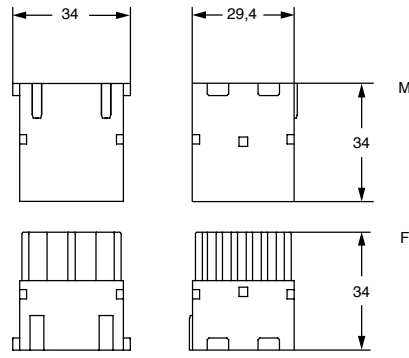

contacts side (front view)

rear view, side with reference arrow ▲

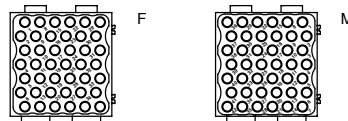

- 2 frame slots

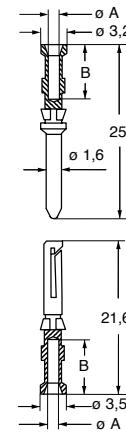

**CDF and CDM contacts**

conductor section (mm <sup>2</sup> )	conductor slot $\phi A$ (mm)	conductors stripping length B (mm)
0,14-0,37	0,9	8
0,5	1,1	8
0,75	1,3	8
1,0	1,45	8
1,5	1,8	8
2,5	2,2	6

+ for basic or high thickness gold plating, please refer to page 674



# CX 25 IBF/IBM 25 poles 4A - 50V

The modular inserts must be installed in suitable frames which are then mounted in traditional enclosures or in COB panel support.  
Single-sized modular units may be directly mounted inside MIXO ONE enclosures.

frames for modular units page: 316 - 317

MIXO ONE enclosures 369

- max insulating diameter 2,1 mm
- we recommend the use of CRF / CRM code pins

modular units, crimp connections

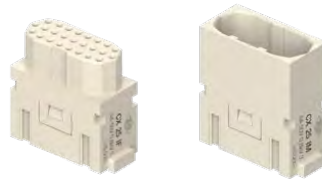

CI (4A) crimp contacts, silver and gold plated



description	part No.	part No
-------------	----------	---------

without contacts (to be ordered separately)  
female inserts for female contacts  
male inserts for male contacts

**CX 25 IBF**  
**CX 25 IBM**

CI (4A) female crimp contacts  
0,08-0,21 mm<sup>2</sup> AWG 28-24  
0,13-0,33 mm<sup>2</sup> AWG 26-22  
0,33-0,52 mm<sup>2</sup> AWG 22-20  
0,52-0,75 mm<sup>2</sup> AWG 20-18

CIFA 0.2  
CIFA 0.3  
CIFA 0.5  
CIFA 0.7

CIFD 0.2  
CIFD 0.3  
CIFD 0.5  
CIFD 0.7

CI (4A) male crimp contacts  
0,08-0,21 mm<sup>2</sup> AWG 28-24  
0,13-0,33 mm<sup>2</sup> AWG 26-22  
0,33-0,52 mm<sup>2</sup> AWG 22-20  
0,52-0,75 mm<sup>2</sup> AWG 20-18

CIMA 0.2  
CIMA 0.3  
CIMA 0.5  
CIMA 0.7

CIMD 0.2  
CIMD 0.3  
CIMD 0.5  
CIMD 0.7

- characteristics according to EN 61984:

**4A 50V 0,8kV 3**  
**4A 160V 2,5kV 2**

- certified
- rated voltage according to UL/CSA: 600V
- insulation resistance:  $\geq 10$  G $\Omega$
- ambient temperature limit: -40 °C ... +125 °C
- made of self-extinguishing thermoplastic resin UL 94V-0
- mechanical life:  $\geq 500$  cycles
- contact resistance:  $\leq 4$  m $\Omega$
- for crimp contacts CI series use, on page 716 - 719
- **CIPZ D** crimping tool
- **CITP D** turret head
- **CIES** insertion / removal tool for contacts 0,2 - 0,5 mm<sup>2</sup>
- **CIES B** insertion / removal tool for contacts 0,75 mm<sup>2</sup>
- for max. current load see the connector inserts derating diagram below; for more information see page 28

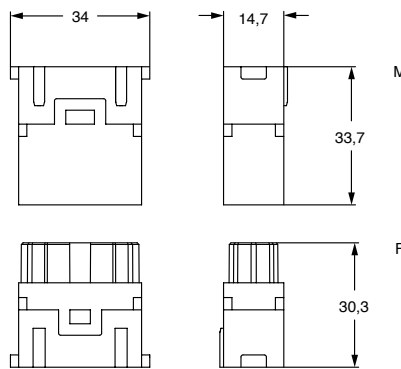

contacts side (front view)

side with reference arrow ▲

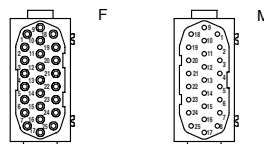

- 1 frame slot

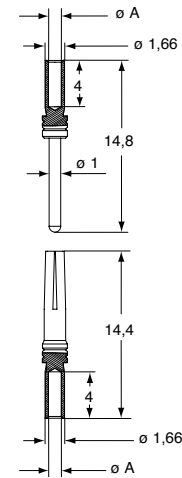

**CI and CIM contacts**

conductor section (mm <sup>2</sup> )	conductor slot $\phi A$ (mm)	conductors stripping length (mm)
0,08-0,21	0,64	4
0,13-0,33	0,90	4
0,33-0,52	1,12	4
0,52-0,75	1,12	4

**CX 25 IB, 25 poles connector inserts**  
**Maximum current load derating diagram**

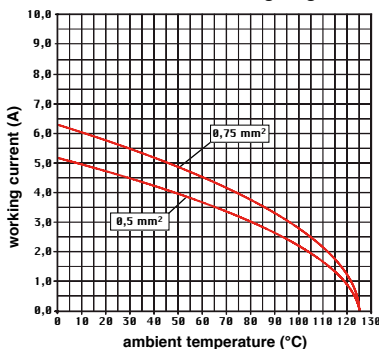

MIXO INSERTS

silver plated

gold plated

## MODULES FOR HIGH NUMBER OF MATINGS

Within the range of **series HNM**, for High Number of Matings, all MIXO modules for crimp contacts 40A, 16A and/or 10A, combined with the use of especially high thickness gold-plated/lubricated crimp contacts of:

- series **RX** (40A HNM variant of series CX),
- series **RC** (16A HNM variant of series CC), and
- series **RD** (10A HNM variant of series CD)

mounted in the dedicated **MIXO HNM frames** cat. nos. **RX 02 /03 /04 /06 TF /TM**, also employing especially gold-plated PE contacts, allow the creation of **HNM** modular connector inserts.

The connector modules of series MIXO that by using HNM 40A contacts series **RX**, HNM 16A contacts series **RC** and/or HNM 10A contacts series **RD** together with **MIXO HNM frames** RX 02...06 TF/M can create MIXO HNM modular connector inserts are:

- **CX 02 4F/M**, **CX 03 4F/M**, **CX 03 4BF/M** and **CX 04 XF/XM** (with **RX** HNM contacts)
- **CX 3/4 XDF/M** (with **RX** and **RD** HNM contacts)
- **CX 06 CF/M**, **CX 06P CF/M**, **CX 08 CF/M** and **CX 20 CF/M** (with **RC** HNM contacts)
- **CX 12 DF/M**, **CX 17 DF/M** and **CX 42 DF/M** (with **RD** HNM contacts)



### SUM UP

- ☑ **Up to 10.000 matings in combination with HNM enclosures**
- ☑ **Up to 5.000 matings with standard hoods with single lever**



The modular inserts must be installed in suitable frames, which are then mounted in traditional enclosures\* or in COB panel supports.

frames for modular units\*

page:  
333

\* enclosures: bulkhead mounting housings, high construction housings or high construction hoods

modular units, crimp connections

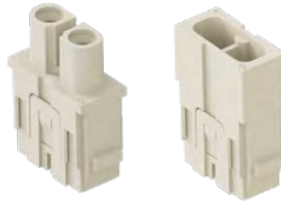

**Q 10.000 MATINGS WITH HNM FRAMES AND HNM ENCLOSURES**

**Q 5.000 MATINGS WITH HNM FRAMES AND STANDARD ENCLOSURES, SINGLE LEVER**

40A crimp contacts  
gold plated



description	part No.	part No
-------------	----------	---------

without contacts (to be ordered separately)  
female inserts for female contacts <sup>1)</sup>  
male inserts for male contacts <sup>1)</sup>

**CX 02 4F**  
**CX 02 4M**

40A female crimp contacts  
1,5 mm<sup>2</sup> AWG 16  
2,5 mm<sup>2</sup> AWG 14  
4 mm<sup>2</sup> AWG 12  
6 mm<sup>2</sup> AWG 10  
10 mm<sup>2</sup> AWG 8

**RXF2D 1.5**  
**RXF2D 2.5**  
**RXF2D 4.0**  
**RXF2D 6.0**  
**RXF2D 10**

gold plated

40A male crimp contacts  
1,5 mm<sup>2</sup> AWG 16  
2,5 mm<sup>2</sup> AWG 14  
4 mm<sup>2</sup> AWG 12  
6 mm<sup>2</sup> AWG 10  
10 mm<sup>2</sup> AWG 8

**RXM2D 1.5**  
**RXM2D 2.5**  
**RXM2D 4.0**  
**RXM2D 6.0**  
**RXM2D 10**

<sup>1)</sup> cable diameter up to 7,5 mm  
contact size up to 10 mm<sup>2</sup>

- characteristics according to EN 61984:  
**40A 1000V 8kV 3**

- certified

- rated voltage according to UL/CSA: 600V

- insulation resistance: ≥ 10 GΩ

- ambient temperature limit: -40 °C ... +125 °C

- made of self-extinguishing thermoplastic resin  
UL 94V-0

- mechanical life: ≥ 10.000 cycles

- contact resistance: ≤ 0,3 mΩ

- can be mated with CX 02 A/B modules

- **it is recommended to crimp the contacts**  
**(1,5 - 10 mm<sup>2</sup>), with crimping tools homologated**  
**by ILME** (please see the crimping tool section 40A  
contacts, RXF2D and RXM2D series) on pages  
708 - 741

- for max. current load see the connector inserts derating  
diagram below; for more information see page 28

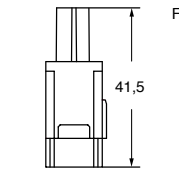
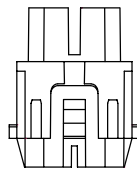
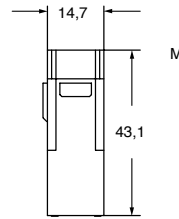
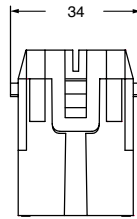

contacts side (front view)

side with reference arrow ▲

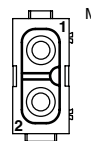
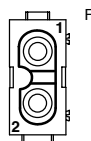

- 1 frame slot

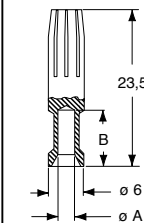
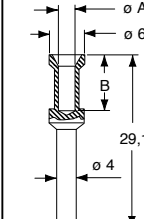

**RXF2D and RXM2D contacts**

conductor section (mm <sup>2</sup> )	conductor slot diameter A (mm)	conductor stripping length B (mm)
1,5	1,8	9
2,5	2,2	9
4	2,85	9,6
6	3,5	9,6
10	4,3	15

**CX 02 4, 2 poles connector inserts**  
**Maximum current load derating diagram**

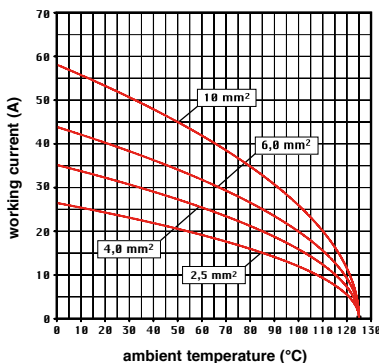

The modular inserts must be installed in suitable frames, which are then mounted in traditional enclosures or in COB panel supports.

frames for modular units

page: 333

modular units, crimp connections

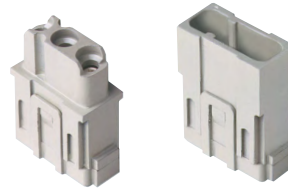

**Q 10.000 MATINGS WITH HNM FRAMES AND HNM ENCLOSURES**

**Q 5.000 MATINGS WITH HNM FRAMES AND STANDARD ENCLOSURES, SINGLE LEVER**

40A crimp contacts gold plated



description

part No.

part No

without contacts (to be ordered separately)  
female inserts for female contacts <sup>1)</sup>  
male inserts for male contacts <sup>1)</sup>

**CX 03 4F**  
**CX 03 4M**

40A female crimp contacts  
1,5 mm<sup>2</sup> AWG 16  
2,5 mm<sup>2</sup> AWG 14  
4 mm<sup>2</sup> AWG 12  
6 mm<sup>2</sup> AWG 10

**RXF2D 1.5**  
**RXF2D 2.5**  
**RXF2D 4.0**  
**RXF2D 6.0**

**gold plated**

40A male crimp contacts  
1,5 mm<sup>2</sup> AWG 16  
2,5 mm<sup>2</sup> AWG 14  
4 mm<sup>2</sup> AWG 12  
6 mm<sup>2</sup> AWG 10

**RXM2D 1.5**  
**RXM2D 2.5**  
**RXM2D 4.0**  
**RXM2D 6.0**

**MIXO - HNM**

<sup>1)</sup> cable diameter up to 5 mm

- characteristics according to EN 61984:

**40A 400/690V 6kV 3**

- cULus (UL for USA and Canada),

- certified

- rated voltage according to UL/CSA: 600V

- insulation resistance:  $\geq 10 \text{ G}\Omega$

- ambient temperature limit: -40 °C ... +125 °C

- made of self-extinguishing thermoplastic resin UL 94V-0

- mechanical life:  $\geq 10.000$  cycles

- contact resistance:  $\leq 0,3 \text{ m}\Omega$

- **it is recommended to crimp the contacts with crimping tools homologated by ILME** (please see the crimping tool section 40A contacts, RXF2D and RXM2D series) on pages 708 - 741

- for max. current load see the connector inserts derating diagram below; for more information see page 28

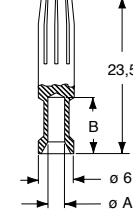
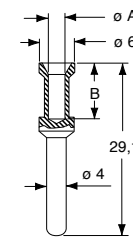
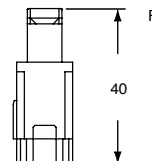
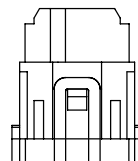
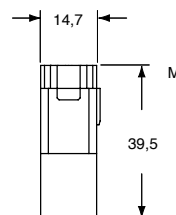
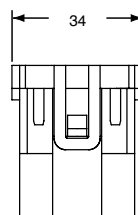

contacts side (front view)

side with reference arrow ▲

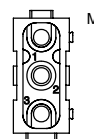
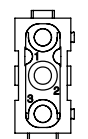

- 1 frame slot

**RXF2D and RXM2D contacts**

conductor section (mm <sup>2</sup> )	conductor slot $\varnothing$ A (mm)	conductor stripping length B (mm)
1,5	1,8	9
2,5	2,2	9
4	2,85	9,6
6	3,5	9,6

**CX 03 poles connector inserts**  
**Maximum current load derating diagram**

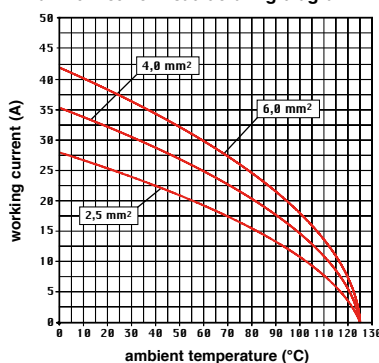



The modular inserts must be installed in suitable frames, which are then mounted in traditional enclosures\* or in COB panel supports.

frames for modular units\*

page: 333

\* enclosures: bulkhead mounting housings, high construction housings or high construction hoods

modular units, crimp connections

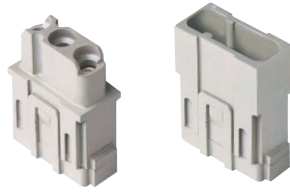

**Q 10.000 MATINGS WITH HNM FRAMES AND HNM ENCLOSURES**

**Q 5.000 MATINGS WITH HNM FRAMES AND STANDARD ENCLOSURES, SINGLE LEVER**

40A crimp contacts gold plated



description

part No.

part No

without contacts (to be ordered separately)  
female inserts for female contacts <sup>1)</sup>  
male inserts for male contacts <sup>1)</sup>

**CX 03 4BF**  
**CX 03 4BM**

40A female crimp contacts  
1,5 mm<sup>2</sup> AWG 16  
2,5 mm<sup>2</sup> AWG 14  
4 mm<sup>2</sup> AWG 12  
6 mm<sup>2</sup> AWG 10  
10 mm<sup>2</sup> AWG 8

**RXF2D 1.5**  
**RXF2D 2.5**  
**RXF2D 4.0**  
**RXF2D 6.0**  
**RXF2D 10**

gold plated

40A male crimp contacts  
1,5 mm<sup>2</sup> AWG 16  
2,5 mm<sup>2</sup> AWG 14  
4 mm<sup>2</sup> AWG 12  
6 mm<sup>2</sup> AWG 10  
10 mm<sup>2</sup> AWG 8

**RXM2D 1.5**  
**RXM2D 2.5**  
**RXM2D 4.0**  
**RXM2D 6.0**  
**RXM2D 10**

<sup>1)</sup> cable diameter up to 7,5 mm  
contact size up to 10 mm<sup>2</sup>

- characteristics according to EN 61984:  
**40A 500V 6kV 3**

- cULus (UL for USA and Canada),

- certified

- rated voltage according to UL/CSA: 600V

- insulation resistance: ≥ 10 GΩ

- ambient temperature limit: -40 °C ... +125 °C

- made of self-extinguishing thermoplastic resin  
UL 94V-0

- mechanical life: ≥ 10.000 cycles

- contact resistance: ≤ 0,3 mΩ

- can be mated with CX 02 A/B modules

- **it is recommended to crimp the contacts**  
(1,5 - 10 mm<sup>2</sup>), **with crimping tools homologated by ILME** (please see the crimping tool section 40A contacts, RXF2D and RXM2D series) on pages 708 - 741

- for max. current load see the connector inserts derating diagram below; for more information see page 28

**CX 03 4B, 3 poles connector inserts**  
**Maximum current load derating diagram**

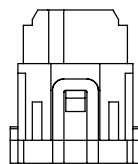
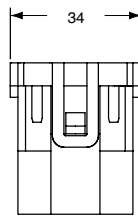
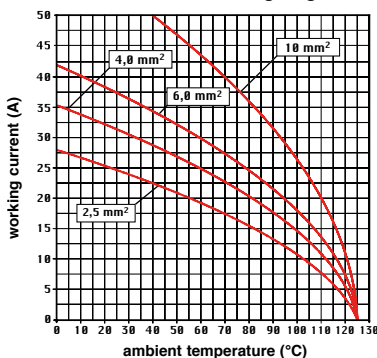

contacts side (front view)

side with reference arrow ▲

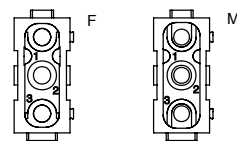

- 1 frame slot

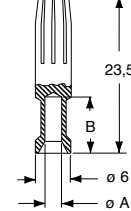
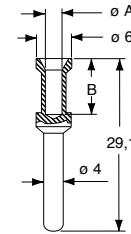
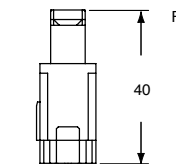
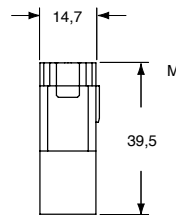

**RXF2D and RXM2D contacts**

conductor section (mm <sup>2</sup> )	conductor slot ø A (mm)	conductor stripping length B (mm)
1,5	1,8	9
2,5	2,2	9
4	2,85	9,6
6	3,5	9,6
10	4,3	15

**CX 3/4 XDF/M 3 p (40A - 830V) + 4 p (10A - 830V) HNM (High Number of Matings)**

The modular inserts must be installed in suitable frames, which are then mounted in traditional enclosures or in COB panel supports.

page: 333  
frames for modular units

- male and female contacts finger proof  
- their key characteristic **lies in the fact that they guarantee maximum safety even in case of accidental contact with fingers (IP2X or IPXXB)**. Safety is guaranteed as standard on female contacts, but also on male contacts. This feature is important as it ensures full compliance with the recent safety standard **EN 60204-1**, concerning electric equipment fitted on machines and in particular with the requirements of Article 6.2.4 concerning protection against residual voltage. **In the case of plugs or similar devices, the withdrawal of which results in the exposure of conductors (for example pins), the discharge time shall not exceed 1 s, otherwise such conductors shall be protected against direct contact to at least an IP2X or IPXXB.**

modular units, crimp connections

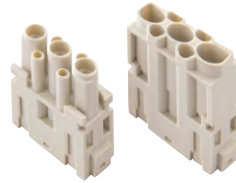

Q 10.000 MATINGS WITH HNM FRAMES AND HNM ENCLOSURES  
Q 5.000 MATINGS WITH HNM FRAMES AND STANDARD ENCLOSURES, SINGLE LEVER

40A and 10A crimp contacts gold plated

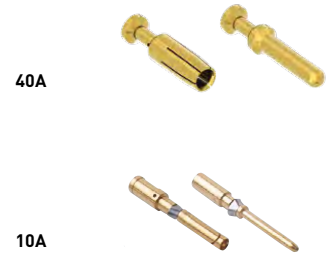

description

part No.

part No

without contacts (to be ordered separately)  
female inserts for female contacts  
male inserts for male contacts

CX 3/4 XDF  
CX 3/4 XDM

40A female crimp contacts  
1,5 mm<sup>2</sup> AWG 16  
2,5 mm<sup>2</sup> AWG 14  
4 mm<sup>2</sup> AWG 12  
6 mm<sup>2</sup> AWG 10

RXF2D 1.5  
RXF2D 2.5  
RXF2D 4.0  
RXF2D 6.0

40A male crimp contacts  
1,5 mm<sup>2</sup> AWG 16  
2,5 mm<sup>2</sup> AWG 14  
4 mm<sup>2</sup> AWG 12  
6 mm<sup>2</sup> AWG 10

RXM2D 1.5  
RXM2D 2.5  
RXM2D 4.0  
RXM2D 6.0

10A female crimp contacts  
0,14-0,37 mm<sup>2</sup> AWG 26-22 identification No. 1  
0,5 mm<sup>2</sup> AWG 20 identification No. 2  
0,75 mm<sup>2</sup> AWG 18 identification No. ②  
1 mm<sup>2</sup> AWG 18 identification No. 3  
1,5 mm<sup>2</sup> AWG 16 identification No. 4  
2,5 mm<sup>2</sup> AWG 14 identification No. 5

RDF2D 0.3  
RDF2D 0.5  
RDF2D 0.7  
RDF2D 1.0  
RDF2D 1.5  
RDF2D 2.5

10A male crimp contacts  
0,14-0,37 mm<sup>2</sup> AWG 26-22 identification No. 1  
0,5 mm<sup>2</sup> AWG 20 identification No. 2  
0,75 mm<sup>2</sup> AWG 18 identification No. ②  
1 mm<sup>2</sup> AWG 18 identification No. 3  
1,5 mm<sup>2</sup> AWG 16 identification No. 4  
2,5 mm<sup>2</sup> AWG 14 identification No. 5

RDM2D 0.3  
RDM2D 0.5  
RDM2D 0.7  
RDM2D 1.0  
RDM2D 1.5  
RDM2D 2.5

gold plated

MIXO - HNM

- characteristics according to EN 61984:  
**3 poles 40A 830V 8kV 3**  
**4 poles 10A 830V 8kV 3**
- cULus (UL for USA and Canada), certified
- rated voltage according to UL/CSA: 600V
- insulation resistance: ≥ 10 GΩ
- ambient temperature limit: -40 °C ... +125 °C
- made of self-extinguishing thermoplastic resin UL 94V-0
- mechanical life: ≥ 10.000 cycles
- contact resistance: ≤ 0,3 mΩ (3 poles), ≤ 3 mΩ (4 poles)
- for max. current load see the connector inserts derating diagram below; for more information see page 28

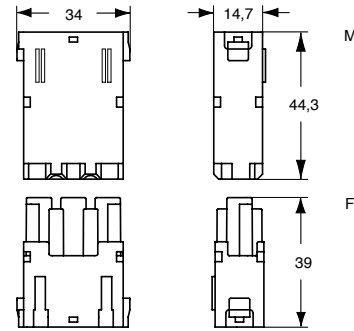

contacts side (front view)  
side with reference arrow ▲

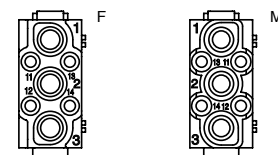

- 1 frame slot

- it is recommended to crimp the contacts with crimping tools homologated by ILME (please see the crimping tool section 40A contacts, RXF2D, RXM2D series and 10A contacts RDF2D, RDM2D series) on pages 708 - 741

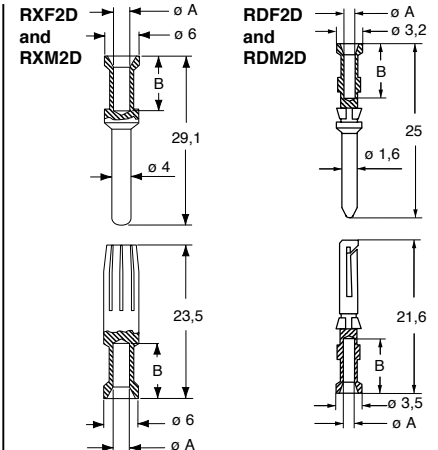

RXF2D and RXM2D contacts		
conductor section (mm <sup>2</sup> )	conductor slot ø A (mm)	conductors stripping length B (mm)
1,5	1,8	9
2,5	2,2	9
4	2,85	9,6
6	3,5	9,6
RDF2D and RDM2D contacts		
0,14-0,37	0,9	8
0,5	1,1	8
0,75	1,3	8
1,0	1,45	8
1,5	1,8	8
2,5	2,2	6

CX 3/4 poles connector inserts  
Maximum current load derating diagram

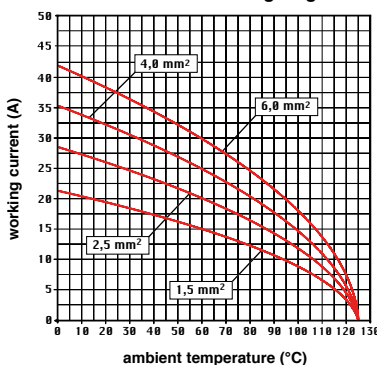



The modular inserts must be installed in suitable frames, which are then mounted in traditional enclosures\* or in COB panel supports.

frames for modular units\*

page: 333

\* enclosures: bulkhead mounting housings, high construction housings or high construction hoods

modular units, crimp connections with red lock-in tab (included)

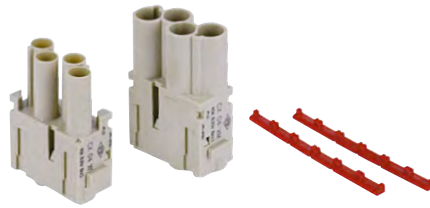

Q 10.000 MATINGS WITH HNM FRAMES AND HNM ENCLOSURES

Q 5.000 MATINGS WITH HNM FRAMES AND STANDARD ENCLOSURES, SINGLE LEVER

40A crimp contacts gold plated



description

part No.

part No

without contacts (to be ordered separately)  
(module red lock-in tab included)  
female inserts for female contacts  
male inserts for male contacts

CX 04 XF  
CX 04 XM

40A female crimp contacts  
1,5 mm<sup>2</sup> AWG 16  
2,5 mm<sup>2</sup> AWG 14  
4 mm<sup>2</sup> AWG 12  
6 mm<sup>2</sup> AWG 10

RXF2D 1.5  
RXF2D 2.5  
RXF2D 4.0  
RXF2D 6.0

gold plated

40A male crimp contacts  
1,5 mm<sup>2</sup> AWG 16  
2,5 mm<sup>2</sup> AWG 14  
4 mm<sup>2</sup> AWG 12  
6 mm<sup>2</sup> AWG 10

RXM2D 1.5  
RXM2D 2.5  
RXM2D 4.0  
RXM2D 6.0

- characteristics according to EN 61984:

**40A 830V 8kV 3**  
**40A 1000V 8kV 2**

- cULus (UL for USA and Canada),

certified

- rated voltage according to UL/CSA: 600V

- insulation resistance:  $\geq 10$  G $\Omega$

- ambient temperature limit: -40 °C ... +125 °C

- made of self-extinguishing thermoplastic resin UL 94V-0

- mechanical life:  $\geq 10.000$  cycles

- contact resistance:  $\leq 0,3$  m $\Omega$

- for spare lock-in tab **CX CFMX** see SPARE SPARTS catalogue

- it is recommended to crimp the contacts with crimping tools homologated by ILME (please see the crimping tool section 40A contacts, RXF2D and RXM2D series) on pages 708 - 741

- for max. current load see the connector inserts derating diagram below; for more information see page 28

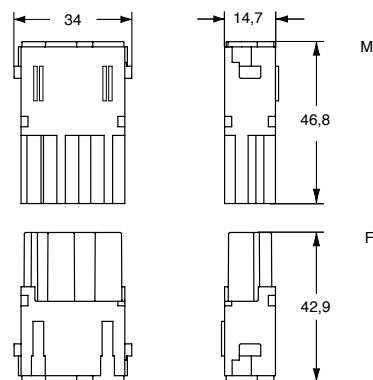

contacts side (front view)  
side with reference arrow ▲

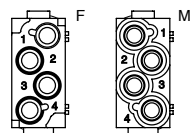

- 1 frame slot

Female inserts are supplied with two red lock tab that must be used instead of those supplied with the frames.

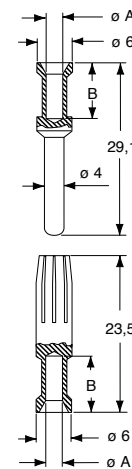
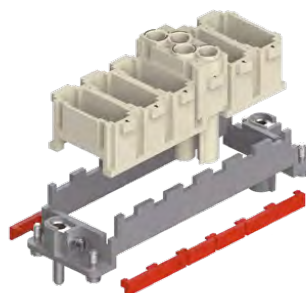

**RXF2D and RXM2D contacts**

conductor section (mm <sup>2</sup> )	conductor slot ø A (mm)	conductor stripping length B (mm)
1,5	1,8	9
2,5	2,2	9
4	2,85	9,6
6	3,5	9,6

- male and female contacts finger proof  
- their key characteristic lies in the fact that they guarantee maximum safety even in case of accidental contact with fingers (IP2X or IPXXB). Safety is guaranteed as standard on female contacts, but also on male contacts. This feature is important as it ensures full compliance with the recent safety standard EN 60204-1, concerning electric equipment fitted on machines and in particular with the requirements of Article 6.2.4 concerning protection against residual voltage. In the case of plugs or similar devices, the withdrawal of which results in the exposure of conductors (for example pins), the discharge time shall not exceed 1 s, otherwise such conductors shall be protected against direct contact to at least an IP2X or IPXXB.

**CX 04 poles connector inserts**  
**Maximum current load derating diagram**

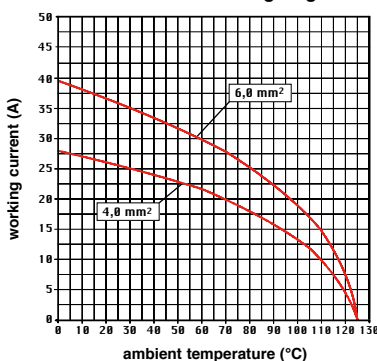



The modular inserts must be installed in suitable frames, which are then mounted in traditional enclosures or in COB panel supports.

frames for modular units

page: 333

- we recommend the use of CRF / CRM code pins

modular units, crimp connections



**✂ RATING 830V**

**Q 10.000 MATINGS WITH HNM FRAMES AND HNM ENCLOSURES**

**Q 5.000 MATINGS WITH HNM FRAMES AND STANDARD ENCLOSURES, SINGLE LEVER**

16A crimp contacts gold plated



description	part No.	part No.
-------------	----------	----------

without contacts (to be ordered separately)  
female inserts for female contacts  
male inserts for male contacts

**CX 06P CF**  
**CX 06P CM**

16A female contacts

0,14-0,37 mm <sup>2</sup>	AWG 26-22	one groove
0,5 mm <sup>2</sup>	AWG 20	with no grooves
0,75 mm <sup>2</sup>	AWG 18	one groove (back side)
1 mm <sup>2</sup>	AWG 18	one groove
1,5 mm <sup>2</sup>	AWG 16	two grooves
2,5 mm <sup>2</sup>	AWG 14	three grooves
3 mm <sup>2</sup>	AWG 12	one wide groove
4 mm <sup>2</sup>	AWG 12	with no grooves

RCF2D 0.3
RCF2D 0.5
RCF2D 0.7
RCF2D 1.0
RCF2D 1.5
RCF2D 2.5
RCF2D 3.0
RCF2D 4.0

gold plated

16A male contacts

0,14-0,37 mm <sup>2</sup>	AWG 26-22	one groove
0,5 mm <sup>2</sup>	AWG 20	with no grooves
0,75 mm <sup>2</sup>	AWG 18	one groove (back side)
1 mm <sup>2</sup>	AWG 18	one groove
1,5 mm <sup>2</sup>	AWG 16	two grooves
2,5 mm <sup>2</sup>	AWG 14	three grooves
3 mm <sup>2</sup>	AWG 12	one wide groove
4 mm <sup>2</sup>	AWG 12	with no grooves

RCM2D 0.3
RCM2D 0.5
RCM2D 0.7
RCM2D 1.0
RCM2D 1.5
RCM2D 2.5
RCM2D 3.0
RCM2D 4.0

MIXO - HNM

- characteristics according to EN 61984:

**16A 830V 8kV 3**

- certified
- rated voltage according to UL/CSA: 600V
- insulation resistance: ≥ 10 GΩ
- ambient temperature limit: -40 °C ... +125 °C
- made of self-extinguishing thermoplastic resin UL 94V-0
- mechanical life: ≥ 10.000 cycles
- contact resistance: ≤ 1 mΩ
- **it is recommended to crimp the contacts with crimping tools homologated by ILME** (please see the crimping tool section 16A contacts, RCF2D and RCM2D series) on pages 708 - 741
- for max. current load see the connector inserts derating diagram below; for more information see page 28

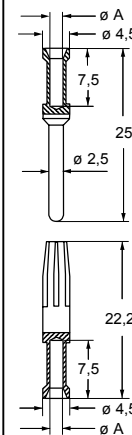
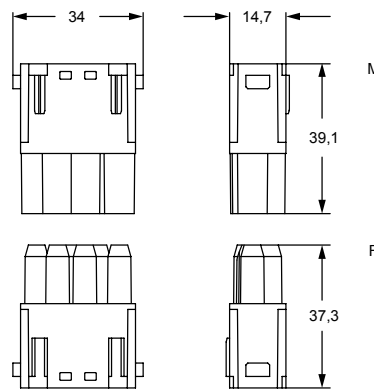

**CX 06 poles connector inserts**  
**Maximum current load derating diagram**

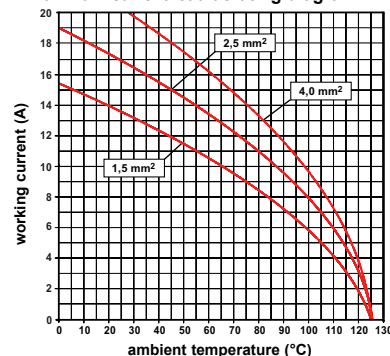

contacts side (front view)

side with reference arrow ▲

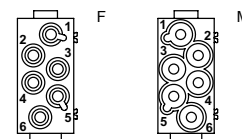

- 1 frame slot

**RCF2D and RCM2D contacts**

conductor section (mm <sup>2</sup> )	conductor slot ø A (mm)	conductors stripping length (mm)
0,14-0,37	0,9	7,5
0,5	1,1	7,5
0,75	1,3	7,5
1,0	1,45	7,5
1,5	1,8	7,5
2,5	2,2	7,5
3	2,55	7,5
4	2,85	7,5

The modular inserts must be installed in suitable frames, which are then mounted in traditional enclosures or in COB panel supports.

frames for modular units

page: 333

modular units, crimp connections

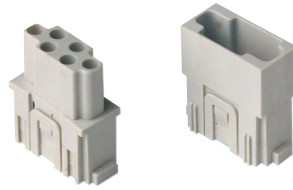

- Q 10.000 MATINGS WITH HNM FRAMES AND HNM ENCLOSURES
- Q 5.000 MATINGS WITH HNM FRAMES AND STANDARD ENCLOSURES, SINGLE LEVER

16A crimp contacts gold plated



description	part No.	part No
-------------	----------	---------

without contacts (to be ordered separately)  
female inserts for female contacts  
male inserts for male contacts

**CX 06 CF**  
**CX 06 CM**

16A female contacts

Area	AWG	Configuration
0,14-0,37 mm <sup>2</sup>	AWG 26-22	one groove
0,5 mm <sup>2</sup>	AWG 20	with no grooves
0,75 mm <sup>2</sup>	AWG 18	one groove (back side)
1 mm <sup>2</sup>	AWG 18	one groove
1,5 mm <sup>2</sup>	AWG 16	two grooves
2,5 mm <sup>2</sup>	AWG 14	three grooves
3 mm <sup>2</sup>	AWG 12	one wide groove
4 mm <sup>2</sup>	AWG 12	with no grooves

- gold plated
- RCF2D 0.3
  - RCF2D 0.5
  - RCF2D 0.7
  - RCF2D 1.0
  - RCF2D 1.5
  - RCF2D 2.5
  - RCF2D 3.0
  - RCF2D 4.0

16A male contacts

Area	AWG	Configuration
0,14-0,37 mm <sup>2</sup>	AWG 26-22	one groove
0,5 mm <sup>2</sup>	AWG 20	with no grooves
0,75 mm <sup>2</sup>	AWG 18	one groove (back side)
1 mm <sup>2</sup>	AWG 18	one groove
1,5 mm <sup>2</sup>	AWG 16	two grooves
2,5 mm <sup>2</sup>	AWG 14	three grooves
3 mm <sup>2</sup>	AWG 12	one wide groove
4 mm <sup>2</sup>	AWG 12	with no grooves

- RCM2D 0.3
- RCM2D 0.5
- RCM2D 0.7
- RCM2D 1.0
- RCM2D 1.5
- RCM2D 2.5
- RCM2D 3.0
- RCM2D 4.0

- characteristics according to EN 61984:  
**16A 500V 6kV 3**  
**16A 400/690V 6kV 2**
- certified
- rated voltage according to UL/CSA: 600V
- insulation resistance: ≥ 10 GΩ
- ambient temperature limit: -40 °C ... +125 °C
- made of self-extinguishing thermoplastic resin UL 94V-0
- mechanical life: ≥ 10.000 cycles
- contact resistance: ≤ 1 mΩ
- **it is recommended to crimp the contacts with crimping tools homologated by ILME** (please see the crimping tool section 16A contacts, RCF2D and RCM2D series) on pages 708 - 741
- for max. current load see the connector inserts derating diagram below; for more information see page 28

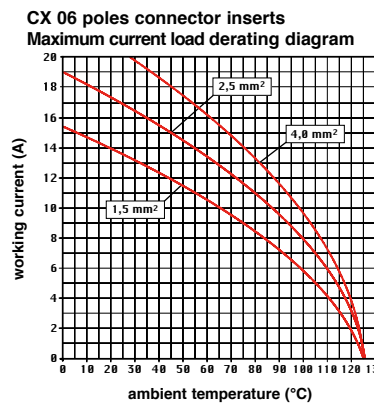
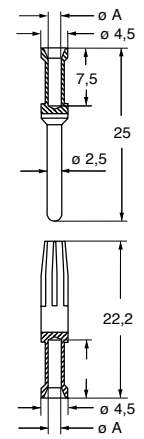
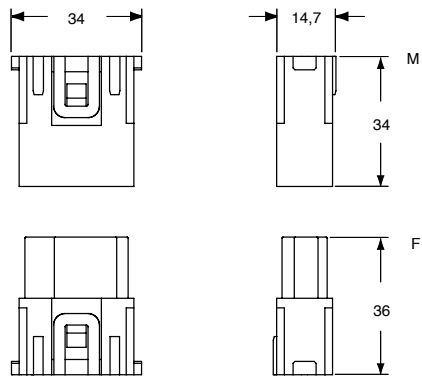

contacts side (front view)

side with reference arrow ▲

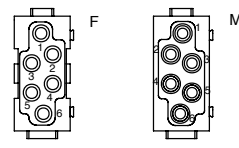

- 1 frame slot

**RCF2D and RCM2D contacts**

conductor section mm <sup>2</sup>	conductor slot ø A (mm)	conductors stripping length (mm)
0,14-0,37	0,9	7,5
0,5	1,1	7,5
0,75	1,3	7,5
1,0	1,45	7,5
1,5	1,8	7,5
2,5	2,2	7,5
3	2,55	7,5
4	2,85	7,5

The modular inserts must be installed in suitable frames, which are then mounted in traditional enclosures or in COB panel supports.

frames for modular units

page: 333

modular units, crimp connections

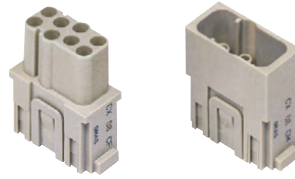

**Q 10.000 MATINGS WITH HNM FRAMES AND HNM ENCLOSURES**

**Q 5.000 MATINGS WITH HNM FRAMES AND STANDARD ENCLOSURES, SINGLE LEVER**

16A crimp contacts gold plated



description

part No.

part No

without contacts (to be ordered separately)  
female inserts for female contacts  
male inserts for male contacts

**CX 08 CF**  
**CX 08 CM**

16A female contacts

0,14-0,37 mm <sup>2</sup>	AWG 26-22	one groove
0,5 mm <sup>2</sup>	AWG 20	with no grooves
0,75 mm <sup>2</sup>	AWG 18	one groove (back side)
1 mm <sup>2</sup>	AWG 18	one groove
1,5 mm <sup>2</sup>	AWG 16	two grooves
2,5 mm <sup>2</sup>	AWG 14	three grooves
3 mm <sup>2</sup>	AWG 12	one wide groove
4 mm <sup>2</sup>	AWG 12	with no grooves

RCF2D 0.3
RCF2D 0.5
RCF2D 1.0
RCF2D 1.7
RCF2D 1.5
RCF2D 2.5
RCF2D 3.0
RCF2D 4.0

gold plated

16A male contacts

0,14-0,37 mm <sup>2</sup>	AWG 26-22	one groove
0,5 mm <sup>2</sup>	AWG 20	with no grooves
0,75 mm <sup>2</sup>	AWG 18	one groove (back side)
1 mm <sup>2</sup>	AWG 18	one groove
1,5 mm <sup>2</sup>	AWG 16	two grooves
2,5 mm <sup>2</sup>	AWG 14	three grooves
3 mm <sup>2</sup>	AWG 12	one wide groove
4 mm <sup>2</sup>	AWG 12	with no grooves

RCM2D 0.3
RCM2D 0.5
RCM2D 0.7
RCM2D 1.0
RCM2D 1.5
RCM2D 2.5
RCM2D 3.0
RCM2D 4.0

MIXO - HNM

- characteristics according to EN 61984:

**16A 500V 6kV 3**  
**16A 400/690V 6kV 2**

- certified

- rated voltage according to UL/CSA: 600V

- insulation resistance:  $\geq 10$  G $\Omega$

- ambient temperature limit: -40 °C ... +125 °C

- made of self-extinguishing thermoplastic resin  
UL 94V-0

- mechanical life:  $\geq 10.000$  cycles

- contact resistance:  $\leq 1$  m $\Omega$

- it is recommended to crimp the contacts with crimping tools homologated by ILME (please see the crimping tool section 16A contacts, RCF2D and RCM2D series) on pages 708 - 741

- for max. current load see the connector inserts derating diagram below; for more information see page 28

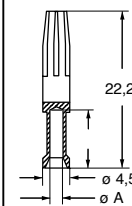
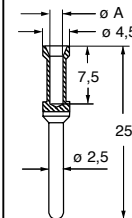
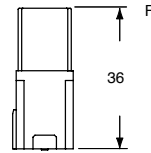
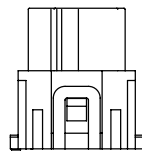
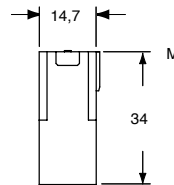
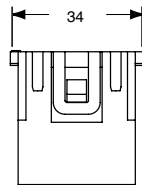

contacts side (front view)

side with reference arrow ▲

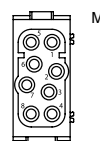
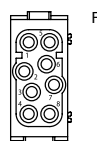

- 1 frame slot

**CX 08 poles connector inserts**  
**Maximum current load derating diagram**

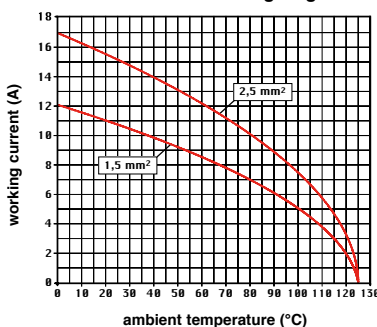

**RCF2D and RCM2D contacts**

conductor section mm <sup>2</sup>	conductor slot $\phi$ A (mm)	conductors stripping length (mm)
0,14-0,37	0,9	7,5
0,5	1,1	7,5
0,75	1,3	7,5
1,0	1,45	7,5
1,5	1,8	7,5
2,5	2,2	7,5
3	2,55	7,5
4	2,85	7,5

The modular inserts must be installed in suitable frames, which are then mounted in traditional enclosures or in COB panel supports.

frames for modular units

page: 333

modular units, crimp connections



- Q 10.000 MATINGS WITH HNM FRAMES AND HNM ENCLOSURES
- Q 5.000 MATINGS WITH HNM FRAMES AND STANDARD ENCLOSURES, SINGLE LEVER

16A crimp contacts gold plated



description	part No.	part No.
-------------	----------	----------

without contacts (to be ordered separately)  
 female inserts for female contacts <sup>1)</sup>  
 male inserts for male contacts <sup>1)</sup>

**CX 20 CF**  
**CX 20 CM**

16A female contacts

Area (mm <sup>2</sup> )	AWG	Configuration
0,14-0,37	26-22	one groove
0,5	20	with no grooves
0,75	18	one groove (back side)
1	18	one groove
1,5	16	two grooves
2,5	14	three grooves
3	12	one wide groove
4	12	with no grooves

- gold plated
- RCF2D 0.3
  - RCF2D 0.5
  - RCF2D 0.7
  - RCF2D 1.0
  - RCF2D 1.5
  - RCF2D 2.5
  - RCF2D 3.0
  - RCF2D 4.0

16A male contacts

Area (mm <sup>2</sup> )	AWG	Configuration
0,14-0,37	26-22	one groove
0,5	20	with no grooves
0,75	18	one groove (back side)
1	18	one groove
1,5	16	two grooves
2,5	14	three grooves
3	12	one wide groove
4	12	with no grooves

- RCM2D 0.3
- RCM2D 0.5
- RCM2D 0.7
- RCM2D 1.0
- RCM2D 1.5
- RCM2D 2.5
- RCM2D 3.0
- RCM2D 4.0

<sup>1)</sup> on request, version with 3 fastened CX 20 CF/CM inserts with poles numbered from 1 – 60  
 references: **CX 60 CF, CX 60 CM**

- characteristics according to EN 61984:  
**16A 500V 6kV 3**  
**16A 830V 8kV 2**
- cULus (UL for USA and Canada), certified
- rated voltage according to UL/CSA: 600V
- insulation resistance: ≥ 10 GΩ
- ambient temperature limit: -40 °C ... +125 °C
- made of self-extinguishing thermoplastic resin UL 94V-0
- mechanical life: ≥ 10.000 cycles
- contact resistance: ≤ 1 mΩ
- **it is recommended to crimp the contacts with crimping tools homologated by ILME** (please see the crimping tool section 16A contacts, RCF2D and RCM2D series) on pages 708 - 741
- for max. current load see the connector inserts derating diagram below; for more information see page 28

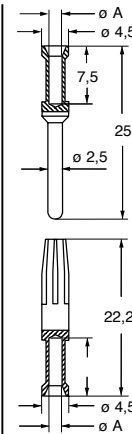
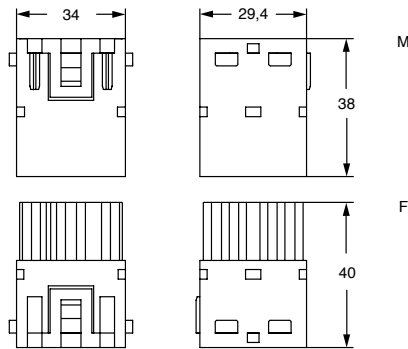

RCF2D and RCM2D contacts

conductor section mm <sup>2</sup>	conductor slot ø A (mm)	conductors stripping length (mm)
0,14-0,37	0,9	7,5
0,5	1,1	7,5
0,75	1,3	7,5
1,0	1,45	7,5
1,5	1,8	7,5
2,5	2,2	7,5
3	2,55	7,5
4	2,85	7,5

**CX20 poles connector inserts**  
**Maximum current load derating diagram**

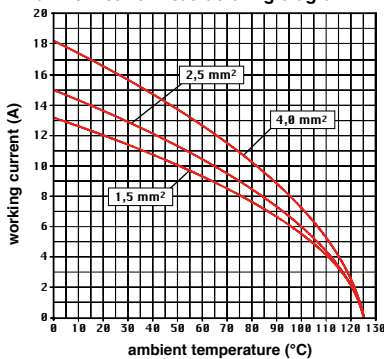

contacts side (front view)

side with reference arrow ▲

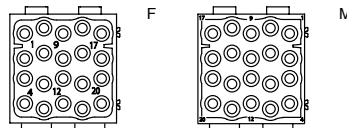

- 2 frame slots

The modular inserts must be installed in suitable frames, which are then mounted in traditional enclosures\* or in COB panel supports.

frames for modular units\*

page: 333

\* enclosures: bulkhead mounting housings, high construction housings or high construction hoods

modular units, crimp connections



**RATING 250V**

**Q 10.000 MATINGS WITH HNM FRAMES AND HNM ENCLOSURES**

**Q 5.000 MATINGS WITH HNM FRAMES AND STANDARD ENCLOSURES, SINGLE LEVER**

10A crimp contacts gold plated



description	part No.	part No
-------------	----------	---------

without contacts (to be ordered separately)  
female inserts for female contacts  
male inserts for male contacts

**CX 12 DF**  
**CX 12 DM**

10A female contacts

cross-section	AWG	identification No.
0,14-0,37 mm <sup>2</sup>	AWG 26-22	identification No. 1
0,5 mm <sup>2</sup>	AWG 20	identification No. 2
0,75 mm <sup>2</sup>	AWG 18	identification No. ②
1 mm <sup>2</sup>	AWG 18	identification No. 3
1,5 mm <sup>2</sup>	AWG 16	identification No. 4
2,5 mm <sup>2</sup>	AWG 14	identification No. 5

**RDF2D 0.3**  
**RDF2D 0.5**  
**RDF2D 0.7**  
**RDF2D 1.0**  
**RDF2D 1.5**  
**RDF2D 2.5**

**gold plated**

10A male contacts

cross-section	AWG	identification No.
0,14-0,37 mm <sup>2</sup>	AWG 26-22	identification No. 1
0,5 mm <sup>2</sup>	AWG 20	identification No. 2
0,75 mm <sup>2</sup>	AWG 18	identification No. ②
1 mm <sup>2</sup>	AWG 18	identification No. 3
1,5 mm <sup>2</sup>	AWG 16	identification No. 4
2,5 mm <sup>2</sup>	AWG 14	identification No. 5

**RDM2D 0.3**  
**RDM2D 0.5**  
**RDM2D 0.7**  
**RDM2D 1.0**  
**RDM2D 1.5**  
**RDM2D 2.5**

**MIXO - HNM**

- characteristics according to EN 61984:  
**10A 250V 4kV 3**
- certified
- rated voltage according to UL/CSA: 600V
- insulation resistance: ≥ 10 GΩ
- ambient temperature limit: -40 °C ... +125 °C
- made of self-extinguishing thermoplastic resin UL 94V-0
- mechanical life: ≥ 10.000 cycles
- contact resistance: ≤ 3 mΩ
- PCBs interface, refer to article CIF 2.4 on page 670
- **it is recommended to crimp the contacts with crimping tools homologated by ILME** (please see the crimping tool section 10A contacts, RDF2D and RDM2D series) on pages 708 - 741
- for max. current load see the connector inserts derating diagram below; for more information see page 28

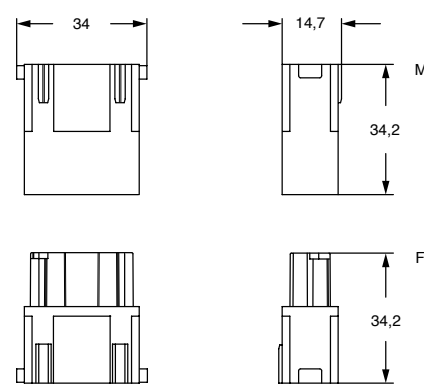

contacts side (front view)

side with reference arrow ▲

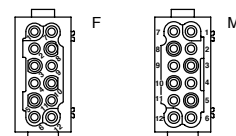

- 1 frame slot

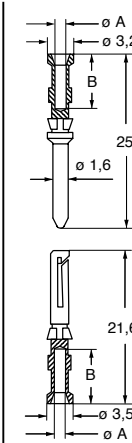

**RDF2D and RDM2D contacts**

conductor section mm <sup>2</sup>	conductor slot ø A (mm)	conductors stripping length B (mm)
0,14-0,37	0,9	8
0,5	1,1	8
0,75	1,3	8
1,0	1,45	8
1,5	1,8	8
2,5	2,2	6

**CX 12 poles connector inserts**  
**Maximum current load derating diagram**

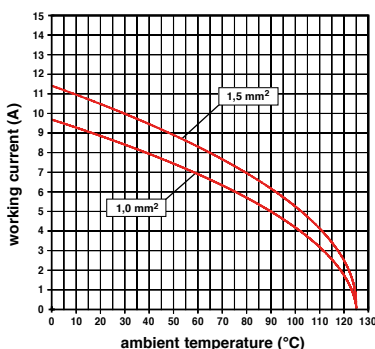



The modular inserts must be installed in suitable frames, which are then mounted in traditional enclosures or in COB panel supports.

frames for modular units

page: 333

modular units, crimp connections

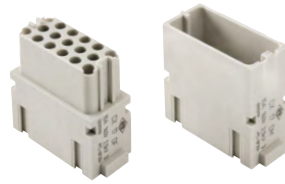

- Q 10.000 MATINGS WITH HNM FRAMES AND HNM ENCLOSURES
- Q 5.000 MATINGS WITH HNM FRAMES AND STANDARD ENCLOSURES, SINGLE LEVER

10A crimp contacts, gold plated



description	part No.	part No
-------------	----------	---------

without contacts (to be ordered separately)  
female inserts for female contacts  
male inserts for male contacts

**CX 17 DF**  
**CX 17 DM**

10A female contacts

0,14-0,37 mm <sup>2</sup>	AWG 26-22	identification No. 1
0,5 mm <sup>2</sup>	AWG 20	identification No. 2
0,75 mm <sup>2</sup>	AWG 18	identification No. ②
1 mm <sup>2</sup>	AWG 18	identification No. 3
1,5 mm <sup>2</sup>	AWG 16	identification No. 4
2,5 mm <sup>2</sup>	AWG 14	identification No. 5

- RDF2D 0.3
- RDF2D 0.5
- RDF2D 0.7
- RDF2D 1.0
- RDF2D 1.5
- RDF2D 2.5

gold plated

10A male contacts

0,14-0,37 mm <sup>2</sup>	AWG 26-22	identification No. 1
0,5 mm <sup>2</sup>	AWG 20	identification No. 2
0,75 mm <sup>2</sup>	AWG 18	identification No. ②
1 mm <sup>2</sup>	AWG 18	identification No. 3
1,5 mm <sup>2</sup>	AWG 16	identification No. 4
2,5 mm <sup>2</sup>	AWG 14	identification No. 5

- RDM2D 0.3
- RDM2D 0.5
- RDM2D 0.7
- RDM2D 1.0
- RDM2D 1.5
- RDM2D 2.5

- characteristics according to EN 61984:

**10A 160V 2,5kV 3**  
**10A 250V 4kV 2**

- (UL for USA and Canada), certified

- rated voltage according to UL/CSA: 250V

- insulation resistance:  $\geq 10 \text{ G}\Omega$

- ambient temperature limit: -40 °C ... +125 °C

- made of self-extinguishing thermoplastic resin  
UL 94V-0

- mechanical life:  $\geq 10.000$  cycles

- contact resistance:  $\leq 3 \text{ m}\Omega$

- **it is recommended to crimp the contacts with crimping tools homologated by ILME** (please see the crimping tool section 10A contacts, RDF2D and RDM2D series) on pages 708 - 741

- for max. current load see the connector inserts derating diagram below; for more information see page 28

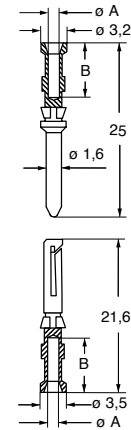
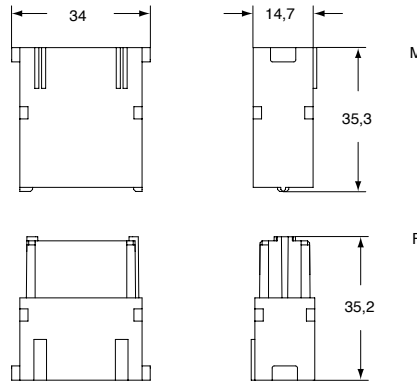

contacts side (front view)

side with reference arrow ▲

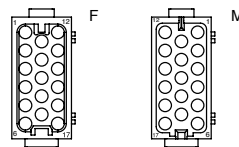

- 1 frame slot

**RDF2D and RDM2D contacts**

conductor section	conductor slot	conductors stripping length
mm <sup>2</sup>	$\phi A$ (mm)	B (mm)
0,14-0,37	0,9	8
0,5	1,1	8
0,75	1,3	8
1,0	1,45	8
1,5	1,8	8
2,5	2,2	6

**CX 17 poles connector inserts**  
**Maximum current load derating diagram**

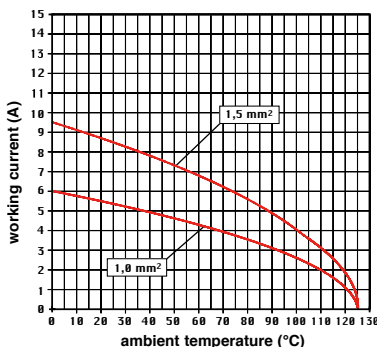

The modular inserts must be installed in suitable frames, which are then mounted in traditional enclosures\* or in COB panel supports.

frames for modular units\*

page: 333

\* enclosures: bulkhead mounting housings, high construction housings or high construction hoods

modular units, crimp connections

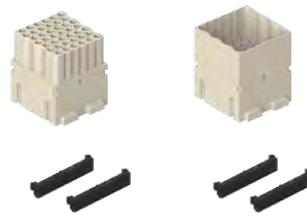

Q 10.000 MATINGS WITH HNM FRAMES AND HNM ENCLOSURES

Q 5.000 MATINGS WITH HNM FRAMES AND STANDARD ENCLOSURES, SINGLE LEVER

10A crimp contacts gold plated



description

part No.

part No.

without contacts (to be ordered separately), supplied with 2 dedicated black coloured 2-slot sized lock-in tab female inserts for female contacts  
male inserts for male contacts

CX 42 DF  
CX 42 DM

10A female contacts

0,14-0,37 mm <sup>2</sup>	AWG 26-22	identification No. 1
0,5 mm <sup>2</sup>	AWG 20	identification No. 2
0,75 mm <sup>2</sup>	AWG 18	identification No. ②
1 mm <sup>2</sup>	AWG 18	identification No. 3
1,5 mm <sup>2</sup>	AWG 16	identification No. 4
2,5 mm <sup>2</sup>	AWG 14	identification No. 5

RDF2D 0.3  
RDF2D 0.5  
RDF2D 0.7  
RDF2D 1.0  
RDF2D 1.5  
RDF2D 2.5

gold plated

10A male contacts

0,14-0,37 mm <sup>2</sup>	AWG 26-22	identification No. 1
0,5 mm <sup>2</sup>	AWG 20	identification No. 2
0,75 mm <sup>2</sup>	AWG 18	identification No. ②
1 mm <sup>2</sup>	AWG 18	identification No. 3
1,5 mm <sup>2</sup>	AWG 16	identification No. 4
2,5 mm <sup>2</sup>	AWG 14	identification No. 5

RDM2D 0.3  
RDM2D 0.5  
RDM2D 0.7  
RDM2D 1.0  
RDM2D 1.5  
RDM2D 2.5

MIXO - HNM

- characteristics according to EN 61984:

- 10A 150V 2,5kV 3**
- cURus, CSA, CQC, DNV-GL, BV, EAC pending
- rated voltage according to UL/CSA: 250V
- insulation resistance:  $\geq 10$  G $\Omega$
- ambient temperature limit: -40 °C ... +125 °C
- made of self-extinguishing thermoplastic resin UL 94V-0

- mechanical life:  $\geq 10.000$  cycles
- contact resistance:  $\leq 3$  m $\Omega$

- it is recommended to crimp the contacts with crimping tools homologated by ILME (please see the crimping tool section 10A contacts, RDF2D and RDM2D series) on pages 708 - 741

- supplied with dedicated black coloured 2-slot sized lock-in tab (2, one per each side).
- for spare lock-in tab CX CFMD see SPARE SPARTS catalogue

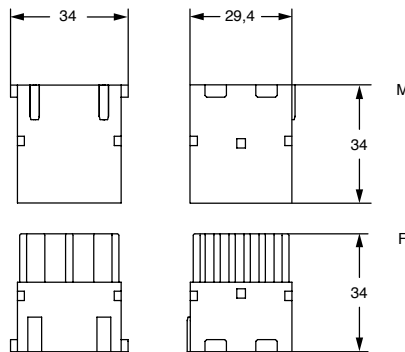

contacts side (front view)

rear view, side with reference arrow ▲

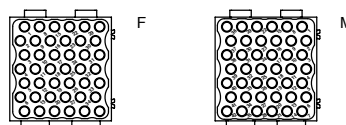

- 2 frame slots

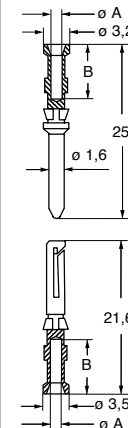

RDF2D and RDM2D contacts

conductor cross-sectional area mm <sup>2</sup>	conductor slot $\phi$ A (mm)	conductor stripping length B (mm)
0,14-0,37	0,9	8
0,5	1,1	8
0,75	1,3	8
1,0	1,45	8
1,5	1,8	8
2,5	2,2	6