

CSHF/M 06 S 6 poles + ⊕ 16A - 500V SQUICH®

enclosures: size "44.27"	page:
C-TYPE IP65/IP66	387 - 392
C7 IP67, single lever	436 - 437
V-TYPE IP65/IP66, single lever	444 - 447
BIG hoods	466 - 467
T-TYPE IP65 insulating	480 - 481
T-TYPE / W IP66/IP69 insulating	489
HYGIENIC T-TYPE / H IP66/IP69	501
HYGIENIC T-TYPE / C IP66/IP69, -50 °C	506
W-TYPE for aggressive environments	521
E-Xtreme® corrosion proof	530 - 531, 542, 550 - 551
EMC	578
Central lever	603 - 605
LS-TYPE	618 - 619
IP68	632 - 635
panel supports:	page:
COB	652 - 653

inserts,
spring terminal connections

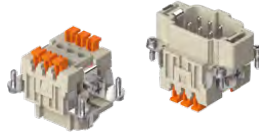

Q STAMPED CONTACTS, SILVER PLATED

description	part No.
spring terminals with actuator button	CSHF 06 S
female inserts with female contacts	CSHM 06 S
male inserts with male contacts	

- characteristics according to EN 61984:
16A 500V 6kV 3
16A 400/690V 6kV 2
- cULus (UL for USA and Canada) certified
CSA, CQC, DNV-GL, BV, EAC pending
- rated voltage according to UL/CSA: 600V
- insulation resistance: ≥ 10 GΩ
- ambient temperature limit: -40 °C ... +125 °C
- made of self-extinguishing thermoplastic resin
UL 94V-0
- mechanical life: ≥ 500 cycles
- contact resistance: ≤ 3 mΩ

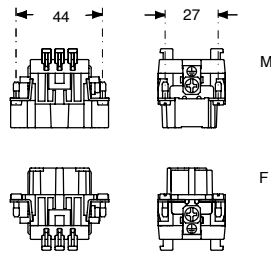

contacts side (front view)

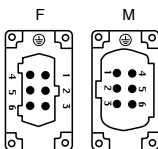

- inserts for connectors with the following conductor cross-sectional areas: 0,14 - 2,5 mm² - AWG 26 - 14
- conductors stripping length: 9...11 mm

CSH S 06 poles connector inserts
Maximum current load derating diagram

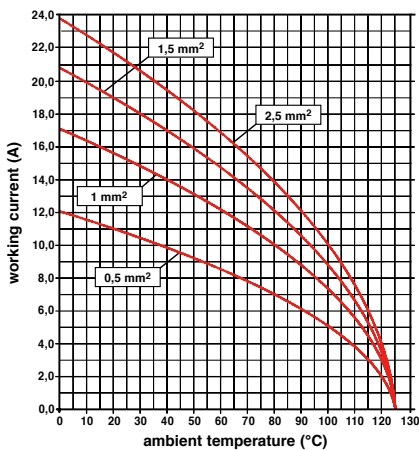

SQUICH®-spring connection technology

WIRING

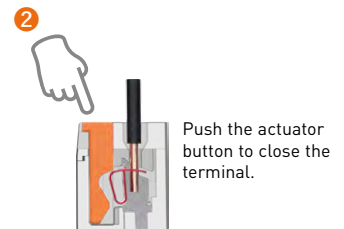
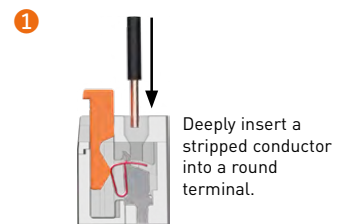

RE-OPENING

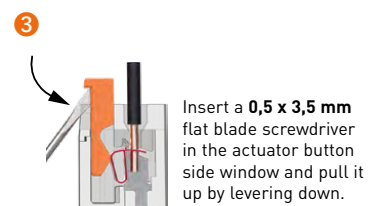

CSH S-SQUICH®

CSHF/M 10 S 10 poles + ⊕ 16A - 500V SQUICH®

enclosures: size "57.27"	page:
C-TYPE IP65/IP66	393 - 401
C7 IP67, two levers	438
V-TYPE IP65/IP66, single lever	448 - 453
BIG hoods	468 - 469
T-TYPE IP65 insulating	482 - 483
T-TYPE / W IP66/IP69 insulating	490
HYGIENIC T-TYPE / H IP66/IP69	502
HYGIENIC T-TYPE / C IP66/IP69, -50 °C	507
W-TYPE for aggressive environments	522
E-Xtreme® corrosion proof	532 - 533, 543, 552 - 553
EMC	579
Central lever	606 - 608
LS-TYPE	620 - 621
IP68	636 - 639
panel supports:	page:
COB	652 - 653

inserts,
spring terminal connections

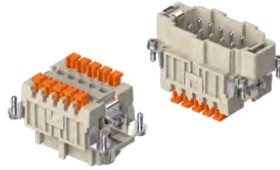

Q STAMPED CONTACTS, SILVER PLATED

description	part No.
-------------	----------

spring terminals with actuator button
female inserts with female contacts
male inserts with male contacts

CSHF 10 S
CSHM 10 S

- characteristics according to EN 61984:
16A 500V 6kV 3
16A 400/690V 6kV 2
- cULus (UL for USA and Canada) certified
CSA, CQC, DNV-GL, BV, EAC pending
- rated voltage according to UL/CSA: 600V
- insulation resistance: $\geq 10 \text{ G}\Omega$
- ambient temperature limit: $-40 \text{ }^\circ\text{C} \dots +125 \text{ }^\circ\text{C}$
- made of self-extinguishing thermoplastic resin
UL 94V-0
- mechanical life: ≥ 500 cycles
- contact resistance: $\leq 3 \text{ m}\Omega$

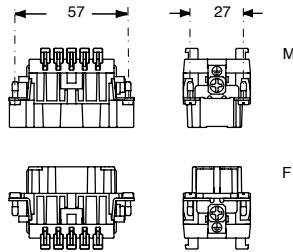

contacts side (front view)

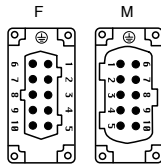

- inserts for connectors with the following conductor cross-sectional areas: 0,14 - 2,5 mm² - AWG 26 - 14
- conductors stripping length: 9...11 mm

CSH S 10 poles connector inserts
Maximum current load derating diagram

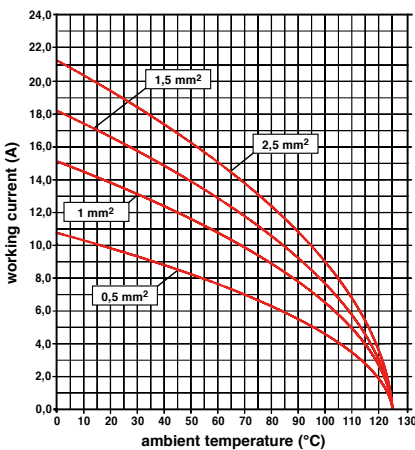

CSH S-SQUICH®

SQUICH®-spring connection technology

WIRING

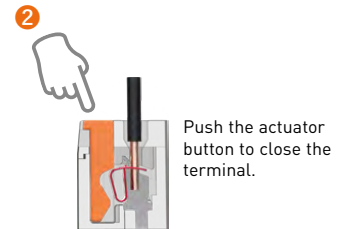
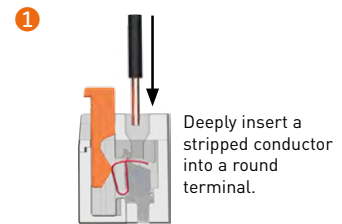

RE-OPENING

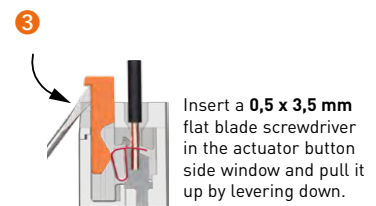

CSHF/M 16 S 16 poles + ⊕ 16A - 500V SQUICH®

enclosures: size "77.27"	page:
C-TYPE IP65/IP66	402 - 411
C7 IP67, two levers	439 - 440
V-TYPE IP65/IP66, single lever	454 - 458
BIG hoods	470 - 471
T-TYPE IP65 insulating	484 - 485
T-TYPE / W IP66/IP69 insulating	491
HYGIENIC T-TYPE / H IP66/IP69	503
HYGIENIC T-TYPE / C IP66/IP69, -50 °C	508
W-TYPE for aggressive environments	523
E-Xtreme® corrosion proof	534 - 535, 544, 554 - 555
EMC	580
Central lever	609 - 611
LS-TYPE	622 - 623
IP68	640 - 643
panel supports:	page:
COB	652 - 653

inserts,
spring terminal connections

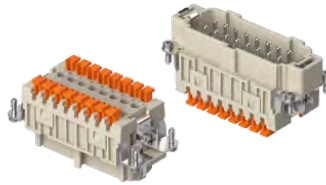

Q STAMPED CONTACTS, SILVER PLATED

description	part No.
spring terminals with actuator button	CSHF 16 S
female inserts with female contacts	CSHM 16 S
male inserts with male contacts	

- characteristics according to EN 61984:
16A 500V 6kV 3
16A 400/690V 6kV 2
- cULus (UL for USA and Canada) certified
CSA, CQC, DNV-GL, BV, EAC pending
- rated voltage according to UL/CSA: 600V
- insulation resistance: $\geq 10 \text{ G}\Omega$
- ambient temperature limit: $-40 \text{ }^\circ\text{C} \dots +125 \text{ }^\circ\text{C}$
- made of self-extinguishing thermoplastic resin
UL 94V-0
- mechanical life: ≥ 500 cycles
- contact resistance: $\leq 3 \text{ m}\Omega$

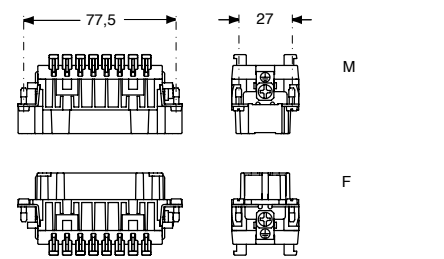

contacts side (front view)

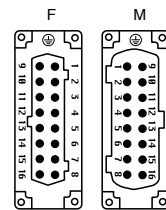

- inserts for connectors with the following conductor cross-sectional areas: 0,14 - 2,5 mm² - AWG 26 - 14
- conductors stripping length: 9...11 mm

CSH S 16 poles connector inserts
Maximum current load derating diagram

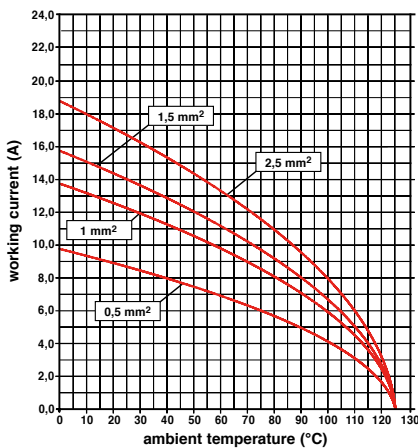

SQUICH®-spring connection technology

WIRING

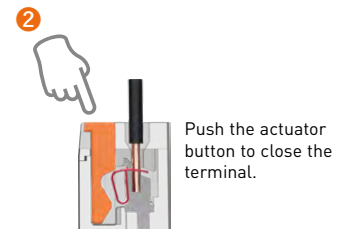
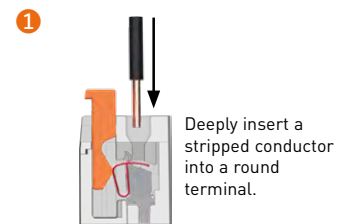

RE-OPENING

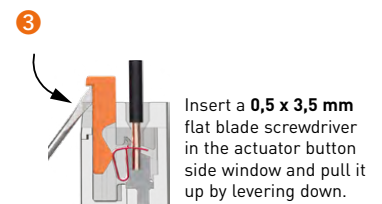

CSHF/M 24 S 24 poles + \oplus 16A - 500V SQUICH®

enclosures: size "104.27"	page:
C-TYPE IP65/IP66	412 - 423
C7 IP67, two levers	441 - 442
V-TYPE IP65/IP66, single lever	459 - 463
BIG hoods	472 - 473
T-TYPE IP65 insulating	486 - 487
T-TYPE / W IP66/IP69 insulating	492
HYGIENIC T-TYPE / H IP66/IP69	504
HYGIENIC T-TYPE / C IP66/IP69, -50 °C	509
W-TYPE for aggressive environments	524
E-Xtreme® corrosion proof	536 - 537, 545, 556 - 557
EMC	581
Central lever	612 - 614
LS-TYPE	624 - 625
IP68	644 - 647
panel supports: COB	page: 652 - 653

inserts,
spring terminal connections

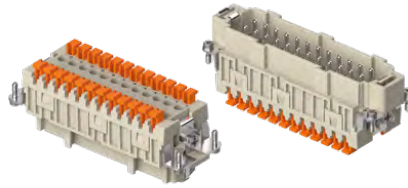

Q STAMPED CONTACTS, SILVER PLATED

description	part No.
-------------	----------

spring terminals with actuator button
female inserts with female contacts
male inserts with male contacts

CSHF 24 S
CSHM 24 S

- characteristics according to EN 61984:
16A 500V 6kV 3
16A 400/690V 6kV 2
- (UL for USA and Canada) certified
CSA, CQC, DNV-GL, BV, EAC pending
- rated voltage according to UL/CSA: 600V
- insulation resistance: $\geq 10 \text{ G}\Omega$
- ambient temperature limit: $-40 \text{ }^\circ\text{C} \dots +125 \text{ }^\circ\text{C}$
- made of self-extinguishing thermoplastic resin
UL 94V-0
- mechanical life: ≥ 500 cycles
- contact resistance: $\leq 3 \text{ m}\Omega$

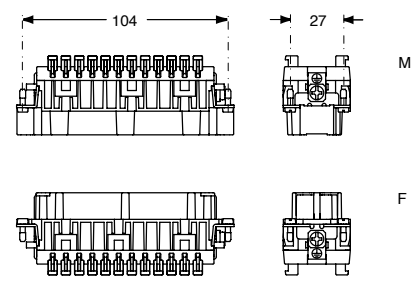

contacts side (front view)

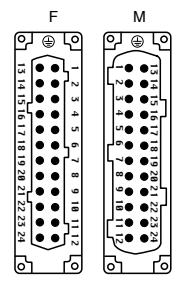

- inserts for connectors with the following conductor cross-sectional areas: $0,14 - 2,5 \text{ mm}^2$ - AWG 26 - 14
- conductors stripping length: $9 \dots 11 \text{ mm}$

CSH S 24 poles connector inserts
Maximum current load derating diagram

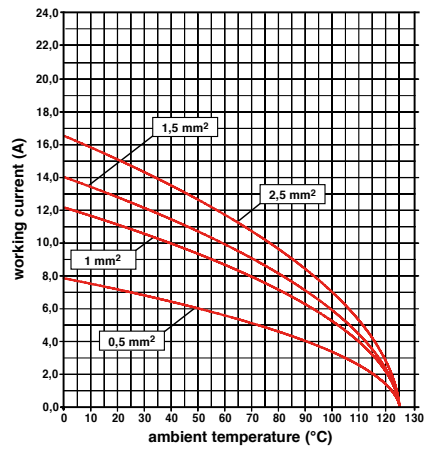

SQUICH®-spring connection technology

WIRING

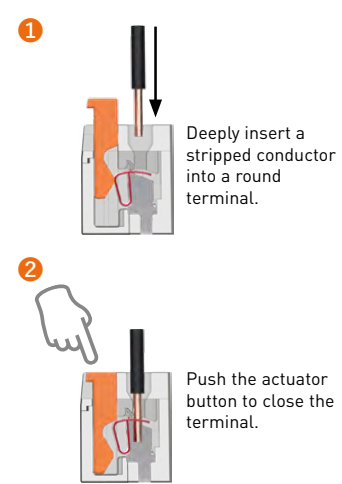

RE-OPENING

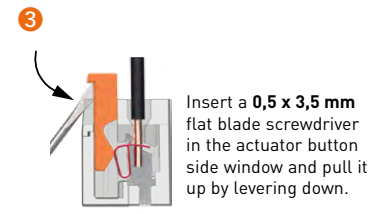

CSH S-SQUICH®

Inserts

CSHF/M SN 32 poles + ⊕ 16A - 500V SQUICH®

enclosures:
size "77.62"

page:

C-TYPE IP65/IP66
W-TYPE for aggressive environments
E-Xtreme® corrosion proof

424 - 429
525
546

inserts,
spring terminal connections

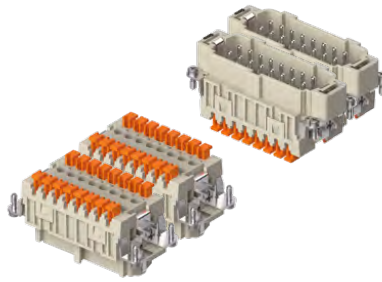

Q STAMPED CONTACTS, SILVER PLATED

CSH S-SQUICH®

description

part No.

part No.

spring terminals with actuator button
female inserts with female contacts, No. (1-16) & (17-32)
male inserts with male contacts, No. (1-16) & (17-32)

CSHF 16 S
CSHM 16 S

CSHF 16 SN
CSHM 16 SN

- characteristics according to EN 61984:
16A 500V 6kV 3
16A 400/690V 6kV 2
- cULus (UL for USA and Canada) certified
CSA, CQC, DNV-GL, BV, EAC pending
- rated voltage according to UL/CSA: 600V
- insulation resistance: ≥ 10 G Ω
- ambient temperature limit: -40 °C ... +125 °C
- made of self-extinguishing thermoplastic resin
UL 94V-0
- mechanical life: ≥ 500 cycles
- contact resistance: ≤ 3 m Ω

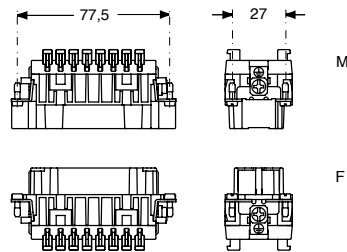

contacts side (front view)

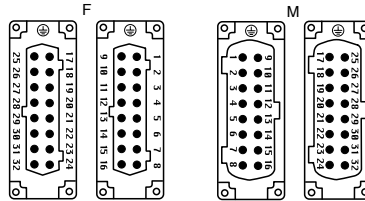

- inserts for connectors with the following conductor cross-sectional areas: 0,14 - 2,5 mm² - AWG 26 - 14
- conductors stripping length: 9...11 mm

CSH S 32 poles connector inserts
Maximum current load derating diagram

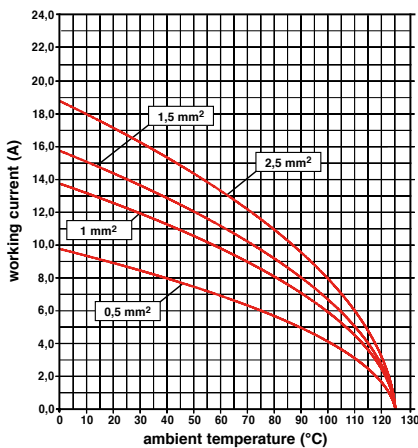

SQUICH®-spring connection technology

WIRING

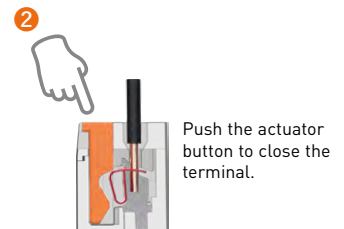
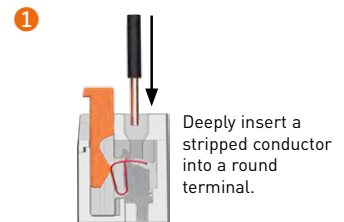

RE-OPENING

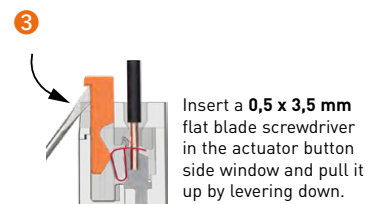

CSHF/M SN 48 poles + ⊕ 16A - 500V SQUICH®

enclosures:
size "104.62"

page:

C-TYPE IP65/IP66
W-TYPE for aggressive environments
E-Xtreme® corrosion proof

430
526
547

inserts,
spring terminal connections

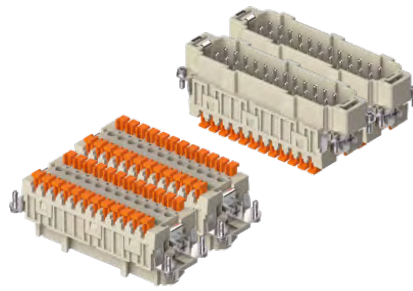

Q STAMPED CONTACTS, SILVER PLATED

description	part No.	part No.
-------------	----------	----------

spring terminals with actuator button
female inserts with female contacts, No. (1-24) & (25-48)
male inserts with male contacts, No. (1-24) & (25-48)

CSHF 24 S CSHM 24 S	CSHF 24 SN CSHM 24 SN
------------------------	--------------------------

- characteristics according to EN 61984:
16A 500V 6kV 3
16A 400/690V 6kV 2
- cULus (UL for USA and Canada) certified
CSA, CQC, DNV-GL, BV, EAC pending
- rated voltage according to UL/CSA: 600V
- insulation resistance: $\geq 10 \text{ G}\Omega$
- ambient temperature limit: $-40 \text{ }^\circ\text{C} \dots +125 \text{ }^\circ\text{C}$
- made of self-extinguishing thermoplastic resin
UL 94V-0
- mechanical life: ≥ 500 cycles
- contact resistance: $\leq 3 \text{ m}\Omega$

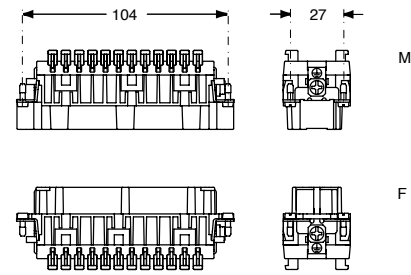

contacts side (front view)

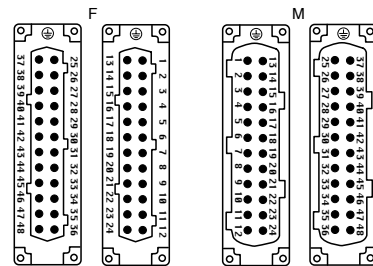

- inserts for connectors with the following conductor cross-sectional areas: 0,14 - 2,5 mm² - AWG 26 - 14
- conductors stripping length: 9...11 mm

CSH S 48 poles connector inserts
Maximum current load derating diagram

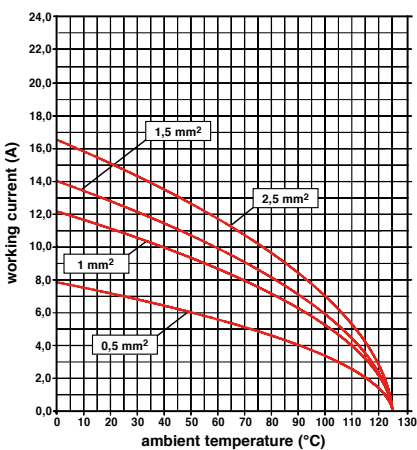

SQUICH®-spring connection technology

WIRING

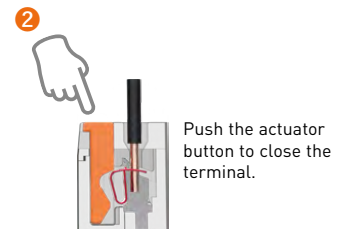
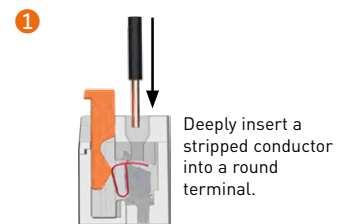

RE-OPENING

