

VG 08A Right Angle Plug

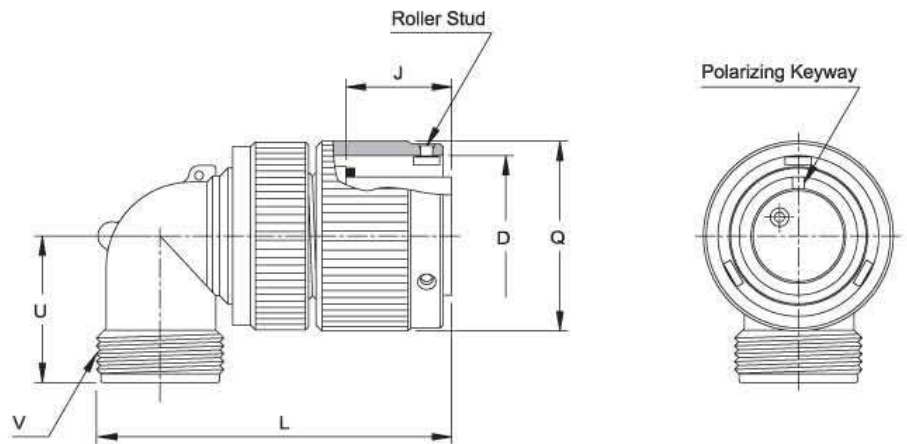

| Part No. | D dia. +0.2 -0.0 | J ±0.12 | L Ref. | Q dia. Ref. | U max. | V Thread Class 2A |
|---------------|------------------------|------------|-----------|----------------|-----------|----------------------|
| INB08A 10SL-* | 18.4 | 13.49 | 46.02 | 22.8 | 25.40 | 5/8-24 UNEF |
| INB08A 14S-* | 24.8 | 13.49 | 53.97 | 29.2 | 28.57 | 3/4-20 UNEF |
| INB08A 16S-* | 27.6 | 13.49 | 60.32 | 32.0 | 30.17 | 7/8-20 UNEF |
| INB08A 16-* | 27.6 | 18.26 | 65.07 | 32.0 | 30.17 | 7/8-20 UNEF |
| INB08A 18-* | 31.1 | 18.26 | 68.27 | 36.5 | 33.32 | 1-20 UNEF |
| INB08A 20-* | 34.5 | 18.26 | 76.98 | 39.9 | 34.92 | 1 3/16-18 UNEF |
| INB08A 22-* | 37.7 | 18.26 | 76.98 | 43.1 | 34.92 | 1 3/16-18 UNEF |
| INB08A 24-* | 41.2 | 18.26 | 86.51 | 46.5 | 39.67 | 1 7/16-18 UNEF |
| INB08A 28-* | 47.0 | 18.26 | 86.51 | 53.4 | 39.67 | 1 7/16-18 UNEF |
| INB08A 32-* | 53.7 | 18.26 | 95.25 | 60.1 | 47.62 | 1 3/4-18 UNS |
| INB08A 36-* | 59.90 | 18.26 | 100.2 | 66.3 | 52.37 | 2-18 UNS |