

MS3102A or E Box Mounting Receptacle

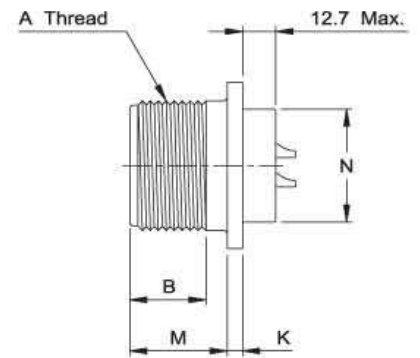
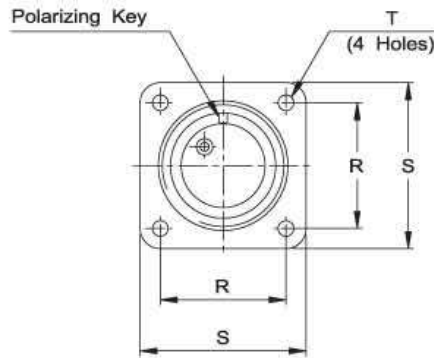

Part No.	A Thread Class 2A	B min.	K min./max.	M +0.79 -0.00	N dia. +0.00 -4.78	R ±0.12	S ±0.79	T dia +0.25 -0.12
I/MS3102A/E 10SL-*	5/8-24 UNEF	9.53	1.58 / 3.96	14.28	19.86	18.26	25.40	3.05
I/MS3102A/E 12S-*	3/4-20 UNEF	9.53	1.58 / 3.96	14.28	19.86	20.62	27.79	3.05
I/MS3102A/E 14S-*	7/8-20 UNEF	9.53	1.58 / 3.96	14.28	23.01	23.01	30.18	3.05
I/MS3102A/E 16S-*	1-20 UNEF	9.53	1.58 / 3.96	14.28	26.21	24.61	32.54	3.05
I/MS3102A/E 16-*	1-20 UNEF	15.88	1.58 / 3.96	19.05	26.21	24.61	32.54	3.05
I/MS3102A/E 18-*	1 1/8-18 UNEF	15.88	2.39 / 5.15	19.05	29.36	26.97	34.93	3.05
I/MS3102A/E 20-*	1 1/4-18 UNEF	15.88	2.39 / 5.15	19.05	32.56	29.36	38.10	3.05
I/MS3102A/E 22-*	1 3/8-18 UNEF	15.88	2.39 / 5.15	19.05	35.71	31.75	41.28	3.05
I/MS3102A/E 24-*	1 1/2-18 UNEF	15.88	2.39 / 5.15	20.63	38.91	34.93	44.45	3.73
I/MS3102A/E 28-*	1 3/4-18 UNS	15.88	2.39 / 5.15	20.63	45.26	39.67	50.80	3.73
I/MS3102A/E 32-*	2-18 UNS	15.88	3.18 / 9.11	22.23	51.61	44.45	57.15	4.39
I/MS3102A/E 36-*	2 1/4-16 UN	15.88	3.18 / 9.11	22.23	57.96	49.23	63.50	4.39