

PN...PI flush-mounting inclined socket-outlets - PN...PQ flush-mounting straight socket-outlets, for entertainment



- Enclosure and spring lid colour RAL 9005 black
- Compliant with EN 60309-1 and -2
- Enclosure, insert and spring lid in insulating, thermoplastic, self-extinguishing material
- Flange with anti-ageing gasket
- PN...PI - PN...PQ types (IP44), spring lid
- Terminals with retained screws
- IP44 degree of protection (EN 60529)

**16A flush-mounting inclined socket-outlets**  
**IP44 degree of protection**  
**low voltage:**  
**from over 50V up to 690V**



**NEW**

**16A flush-mounting straight socket-outlets**  
**IP44 degree of protection**  
**low voltage:**  
**from over 50V up to 690V**



**NEW**

Number of poles	Frequency Hz	Voltage V	Earthing contact position h	Part No.	Part No.
2P+⊕	50 and 60	200 - 250	6	PN 1663 PI	PN 1663 PQ
3P+⊕	50 and 60	380 - 415	6	PN 1664 PI	PN 1664 PQ
3P+N+⊕	50 and 60	200/346 - 240/415	6	PN 1665 PI	PN 1665 PQ

dimensions in mm

(16A) PN ... PI

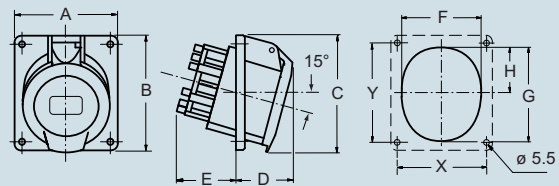

PN ... PI	A	B	C	D	E	F	G	H	X	Y
16A 2P+⊕	64	82	82	38	46	52	62	30	52	60
3P+⊕	64	82	82	42	47	57	65	28	52	60
3P+N+⊕	92	100	100	43	47	66	78	37.5	77	85

(16A) PN ... PQ

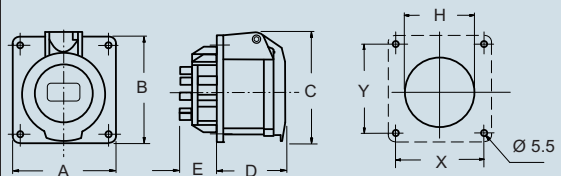

PN...PQ	A	B	C	D	E	H	X	Y
16A 2P+⊕	65	65	71	52	27	60	52	52
3P+⊕	65	65	75	53	27	61.5	52	52
3P+N+⊕	80	80	86	53	27	70	60	60

dimensions shown are not binding  
 and may be changed without notice