

PE...SI flush-mounting plugs, low voltage from over 50V up to 690V



- Compliant with EN 60309-1 and -2
- Enclosure, insert and locking ring in insulating, thermoplastic, self-extinguishing material
- Flange with anti-ageing gasket
- PE...SI types (IP44), RAL 7035 grey enclosure, plug mouth colour coded according to the operating voltage
- PEW...SI (IP67) types, RAL 7035 grey enclosure, locking ring with gasket colour coded according to the operating voltage
- Terminals with retained screws
- 63A, 125A: with pilot contact
- Nickel-plated contacts, available on request for 16A and 32A (standard on 63A and 125A). For the code of products with nickel-plated contacts (socket holes, plug pins), add "N" to the pre-code of the corresponding standard product code; for example: PE becomes PEN and PEW becomes PEWN.
- IP44 and IP67 degrees of protection (EN 60529)
- with Italian Quality Mark

Legend

A.V. = Colour according to voltage

(*) Green may be used together with the colour of the operating range for frequencies above 60 Hz and up to a maximum of 500 Hz.

16A
IP44 degree of protection



32A
IP44 degree of protection



Number of poles	Frequency Hz	Voltage V	Earthing contact position h	Part No.	Colour	Part No.	Colour
2P+⊕	50 and 60	100 - 130	4	PE 1643 SI		PE 3243 SI	
	50 and 60	200 - 250	6	PE 1663 SI		PE 3263 SI	
	50 and 60	380 - 415	9	PE 1693 SI		PE 3293 SI	
	50 and 60	480 - 500	7	PE 1673 SI		PE 3273 SI	
	50 and 60	ins. transformer	12	PE 16123 SI		PE 32123 SI	
	> 300 - 500	> 50	2	PE 1623 SI		PE 3223 SI	
	d.c.	> 50 - 250	3	PE 1633 SI		PE 3233 SI	
	d.c.	> 250	8	PE 1683 SI		PE 3283 SI	
3P+⊕	50 and 60	100 - 130	4	PE 1644 SI		PE 3244 SI	
	50 and 60	200 - 250	9	PE 1694 SI		PE 3294 SI	
	50 and 60	380 - 415	6	PE 1664 SI		PE 3264 SI	
	60	440 - 460	11	PE 16114 SI		PE 32114 SI	
	50 and 60	480 - 500	7	PE 1674 SI		PE 3274 SI	
	50 and 60	600 - 690	5	PE 1654 SI		PE 3254 SI	
	50	380	3	PE 1634 SI		PE 3234 SI	
	60	440	3	PE 1634 SI		PE 3234 SI	
	100 - 300	> 50	10	PE 16104 SI		PE 32104 SI	
	> 300 - 500	> 50	2	PE 1624 SI		PE 3224 SI	
3P+N+⊕	50 and 60	57/100 - 75/130	4	PE 1645 SI		PE 3245 SI	
	50 and 60	120/208 - 144/250	9	PE 1695 SI		PE 3295 SI	
	50 and 60	200/346 - 240/415	6	PE 1665 SI		PE 3265 SI	
	50 and 60	277/480 - 288/500	7	PE 1675 SI		PE 3275 SI	
	50 and 60	347/600 - 400/690	5	PE 1655 SI		PE 3255 SI	
	60	250/440 - 265/460	11	PE 16115 SI		PE 32115 SI	
	50	220/380	3	PE 1635 SI		PE 3235 SI	
	60	250/440	3	PE 1635 SI		PE 3235 SI	
	> 300 - 500	> 50	2	PE 1625 SI		PE 3225 SI	

A 52 x 60 mm

FM 2451 PIN

FM 3236 PIN

B 77 x 85 mm

A 52 x 60 mm with adapter FM 910 RI

FM 4272 PI

FM 3251 PI

FM 2451 PI

FM 3236 PI

dimensions in mm

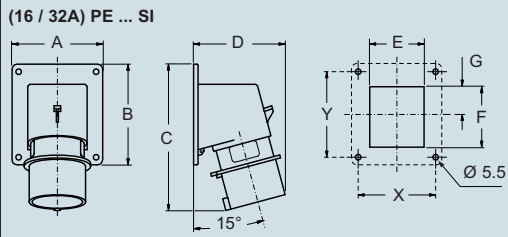

PE...SI	A	B	C	D	E	F	G	X	Y
16A 2P+⊕	65	82	126	81	41	43	21.5	52	60
3P+⊕	65	82	126	81	47	43	21.5	52	60
3P+N+⊕	90	100	146	93	54	60	27.5	77	85
32A 2P+⊕	90	100	160	101	55	60	27.5	77	85
3P+⊕	90	100	160	101	55	60	27.5	77	85
3P+N+⊕	90	100	160	106	62	60	27.5	77	85

dimensions shown are not binding and may be changed without notice

PEW...SI flush-mounting plugs, low voltage from over 50V up to 690V



16A
IP67 degree of protection



32A
IP67 degree of protection



63A
IP67 degree of protection



125A
IP67 degree of protection



Part No.	Colour	Part No.	Colour	Part No.	Colour	Part No.	Colour				
PEW 1643 SI ⊕	<div style="border: 1px solid red; border-radius: 50%; padding: 10px; display: inline-block;"> A 52 x 60 mm </div>	PEW 3243 SI ⊕	<div style="border: 1px solid red; border-radius: 50%; padding: 10px; display: inline-block;"> B 77 x 85 mm </div>	PEW 6343 SI ⊕	<div style="border: 1px solid red; border-radius: 50%; padding: 10px; display: inline-block;"> A 52 x 60 mm </div>	PEW 12543 SI ⊕	<div style="border: 1px solid red; border-radius: 50%; padding: 10px; display: inline-block;"> B 77 x 85 mm </div>				
PEW 1663 SI ⊕		PEW 3263 SI ⊕		PEW 6363 SI ⊕		PEW 12563 SI ⊕					
PEW 1693 SI ⊕		PEW 3293 SI ⊕		PEW 6393 SI ⊕		PEW 12593 SI ⊕					
PEW 1673 SI ⊕		PEW 3273 SI ⊕		PEW 6373 SI ⊕		PEW 12573 SI ⊕					
PEW 16123 SI ⊕		PEW 32123 SI ⊕		PEW 63123 SI ⊕		PEW 125123 SI ⊕					
PEW 1623 SI ⊕		PEW 3223 SI ⊕		PEW 6333 SI		PEW 12533 SI					
PEW 1633 SI ⊕		PEW 3233 SI		PEW 6383 SI		PEW 12583 SI					
PEW 1683 SI		PEW 3283 SI									
PEW 1644 SI ⊕		<div style="border: 1px solid red; border-radius: 50%; padding: 10px; display: inline-block;"> A 52 x 60 mm </div>		PEW 3244 SI ⊕		<div style="border: 1px solid red; border-radius: 50%; padding: 10px; display: inline-block;"> B 77 x 85 mm </div>		PEW 6344 SI ⊕	<div style="border: 1px solid red; border-radius: 50%; padding: 10px; display: inline-block;"> A 52 x 60 mm </div>	PEW 12544 SI ⊕	<div style="border: 1px solid red; border-radius: 50%; padding: 10px; display: inline-block;"> B 77 x 85 mm </div>
PEW 1694 SI ⊕				PEW 3294 SI ⊕				PEW 6394 SI ⊕		PEW 12594 SI ⊕	
PEW 1664 SI ⊕	PEW 3264 SI ⊕		PEW 6364 SI ⊕	PEW 12564 SI ⊕							
PEW 16114 SI ⊕	PEW 32114 SI ⊕		PEW 63114 SI ⊕	PEW 125114 SI ⊕							
PEW 1674 SI ⊕	PEW 3274 SI ⊕		PEW 6374 SI ⊕	PEW 12574 SI ⊕							
PEW 1654 SI	PEW 3254 SI		PEW 6354 SI	PEW 12554 SI							
PEW 1634 SI ⊕	PEW 3234 SI ⊕										
PEW 1634 SI ⊕	PEW 3234 SI ⊕										
PEW 16104 SI ⊕	PEW 32104 SI ⊕										
PEW 1624 SI ⊕	PEW 3224 SI ⊕										
PEW 1645 SI ⊕	<div style="border: 1px solid red; border-radius: 50%; padding: 10px; display: inline-block;"> B 77 x 85 mm </div>	PEW 3245 SI ⊕	<div style="border: 1px solid red; border-radius: 50%; padding: 10px; display: inline-block;"> B 77 x 85 mm </div>	PEW 6345 SI ⊕	<div style="border: 1px solid red; border-radius: 50%; padding: 10px; display: inline-block;"> B 77 x 85 mm </div>	PEW 12545 SI ⊕	<div style="border: 1px solid red; border-radius: 50%; padding: 10px; display: inline-block;"> B 77 x 85 mm </div>				
PEW 1695 SI ⊕		PEW 3295 SI ⊕		PEW 6395 SI ⊕		PEW 12595 SI ⊕					
PEW 1665 SI ⊕		PEW 3265 SI ⊕		PEW 6365 SI ⊕		PEW 12565 SI ⊕					
PEW 1675 SI ⊕		PEW 3275 SI ⊕		PEW 6375 SI ⊕		PEW 12575 SI ⊕					
PEW 1655 SI		PEW 3255 SI		PEW 6355 SI		PEW 12555 SI					
PEW 16115 SI ⊕		PEW 32115 SI ⊕		PEW 63115 SI ⊕		PEW 125115 SI ⊕					
PEW 1635 SI ⊕		PEW 3235 SI ⊕									
PEW 1635 SI ⊕		PEW 3235 SI ⊕									
PEW 1625 SI ⊕		PEW 3225 SI ⊕									

dimensions in mm

(16 / 32A) PEW ... SI

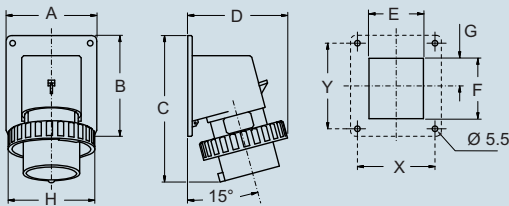

PEW...SI	A	B	C	D	E	F	G	H	X	Y
16A 2P+⊕	65	82	126	81	41	43	21.5	70	52	60
16A 3P+⊕	65	82	126	81	47	43	24.5	78	52	60
16A 3P+N+⊕	90	100	146	93	54	60	27.5	86	77	85
32A 2P+⊕	90	100	160	101	55	60	27.5	92	77	85
32A 3P+⊕	90	100	160	101	55	60	27.5	92	77	85
32A 3P+N+⊕	90	100	160	101	62	60	27.5	100	77	85

dimensions in mm

(63A) PEW ... SI

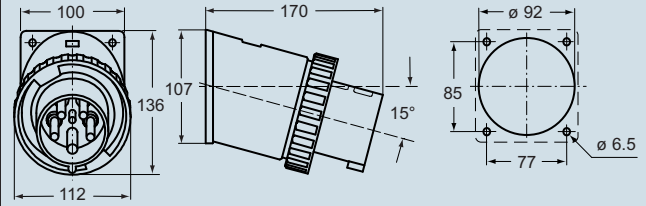

(125A) PEW ... SI

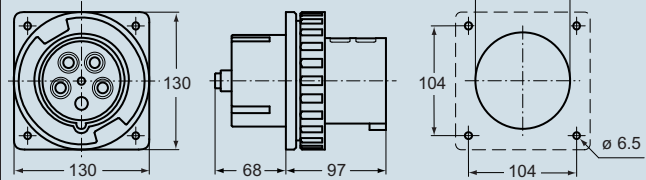

Accessories for IP67 plugs (optional)



Loose protective cover

Size	Polarity	Part No.
16A	2P+⊕	PEW 163 CS
16A	3P+⊕	PEW 164 CS
16A	3P+N+⊕	PEW 165 CS
32A	2/3P+⊕	PEW 324 CS
32A	3P+N+⊕	PEW 325 CS
63A	All	PEW 63 CS
125A	All	PEW 125 CS