

PE...PQ flush-mounting straight socket-outlets, low voltage from over 50V up to 690V



- Compliant with EN 60309-1 and -2
- Enclosure, insert and spring lid in insulating, thermoplastic, self-extinguishing material
- RAL 7035 grey enclosure, spring lid colour coded according to the operating voltage
- Flange with anti-ageing gasket
- PE...PQ types (IP44), spring lid
- PEW...PQ types (IP67), spring lid with locking ring and gasket
- Terminals with retained screws
- 63A, 125A: with pilot contact
- Nickel-plated contacts, available on request for 16A and 32A (standard on 63A and 125A). For the code of products with nickel-plated contacts (socket holes, plug pins), add "N" to the pre-code of the corresponding standard product code; for example: PE becomes PEN and PEW becomes PEWN.
- IP44 and IP67 degrees of protection (EN 60529)
- with Italian Quality Mark

Legend

A.V. = Colour according to voltage

(*) Green may be used together with the colour of the operating range for frequencies above 60 Hz and up to a maximum of 500 Hz.

16A
IP44 degree of protection



32A
IP44 degree of protection



Number of poles	Frequency Hz	Voltage V	Earthing contact position h	Part No.	Colour	Part No.	Colour
2P+⊕	50 and 60	100 - 130	4	PE 1643 PQ		PE 3243 PQ	
	50 and 60	200 - 250	6	PE 1663 PQ		PE 3263 PQ	
	50 and 60	380 - 415	9	PE 1693 PQ		PE 3293 PQ	
	50 and 60	480 - 500	7	PE 1673 PQ		PE 3273 PQ	
	50 and 60	ins. transformer	12	PE 16123 PQ		PE 32123 PQ	
	> 300 - 500	> 50	2	PE 1623 PQ		PE 3223 PQ	
	d.c.	> 50 - 250	3	PE 1633 PQ		PE 3233 PQ	
	d.c.	> 250	8	PE 1683 PQ		PE 3283 PQ	
3P+⊕	50 and 60	100 - 130	4	PE 1644 PQ		PE 3244 PQ	
	50 and 60	200 - 250	9	PE 1694 PQ		PE 3294 PQ	
	50 and 60	380 - 415	6	PE 1664 PQ		PE 3264 PQ	
	60	440 - 460	11	PE 16114 PQ		PE 32114 PQ	
	50 and 60	480 - 500	7	PE 1674 PQ		PE 3274 PQ	
	50 and 60	600 - 690	5	PE 1654 PQ		PE 3254 PQ	
	50	380	3	PE 1634 PQ		PE 3234 PQ	
	60	440	3	PE 1634 PQ		PE 3234 PQ	
	100 - 300	> 50	10	PE 16104 PQ		PE 32104 PQ	
	> 300 - 500	> 50	2	PE 1624 PQ		PE 3224 PQ	
3P+N+⊕	50 and 60	57/100 - 75/130	4	PE 1645 PQ		PE 3245 PQ	
	50 and 60	120/208 - 144/250	9	PE 1695 PQ		PE 3295 PQ	
	50 and 60	200/346 - 240/415	6	PE 1665 PQ		PE 3265 PQ	
	50 and 60	277/480 - 288/500	7	PE 1675 PQ		PE 3275 PQ	
	50 and 60	347/600 - 400/690	5	PE 1655 PQ		PE 3255 PQ	
	60	250/440 - 265/460	11	PE 16115 PQ		PE 32115 PQ	
	50	220/380	3	PE 1635 PQ		PE 3235 PQ	
	60	250/440	3	PE 1635 PQ		PE 3235 PQ	
	> 300 - 500	> 50	2	PE 1625 PQ		PE 3225 PQ	

D 60 x 60 mm

- Type **C** sockets can be supplied on request with dimensions 60 x 60 mm, the Part No. varies from PQ to PQF

D 60 x 60 mm

C 52 x 52 mm with adapter FM 88 RQ

- Type **C** sockets can be supplied on request with dimensions 60 x 60 mm, the Part No. varies from PQ to PQF

dimensions in mm

(16 / 32A) PE ... PQ

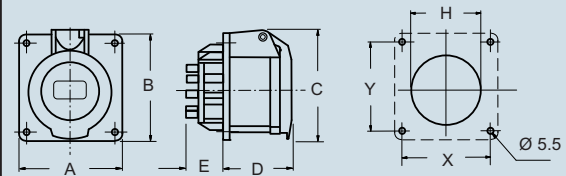

PE...PQ	A	B	C	D	E	H	X	Y
16A 2P+⊕	65	65	71	52	27	60	52	52
3P+⊕	65	65	75	53	27	61.5	52	52
3P+N+⊕	80	80	86	53	27	70	60	60
32A 2P+⊕	80	80	87	62	28	68	60	60
3P+⊕	80	80	87	62	28	68	60	60
3P+N+⊕	80	80	92	62	28	73	60	60

dimensions shown are not binding and may be changed without notice

PEW...PQ flush-mounting straight socket-outlets, low voltage from over 50V up to 690V



16A
IP67 degree of protection



32A
IP67 degree of protection



63A
IP67 degree of protection



125A
IP67 degree of protection



Part No.	Colour	Part No.	Colour	Part No.	Colour	Part No.	Colour
PEW 1643 PQ ⊕		PEW 3243 PQ ⊕		PEW 6343 PQ ⊕		PEW 12543 PQ ⊕	
PEW 1663 PQ ⊕		PEW 3263 PQ ⊕		PEW 6363 PQ ⊕		PEW 12563 PQ ⊕	
PEW 1693 PQ ⊕		PEW 3293 PQ ⊕		PEW 6393 PQ ⊕		PEW 12593 PQ ⊕	
PEW 1673 PQ ⊕		PEW 3273 PQ ⊕		PEW 6373 PQ ⊕		PEW 12573 PQ ⊕	
PEW 16123 PQ ⊕		PEW 32123 PQ ⊕		PEW 63123 PQ ⊕		PEW 125123 PQ ⊕	
PEW 1623 PQ ⊕		PEW 3223 PQ ⊕		PEW 6333 PQ		PEW 12533 PQ	
PEW 1633 PQ ⊕		PEW 3233 PQ		PEW 6383 PQ		PEW 12583 PQ	
PEW 1683 PQ							
PEW 1644 PQ ⊕		PEW 3244 PQ ⊕		PEW 6344 PQ ⊕		PEW 12544 PQ ⊕	
PEW 1694 PQ ⊕		PEW 3294 PQ ⊕		PEW 6394 PQ ⊕		PEW 12594 PQ ⊕	
PEW 1664 PQ ⊕		PEW 3264 PQ ⊕		PEW 6364 PQ ⊕		PEW 12564 PQ ⊕	
PEW 16114 PQ ⊕		PEW 32114 PQ ⊕		PEW 63114 PQ ⊕		PEW 125114 PQ ⊕	
PEW 1674 PQ ⊕		PEW 3274 PQ ⊕		PEW 6374 PQ ⊕		PEW 12574 PQ ⊕	
PEW 1654 PQ		PEW 3254 PQ		PEW 6354 PQ		PEW 12554 PQ	
PEW 1634 PQ ⊕		PEW 3234 PQ ⊕					
PEW 16104 PQ ⊕	PEW 32104 PQ ⊕						
PEW 1624 PQ ⊕	PEW 3224 PQ ⊕						
PEW 1645 PQ ⊕		PEW 3245 PQ ⊕		PEW 6345 PQ ⊕		PEW 12545 PQ ⊕	
PEW 1695 PQ ⊕		PEW 3295 PQ ⊕		PEW 6395 PQ ⊕		PEW 12595 PQ ⊕	
PEW 1665 PQ ⊕		PEW 3265 PQ ⊕		PEW 6365 PQ ⊕		PEW 12565 PQ ⊕	
PEW 1675 PQ ⊕		PEW 3275 PQ ⊕		PEW 6375 PQ ⊕		PEW 12575 PQ ⊕	
PEW 1655 PQ		PEW 3255 PQ		PEW 6355 PQ		PEW 12555 PQ	
PEW 16115 PQ ⊕		PEW 32115 PQ ⊕		PEW 63115 PQ ⊕		PEW 125115 PQ ⊕	
PEW 1635 PQ ⊕		PEW 3235 PQ ⊕					
PEW 1635 PQ ⊕	PEW 3235 PQ ⊕						
PEW 1625 PQ ⊕	PEW 3225 PQ ⊕						

dimensions in mm

(16 / 32A) PEW ... PQ

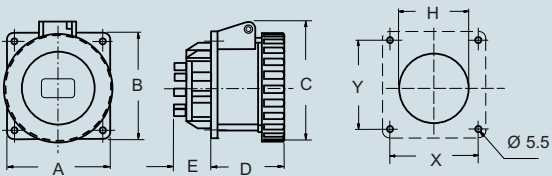

PEW...PQ	A	B	C	D	E	H	X	Y
16A 2P+⊕	65	65	77	52	27	60	52	52
3P+⊕	65	65	85	52	27	61.5	52	52
3P+N+⊕	80	80	93	52	27	70	60	60
32A 2P+⊕	80	80	98	62	28	68	60	60
3P+⊕	80	80	98	62	28	68	60	60
3P+N+⊕	80	80	105	62	28	73	60	60

dimensions in mm

(63 / 125A) PEW ... PQ

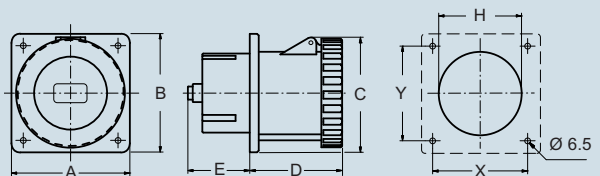

PEW ... PQ	A	B	C	D	E	H	X	Y
63A 2P+⊕	100	107	109	92	30	73	77	85
3P+⊕	100	107	109	92	30	73	77	85
3P+N+⊕	100	107	109	92	30	73	77	85
125A 2P+⊕	130	130	130	101	68	91	104	104
3P+⊕	130	130	130	101	68	91	104	104
3P+N+⊕	130	130	130	101	68	91	104	104